



3.2.A.1

Product Flow for Labeling - Building P - Level 2

ROXANA MONTEMILONE
DIRECTORA TÉCNICA
SANOPI PASTEUR S.A.

CHRISTIAN DOMINGUEZ
APODERADO
SANOPI PASTEUR S.A.



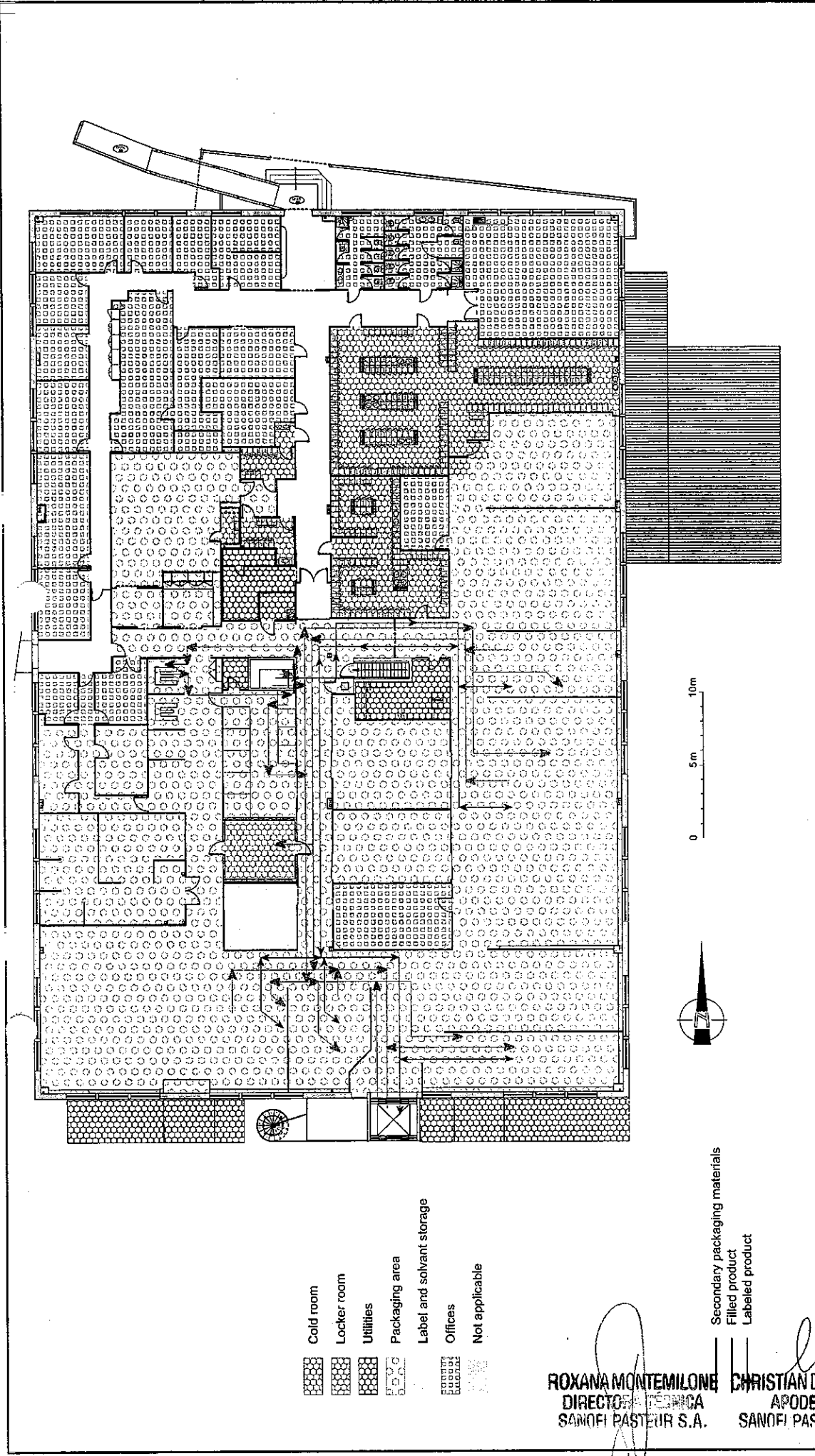

Building : **P** Sub-Building : **Floor : 2** Class : **Master TQC BPF**
 Discipline : **F Flux** Sub-Discipline : **.900 Flow-Control** Sheet Type : **.PL Plan view**

Sub-Dis.-Cat : **.PRO** Product : **Product flow for Drug Product labeling**
 Description : **Product flow for Drug Product labeling**

sanofi pasteur
 La division vaccins du Groupe sanofi-aventis

BUREAU D'ETUDES
 CAMPUS MERIEUX - 1541, Av. RENEH MERIEUX
 69007 MARCY L'ETOILE

Tel : 04 77 37 01 00
 Fax : 04 77 37 25 91

Layout Name : **04-PRO-A3** Scale : **1:1000** Paper Size : **A3**
 Drawing ID : **DRWFR 00010846**
 File Name : **P_F900_2_PL12**

Drawings are the copyright property of SANOFI PASTEUR
 Reproduction of drawings, in part or in whole is forbidden without written authorisation

Version	Date	Author	Appr. Date	Inact. Date
1.0	25 Mar 2010	Approved		
0.1	25 Mar 2010	Designer		

NAME	FUNCTION	DATE - HOUR	REASON
PELIT, Mathieu			

Roxana Montemilone
 DIRECTOR TECNICA
 SANOFI PASTEUR S.A.

Christian Dominguez
 APODERADO
 SANOFI PASTEUR S.

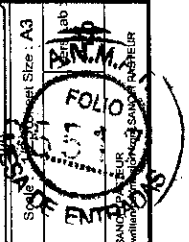



3.2.A.1

Product Flow for Packaging - Building P - Level 2

ROXANA MONTEMILONE
DIRECTORA TÉCNICA
RAMOS PASTERIS S.A

CHRISTIAN DOMINGUEZ
APODERADO
RAMOS PASTERIS S.A



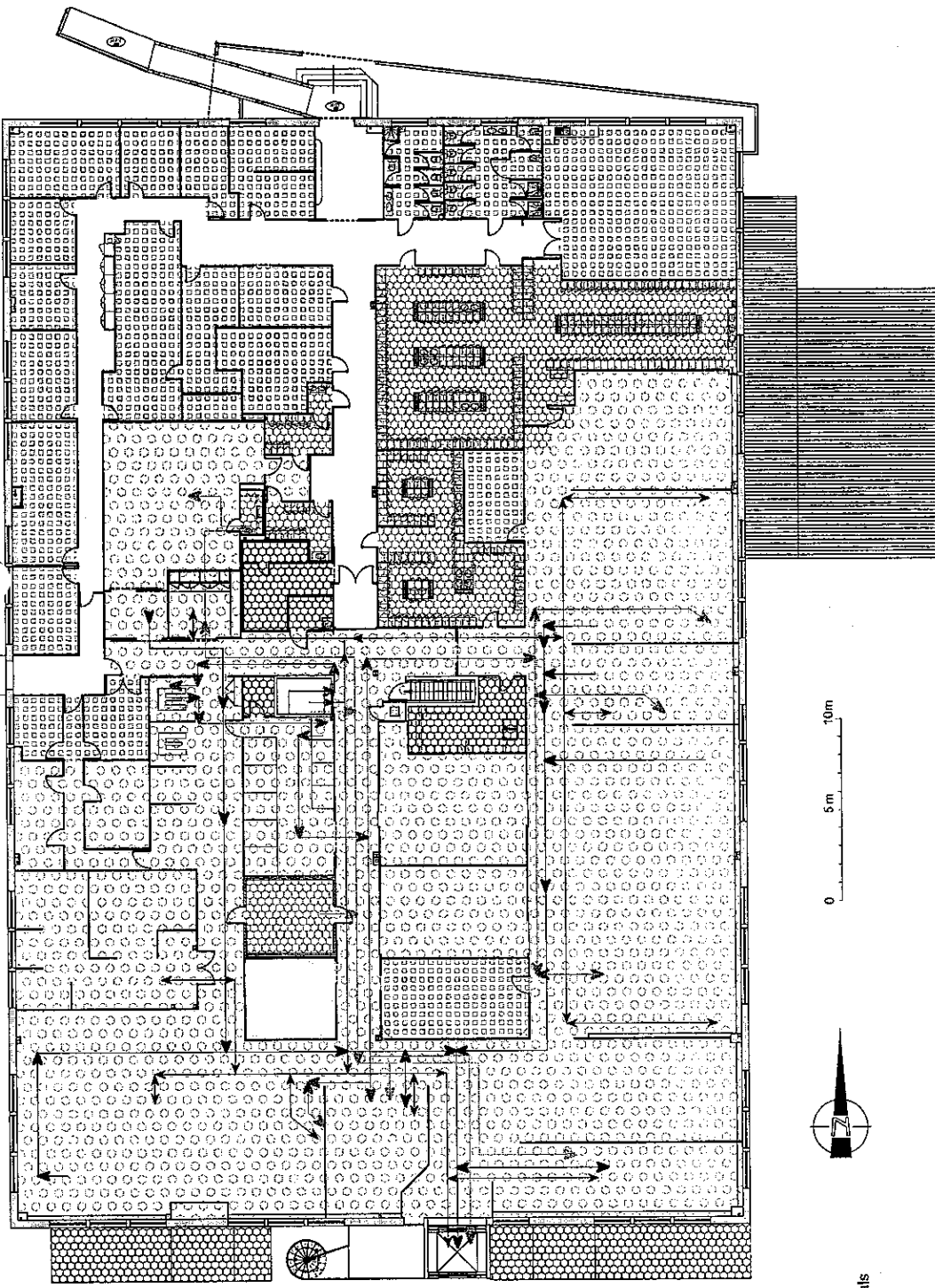

- Cold room
- Locker room
- Utilities
- Packaging area
- Label and solvent storage
- Offices
- Not applicable

- Secondary packaging materials
- Filled product
- Labeled product
- Finished product

ROXANA MONTEMILONE
 DIRECTORA TECNICA
 SANOFI PASTEUR S.A.

CHRISTIAN DOMINGUEZ
 APODERADO
 SANOFI PASTEUR S.A.

Modification:	0.0	25 Mar 2010	Approved	25 Mar 2010	25 Mar 2010
Vars. L Date	0.1	25 Mar 2010	Status	Appr Date	Inactiv Date
ROLE:	NAME:	FUNCTION:	DATE - HOUR:	REASON:	
	PEITZ Maximilien				

Building : **P** Flux
 Discipline : **F** Flux
 Sub-Discipline : **.PRO** Product
 Description : **Product flow for Drug Product**

Sub-Building :
 Sub-Discipline : **.900** Flow-Control
 Product : **Product flow for Drug Product**

Floor : **2** Class : **Master TQC BPF**
 Sheet Type : **.PL** Plan view

Layout Name : **03-PRO-A3**
 Drawing ID : **DRWFR_00010846**
 File Name : **P_F900_2_PL12**

sanofi pasteur
 La division vaccins du Groupe sanofi-aventis.

BUREAU D'ETUDES
 BUREAU D'ARCHITECTURE
 60000 MARCY L'ETOILE

Scale : 1/2000
 DWG : 04.03.2010.08
 Pk : 04.03.2010.04

Drawings are the copyright property of SANOFI PASTEUR
 Reproduction of drawings, in part or in whole is forbidden without written permission from SANOFI PASTEUR.



3.2.A.1

Personnel Flow - Building P - Level 1

ROXANA MONTEMILONE
DIRECTORA TÉCNICA
SANOFI PASTEUR S.A.

CHRISTIAN DOMINGUEZ
APODERADO
SANOFI PASTEUR S.A.







3.2.A.1

Personnel Flow - Building P - Level 2

	
ROXANA MONTEMILONE	CHRISTIAN DOMINGUEZ
DIRECTORA TÉCNICA	APODERADO
SANOPI PASTEUR S.A.	SANOPI PASTEUR S.A.





3.2.A.1

Waste Flow - Building P - Level 1

ROXANA MONTEMILONE
DIRECTORA TÉCNICA
SANOFI PASTEUR S.A.

CHRISTIAN DOMINGUEZ
APODERADO
SANOFI PASTEUR S.A.

()

()

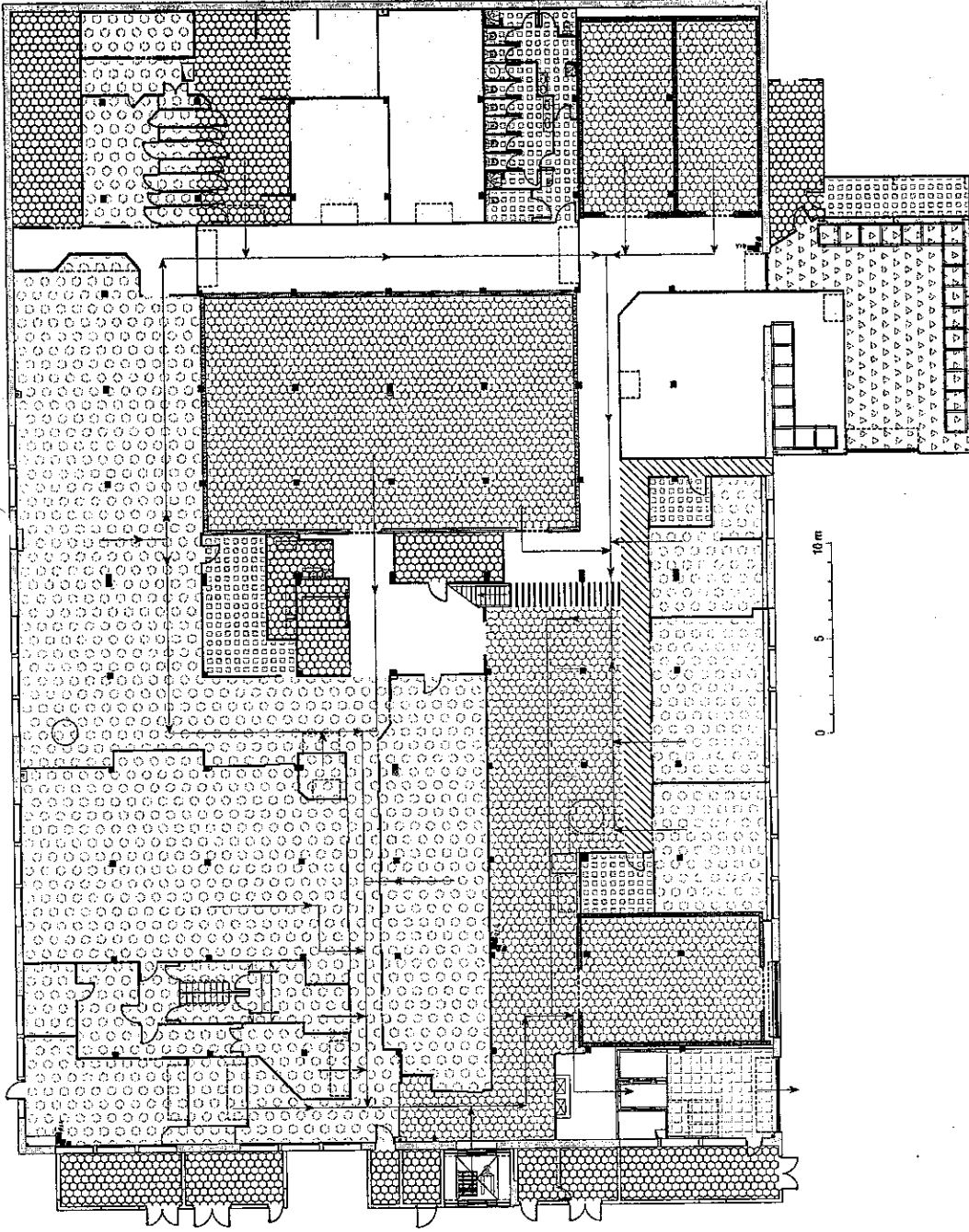
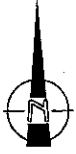

0 5 10 m

- Cold room
- Shipping area
- Utilities
- Packaging area
- Label and solvent storage
- Offices
- Delivery area
- Waste area

ROXANA MONTEHLONE
 DIRECTORA TÉCNICA
 SANOFI PASTEUR S.A.

CHRISTIAN D...
 APODERADO
 SANOFI PASTEUR S.A.

Building : **P** Sub-Building : **F Flux** Class : **Master TQC BPF** Floor : **1**
 Discipline : **F** Sub-Discipline : **.900 Flow-Control** Sheet Type : **PL Plan view**

Sub-Disc. Cat : **.DECH Waste**
 Description : **Waste flow for Drug Product**

sanofi pasteur
 La division vaccinas du Groupe sanofi-aventis.

Layout Name : **07-DECH-A3** Drawing ID : **DRWFR_00010850**
 File Name : **P_F900_1_PL12**

BUREAU DE L'URUS
 CAMPUS MERMUX 15ST. Av. Robert Schuman
 92000 NANTERRE
 TEL : 01 75 23 10 00
 FAX : 01 75 23 30 95
 SANOFI PASTEUR

Modification	Version	Date	Author	Design	Appr Date	Inactivity Date
2.3	03	17/03/03	CHRISTIAN D...	ROXANA MONTEHLONE		
0.1	17	17/03/03				

Vers. L1 Date : 17/03/03
 Status : **VALID**
 ROLE : **DR**

DATE - HOUR :
 REASON :

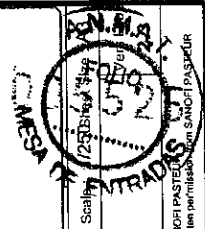

Drawings are the copyright property of SANOFI PASTEUR. Reproduction of drawings, in part or in whole is forbidden without written permission from SANOFI PASTEUR.





3.2.A.1

Waste Flow - Building P - Level 2



ROXANA MONTEMILONE
DIRECTORA TÉCNICA
SANOFI PASTEUR S.A.

CHRISTIAN DOMINGUEZ
APODERADO
SANOFI PASTEUR S.A.



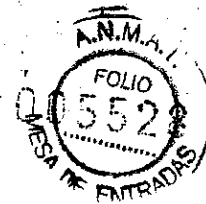

3

4



3.2.A.1

Department Allocation Plan - Building B33 - Level 0

	
ROXANA MONTEMLONE	CHRISTIAN DOMINGUEZ
DIRECTORA TÉCNICA	APODERADO
SANOPI PASTEUR S.A.	SANOPI PASTEUR S.A.



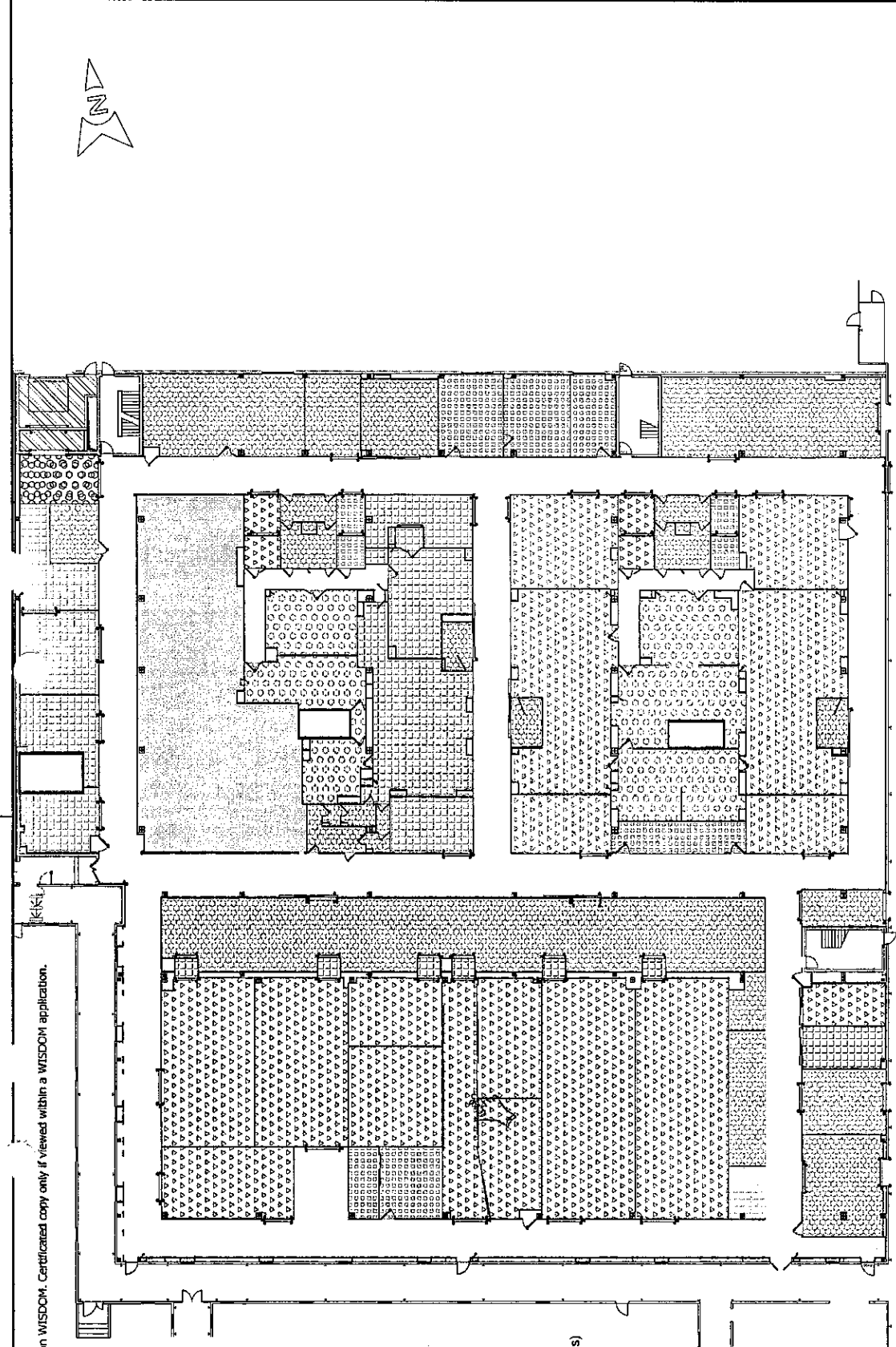

Copie certifiée si attachage depuis une application WISDOM. Certified copy only if viewed within a WISDOM application.

- Final bulk product reception area
- Filled Product airlocks
- Autoclave
- Incubation area +32,5°C
- Incubation area +22,5°C
- Final Bulk Product airlock
- Pallet wrapping
- Filled Product Final Sterilization area
- Cold room +5°C
- Offices
- Personnel airlocks
- Filling area (syringe)
- Filling area (vial)
- Waste airlocks
- Equipment and primary packaging
- (Components airlocks)
- Preparation and Sterilization area
- (Equipment , primary packaging components)
- Storage area (except product)
- Waste area
- Inspection area
- Not allocated area

ROXANA MONTEMILONE
 DIRECTOR TECHNICA
 SANOFI PASTEUR S.A.

0 10 Mètres

Building : **B33** Sub-Building : **REPARTITION** Floor : **0** class : **Master TQC BPF**

Discipline : **F Flux** Sub-Discipline : **900 Flux-Contrôle** Sheet Type : **PL Vue en Plan**

Sub-Dis-Cat : **DZ** Department Allocation

Description : **Production zone**

sanofi pasteur
 La division vaccins du Groupe sanofi-aventis.

Layout Name : **02-DZ-A3-Anglais** Scale : **1/400** Sheet Size : **A3**
 Drawing ID : **DRWFR 00014059**
 File Name : **B33_F900_0_PL04**

Drawing in the copyright present of SANOFI PASTEUR
 Reproduction of drawings, in part or in whole, without written permission from SANOFI PASTEUR

Modification	Approuvé	Appr Date	Inactiv Date
4.0	20 Sep 2010	21 Sep 2010	
0.1	25 Aug 2009		

DATE - HOUR	REASON
21 Sep 2010 07:27 FR	L'approbation de document
21 Sep 2010 09:37:43 FR	L'approbation de document
21 Sep 2010 15:24:39 FR	L'approbation de document

NAME	FUNCTION	Design
Isabelle JACQUET	Design verifier	Designer
ROLLE	NAME	FUNCTION
Approver	FOLLET-PHILIPPART Claire	RESPONSABLE SERVICE
Approver	BANDELLER David	ASSISTANT TECHNIQUE
Final Approver	CLEMENT Denis	ADJOINT TECHNIQUE

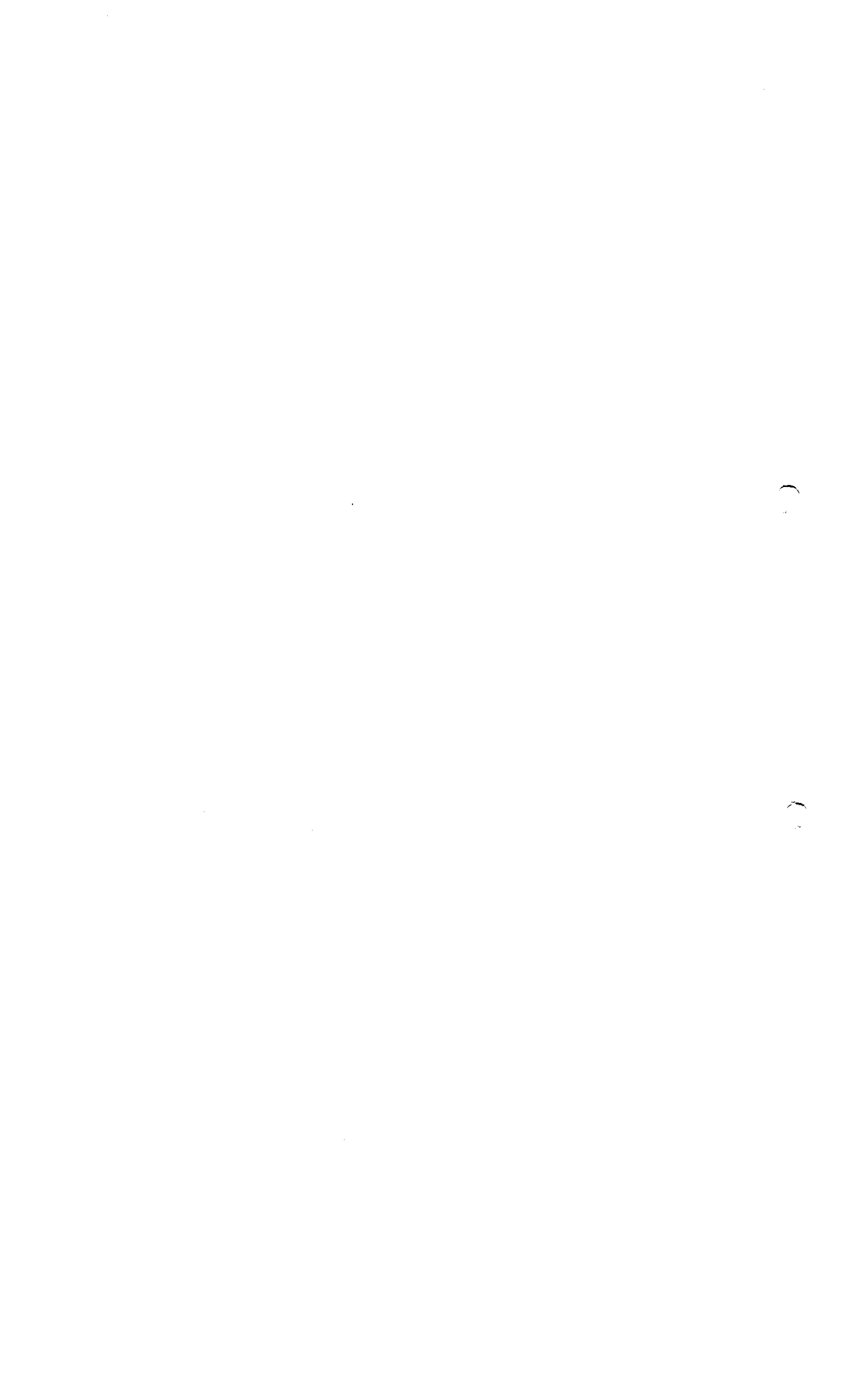



3.2.A.1

Product Flow - Building B33 - Level 0

ROXANA MONTEMILONE
DIRECTORA TÉCNICA
SANPASTEUR S.A.

CHRISTIAN DOMINGUEZ
APODERADO
SANPASTEUR S.A.





Copie certifiée, si arrachée depuis une application WISDOM. Certificated copy only if viewed within a WISDOM application.

- Final bulk product reception area
- Filled Product airlocks
- Autoclave
- Incubation area +32,5°C
- Incubation area +22,5°C
- Final Bulk Product airlock
- Pallet wrapping
- Filled Product, Final Sterilization area
- Cold room +5°C
- Offices
- Personnel airlocks
- Filling area (syringe)
- Filling area (Vial)
- Waste airlocks
- Equipment and primary packaging (Components airlocks)
- Preparation and Sterilization area (Equipment, primary packaging components)
- Storage area (except product)
- Waste area
- Inspection area
- Not allocated area

Mètres

ROXANA MONTEMILO
DIRECTORA TÉCNICA
SANOFI PASTEUR S.A.

CHRISTIAN LEROY
APODESTADO
SANOFI PASTEUR S.A.

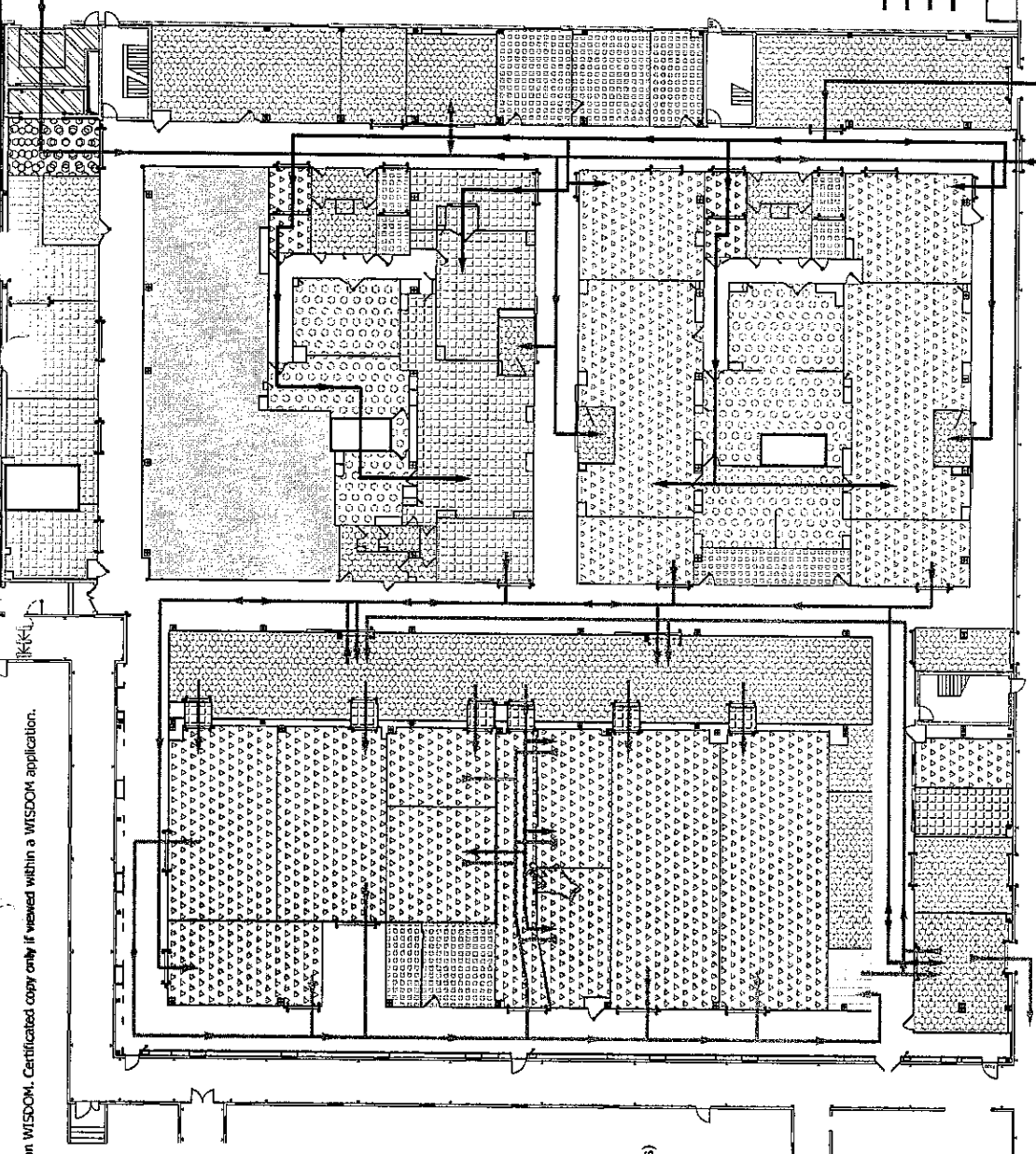

Final bulk product
Filled product
Inspected product
Primary packaging components

Building: **B33** Sub-Building: **REPARTITION** Floor: **0** Class: **Master TQC BPF**

Discipline: **F Flux** Sub-Discipline: **900 Flux-Contrôle** Sheet Type: **PL Vue en Plan**

Sub-Div.-Cat.: **.MP** Raw Materials

Description: **Materials flow**

Layout Name: **06-MP-A3-Anglais**

Drawing ID: **DRWFR_00014059**

File Name: **B33_F900_0_PL04**

Scale: **1:500**

TRADE MARK

sanofi pasteur

La division vaccins du Groupe sanofi-aventis.

BUREAU CÉTUDES
BP 1
37161 VAL DE REUIL

Tel: 02.35.05.90.14
Fax: 02.35.06.62.35

Reproduction of drawing, in part or in whole is forbidden without permission from SANOFI PASTEUR

Modification	N°	Date	Objet	Elaboré par	Appr. par	Intervi. Date
4.0	20 Sep 2010	21 Sep 2010	Modification des flux et des affectations de zones suivant implantation minuscules	Isabelle JACQUET	Christian HARDY	21 Sep 2010
0.1	25 Aug 2010			Isabelle JACQUET	Arnaud LEROY	

ROLE	NOM	DATE - HOUR	Appr. Date	Intervi. Date
Approuver	ROXANA MONTEMILO	21 Sep 2010 07:12:47 FR		
Approuver	CHRISTIAN LEROY	21 Sep 2010 08:37:43 FR		
Final Approuver	CLEMENT DENIS	21 Sep 2010 15:24:38 FR		

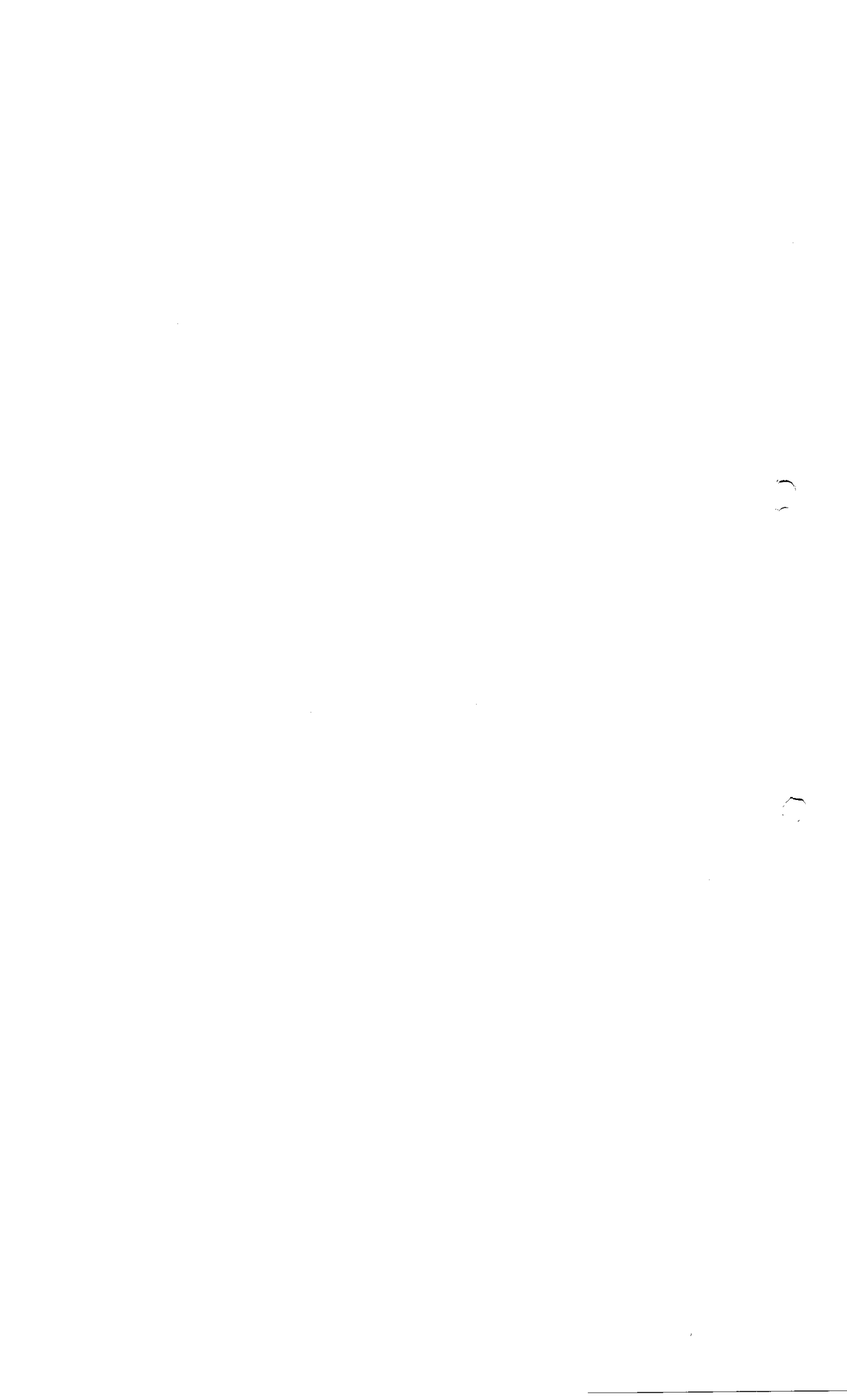



3.2.A.1

Clean and Soiled Equipment Flow - Building B33 - Level 0

	
ROXANA MONTEMILONE	CHRISTIAN DOMINGUEZ
DIRECTORA TÉCNICA	APODERADO
SANOPI PASTEUR S.A.	SANOPI PASTEUR S.A.

