

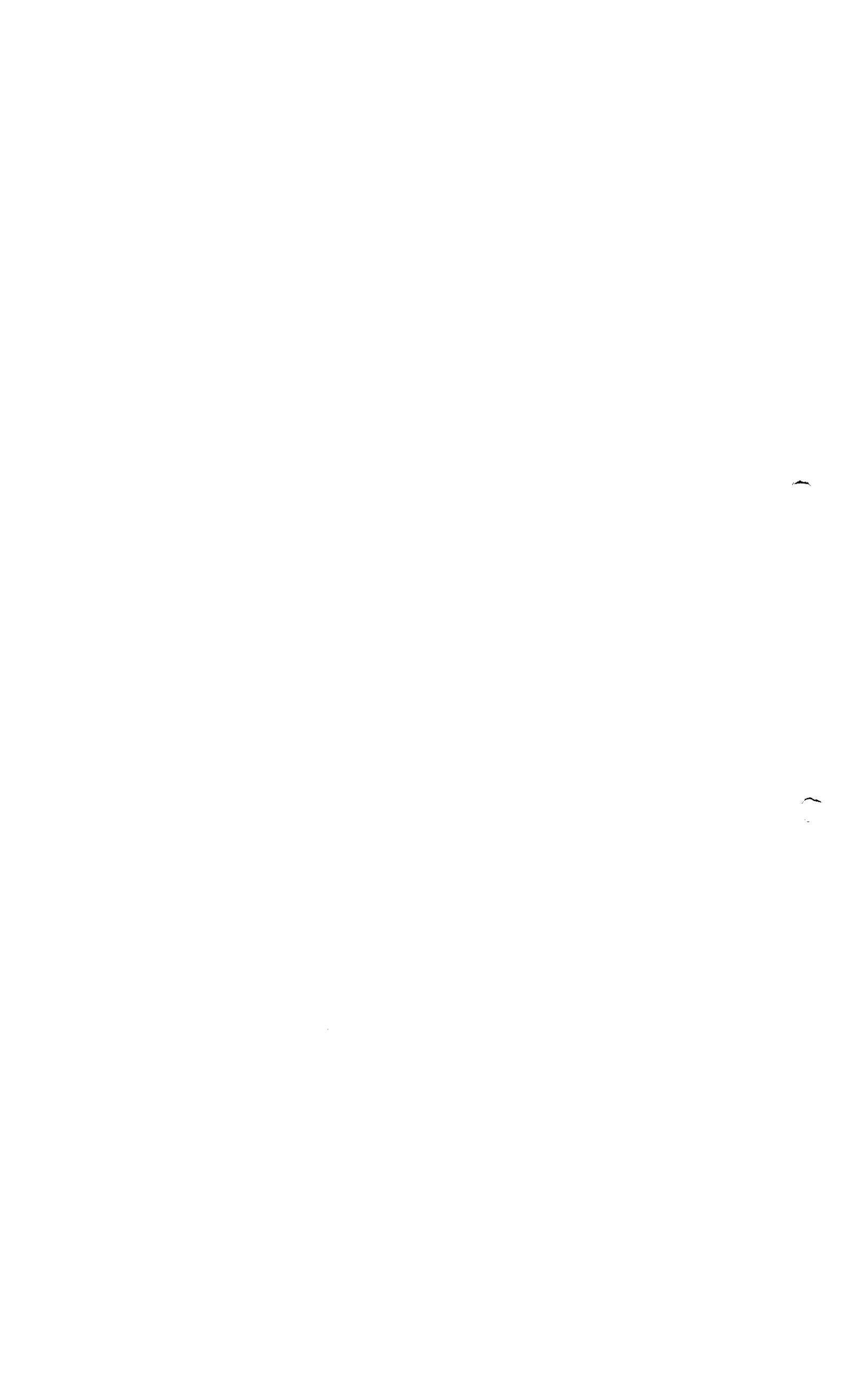

**3.2.A.1**

**Product Flow - Final Bulk Product - Building Abis South - Level 2**

   
ROXANA MONTEMILONE      CHRISTIAN DOMINGUEZ  
DIRECTORA TÉCNICA      APODERADO  
SANOFI PASTEUR S.A.      SANOFI PASTEUR S.A.





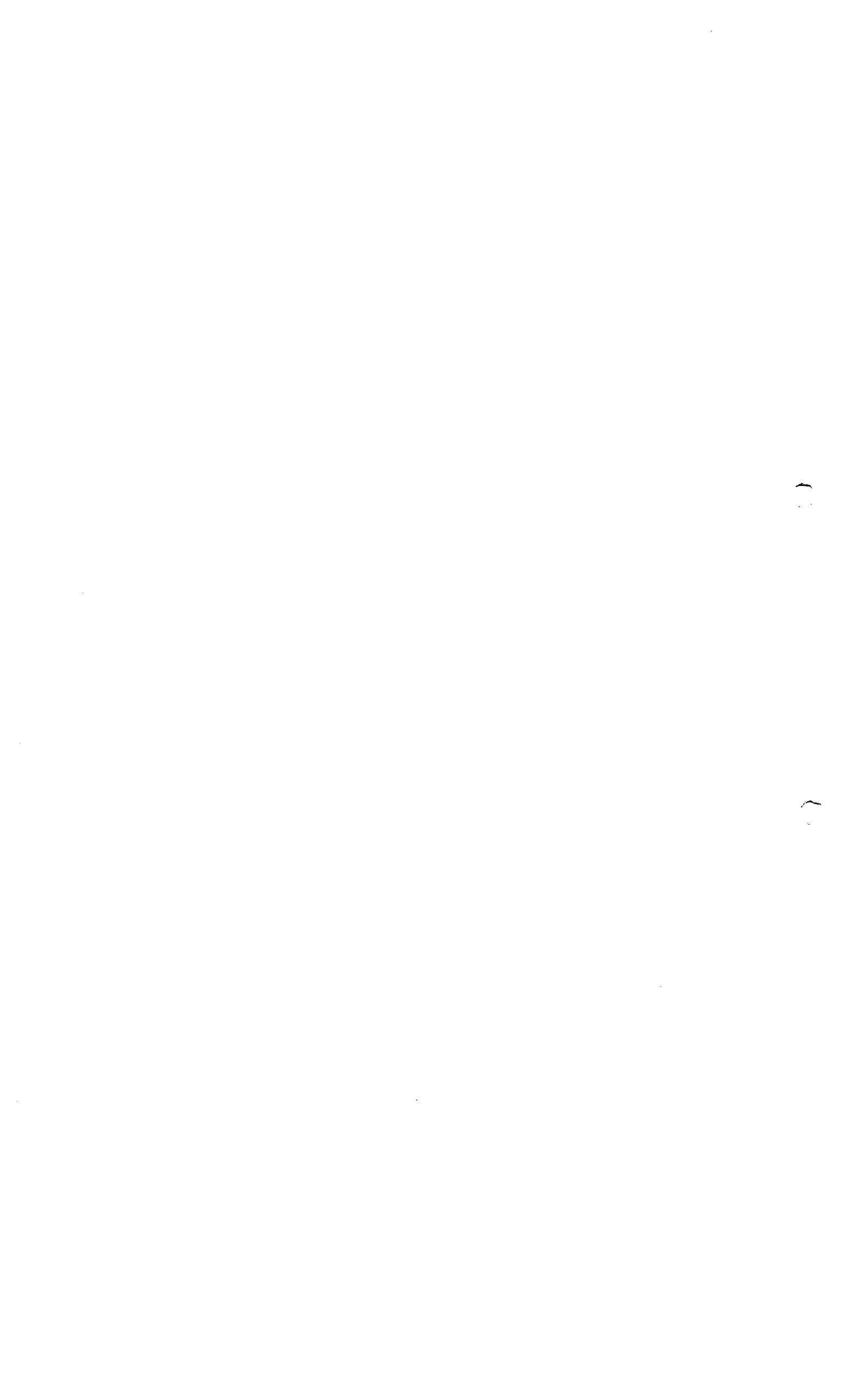



**3.2.A.1**

**Personnel Flow - Building Abis South - Level 2**

  
**ROXANA MONTEMILONE**  
DIRECTORA TÉCNICA  
SANOFI PASTEUR S.A.

  
**CHRISTIAN DOMINGUEZ**  
APODERADO  
SANOFI PASTEUR S.A.

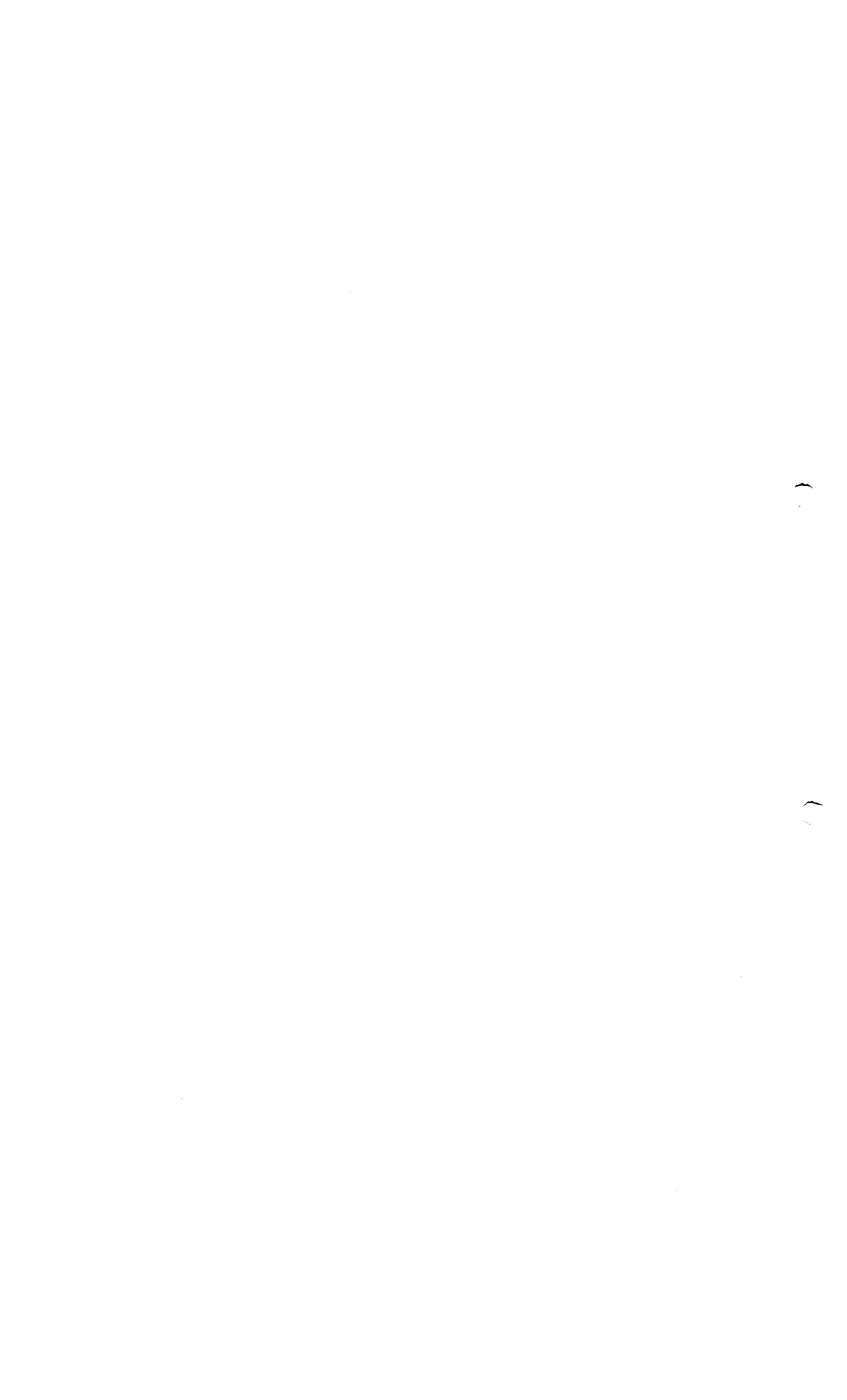



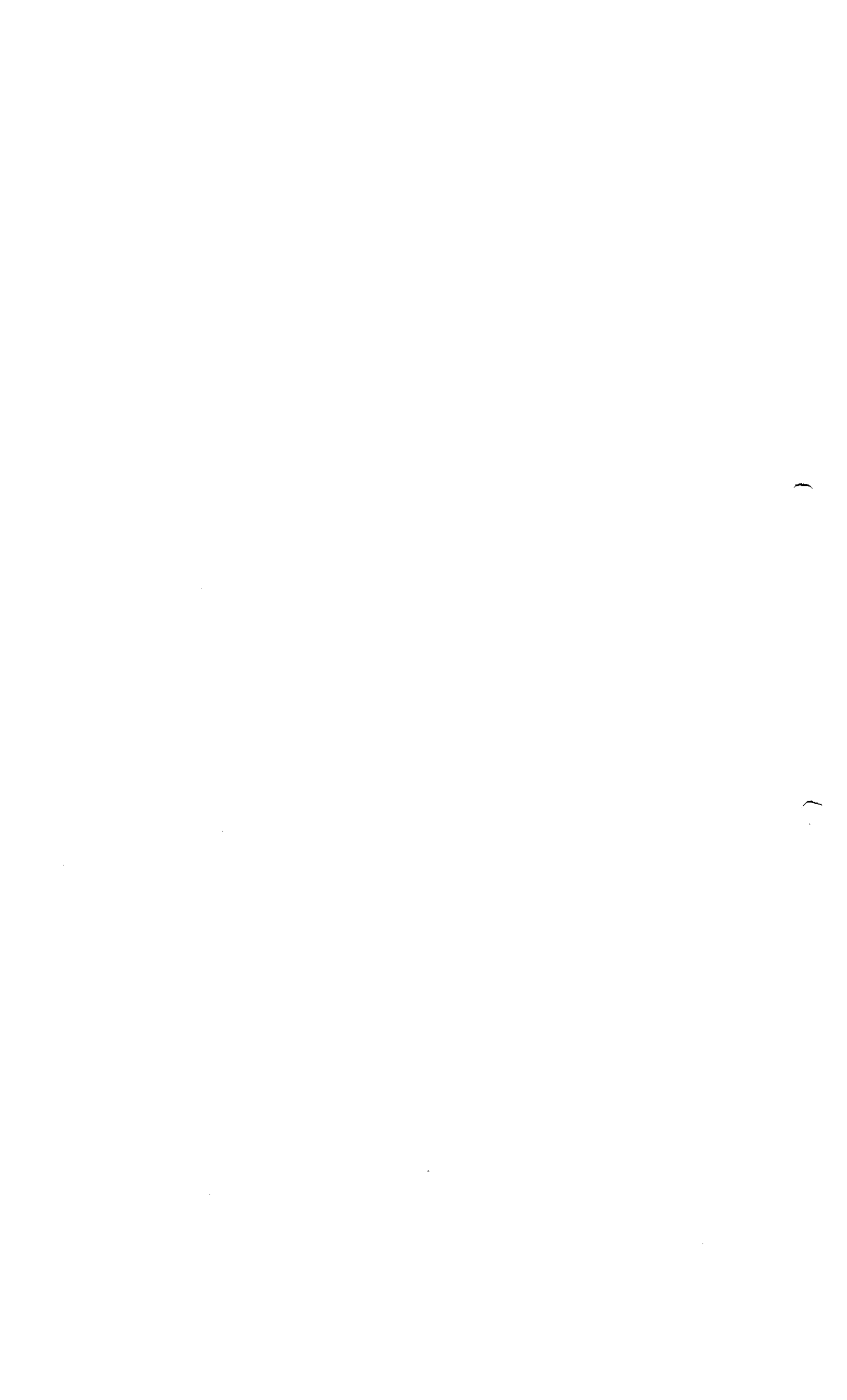



3.2.A.1

**Clean and Soiled Equipment Flow - Building Abis South - Level 2**

  
ROXANA MONTEMILONE  
DIRECTORA TÉCNICA  
SANOPI PASTEUR S.A.

  
CHRISTIAN DOMINGUEZ  
APODERADO  
SANOPI PASTEUR S.A.

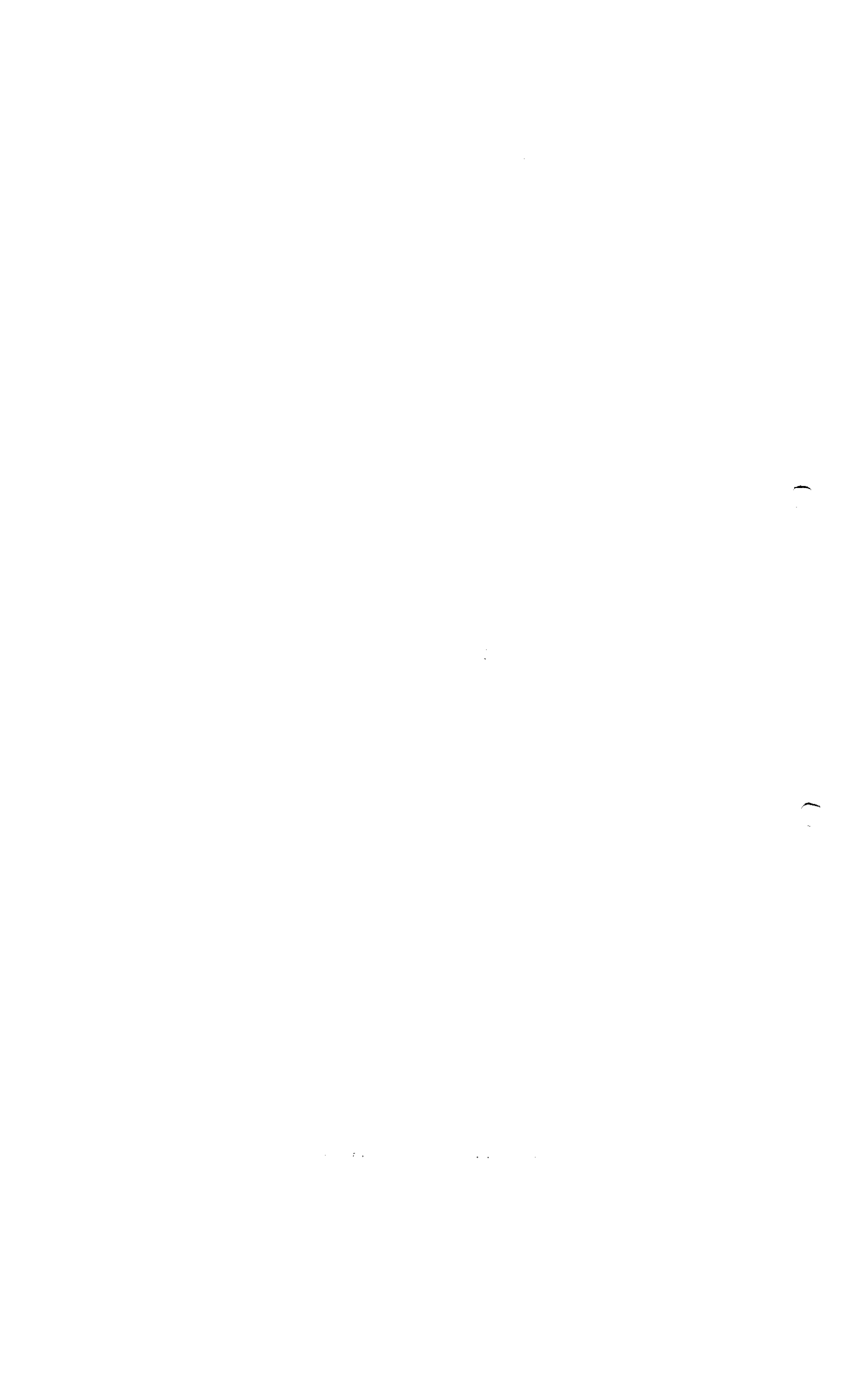

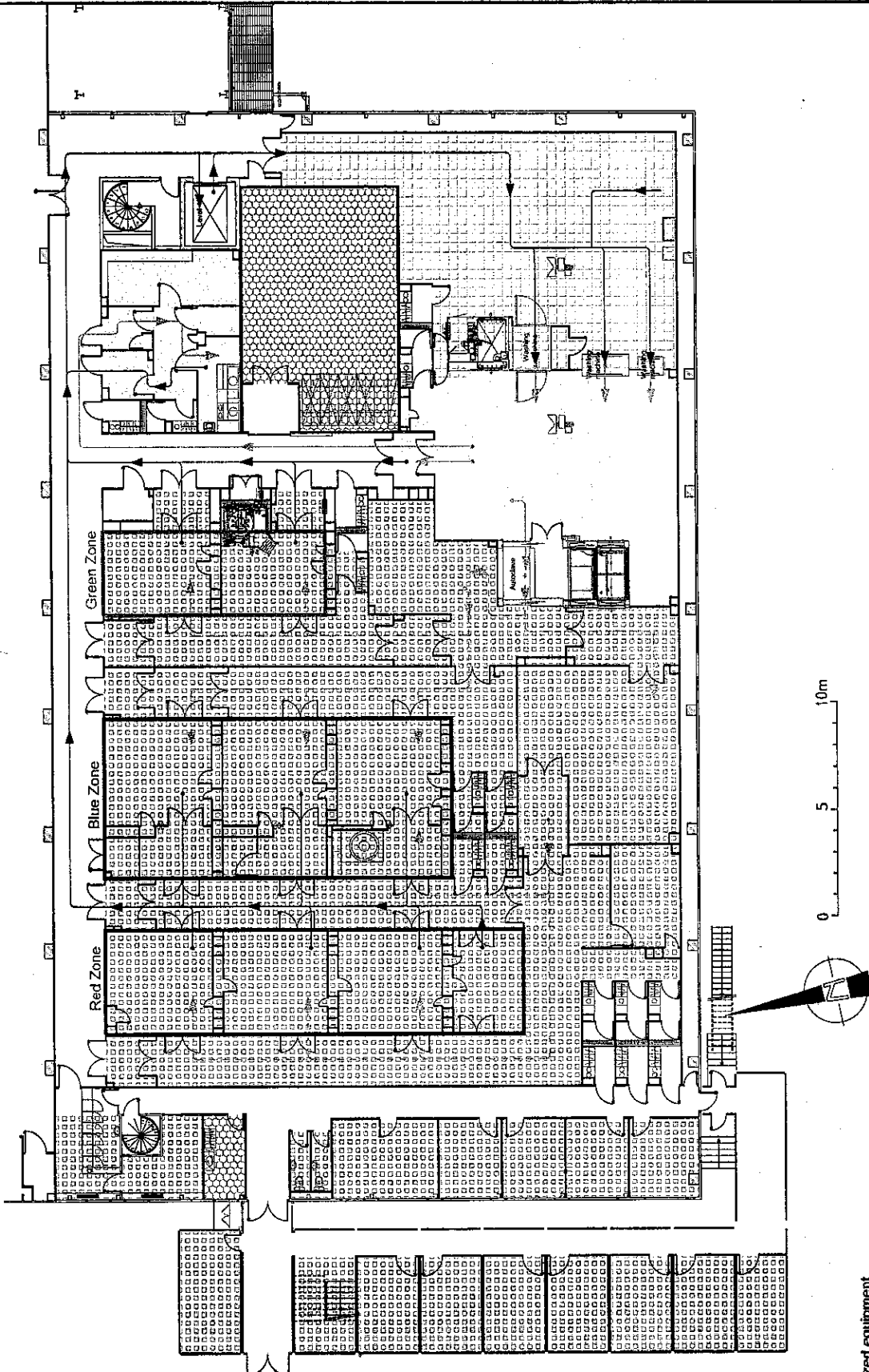

- Formulation area
- Cold room
- Preparation area
- Washing area
- Locker room
- Offices

- Clean and sterilized equipment
- Clean equipment
- Suited equipment

ROXANA MONTEMLONE  
DIRECTORA TÉCNICA  
SANOFI PASTEUR S.A.

CHRISTIAN DOMINGUEZ  
APODERADO  
SANOFI PASTEUR S.A.

Building: **Abis** Sub-Building: **South** Floor: **2** Class: **Master TQC BPF**  
 Discipline: **F Flux** Sub-Discipline: **.900 Flow-Control** Sheet Type: **.PL Plan view**  
 Sub-Dis-Cat: **.MAT** Equipment  
 Description: **Equipment flow for Drug Product**

Layout Name: **07-MAT-A3**  
 Drawing ID: **DRWFR\_00010834**  
 File Name: **Abis\_F900\_2\_PL08**

**sanofi pasteur**  
 La division vaccins de Groupe sanofi-aventis.  
 BUREAU D'ETUDES  
 CAMPUS MERIEUX 1511, AV. MARIE MERIEUX  
 62280 RANCY L'ETOILE  
 Tel: 04 37 37 01 00  
 Fax: 04 37 37 38 01

Scale: 1/2000  
 Date: 17/06/2007  
 FOLIO 101  
 ENTRADA

Drawings are the copyright property of SANOFI PASTEUR S.A. and its subsidiaries. Reproduction of drawings, in part or in whole is forbidden without written permission from sanofi-pasteur.com.

Modification:	Version	Date	Author	Function	Reason
	2.4	29 Oct 2007	CHRISTIAN DOMINGUEZ	Designer	
	0.1	16 Mar 2007	CHRISTIAN DOMINGUEZ	Designer	

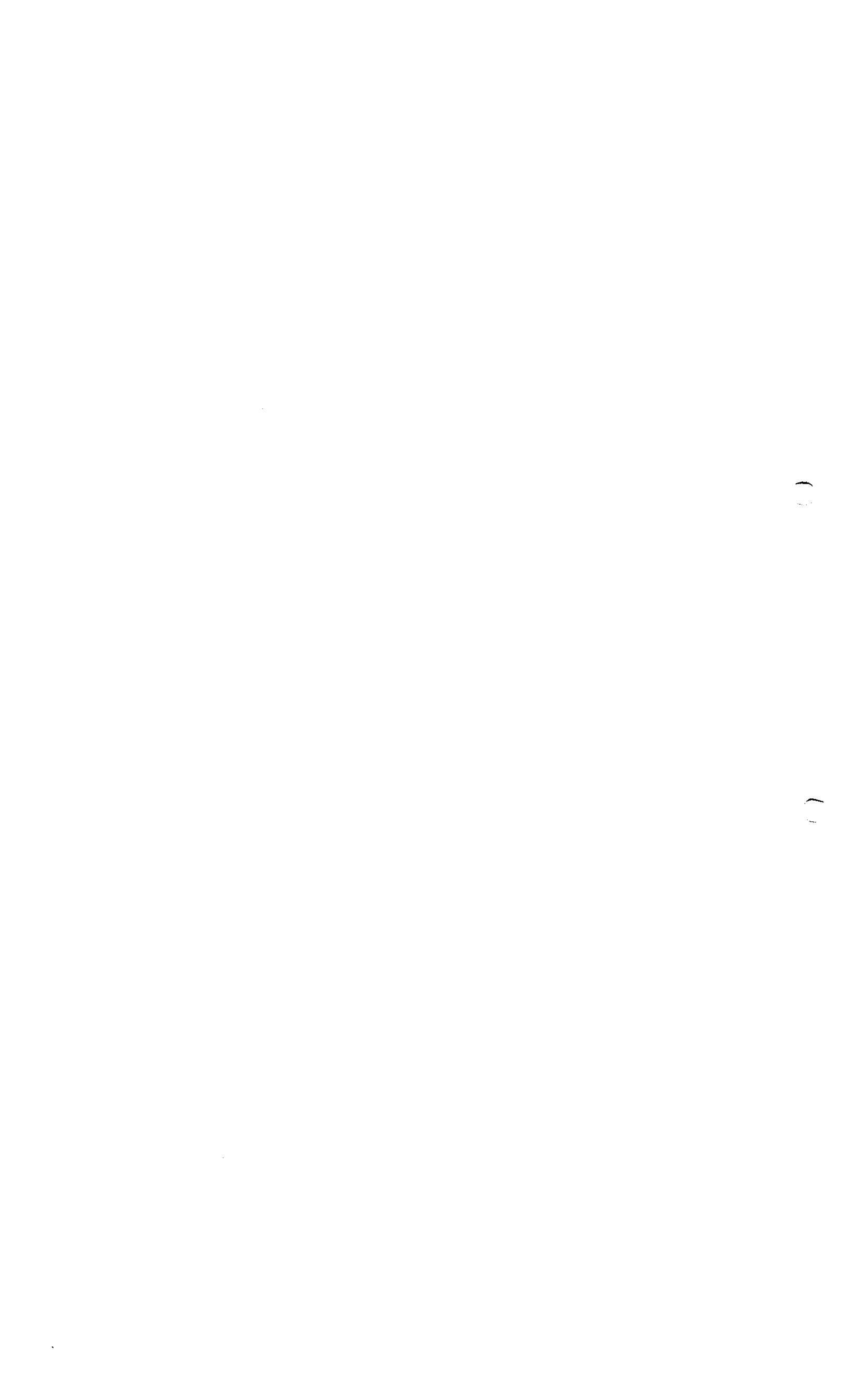



**3.2.A.1**

**Waste Flow - Building Abis South - Level 2**

  
**ROXANA MONTEMILONE**  
DIRECTORA TÉCNICA  
SANGRE PASTEUR S.A.

  
**CHRISTIAN DOMINGUEZ**  
APODERADO  
SANGRE PASTEUR S.A.



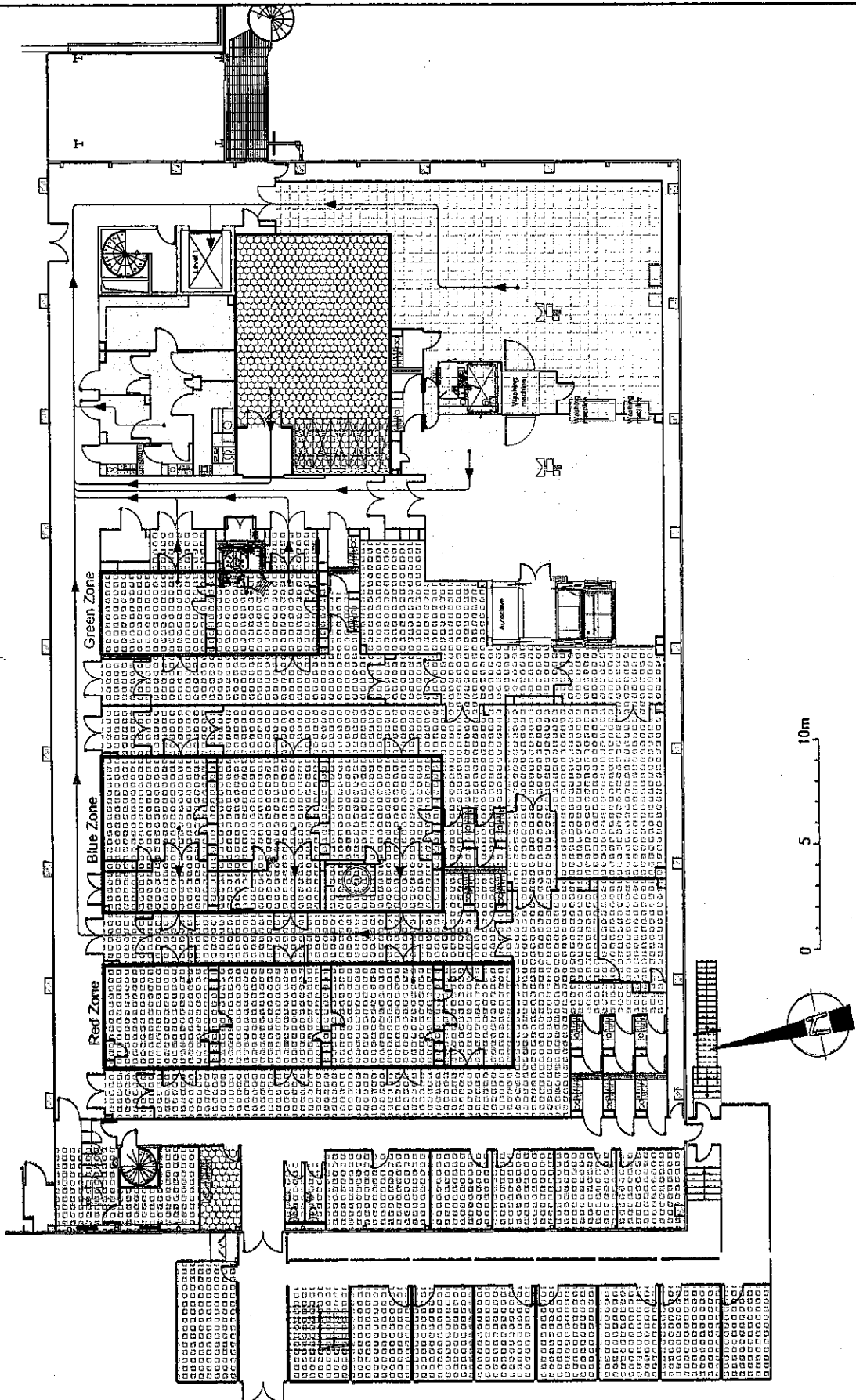

- Formulation area
- Cold room
- Preparation area
- Washing area
- Locker room
- Offices

ROXANA MONTEMILONE  
DIRECTORA TÉCNICA  
SANOFI PASTEUR S.A.

CHRISTIAN DOMÍNGUEZ  
APODERADO  
SANOFI PASTEUR S.A.

Waste

Building : **Abis** Sub-Building : **South** Floor : **2** Class : **Master TOC BPF**

Discipline : **F Flux** Sub-Discipline : **.900 Flow-Control** Sheet Type : **PL Plan view**

Sub-Dis-Cat : **.DECH Waste**

Description : **Waste flow for Drug Product**

Layout Name : **08-DECH-A3** Size : **A3**

Drawing ID : **DRWFR 00010834**

File Name : **Abis\_F900\_2\_PL08**

**sanofi pasteur**  
La division vaccins du Groupe sanofi-aventis

BUREAU D'ETUDES  
CAMPUS MERIEUX  
92000-EMANCY LESTONNE  
Tel : (33) 37 37 01 00  
Fax : (33) 37 37 38 91

Modification :	DATE	REASON :
2.4	29 Oct 2006	LAYOUT Fabrice
0.1	18 Mar 2006	LAYOUT Fabrice
		Designer
		Design verifier
		DATE - HOUR :
		REASON :

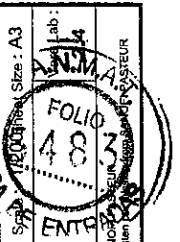

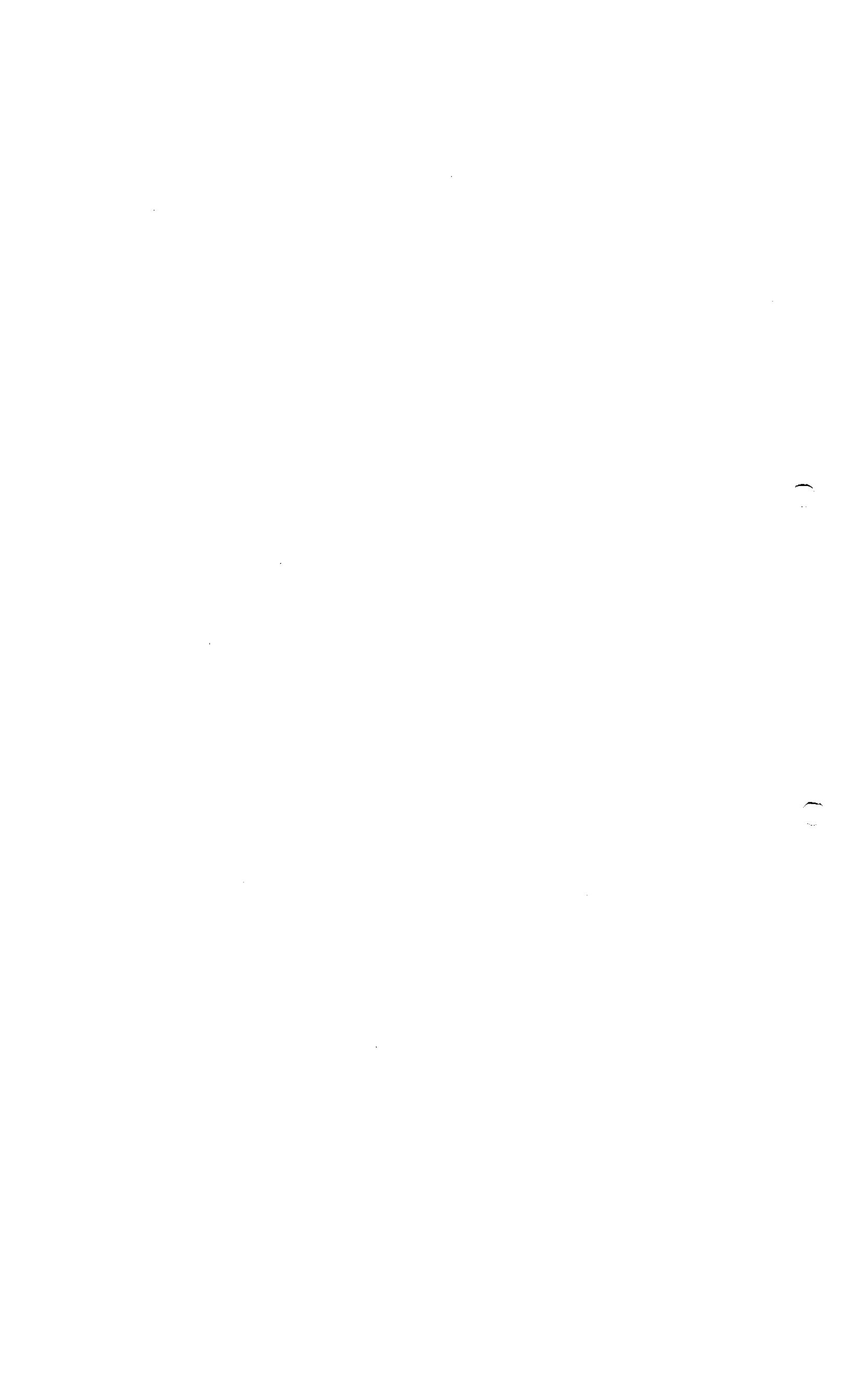

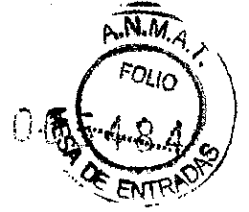

**3.2.A.1**

**Department Allocation Plan - Building V5 - Level 2**

	
<b>ROXANA MONTEMILONE</b>	<b>CHRISTIAN DOMINGUEZ</b>
<b>DIRECTORA TÉCNICA</b>	<b>APODERADO</b>
<b>SANOFI PASTEUR S.A.</b>	<b>SANOFI PASTEUR S.A.</b>

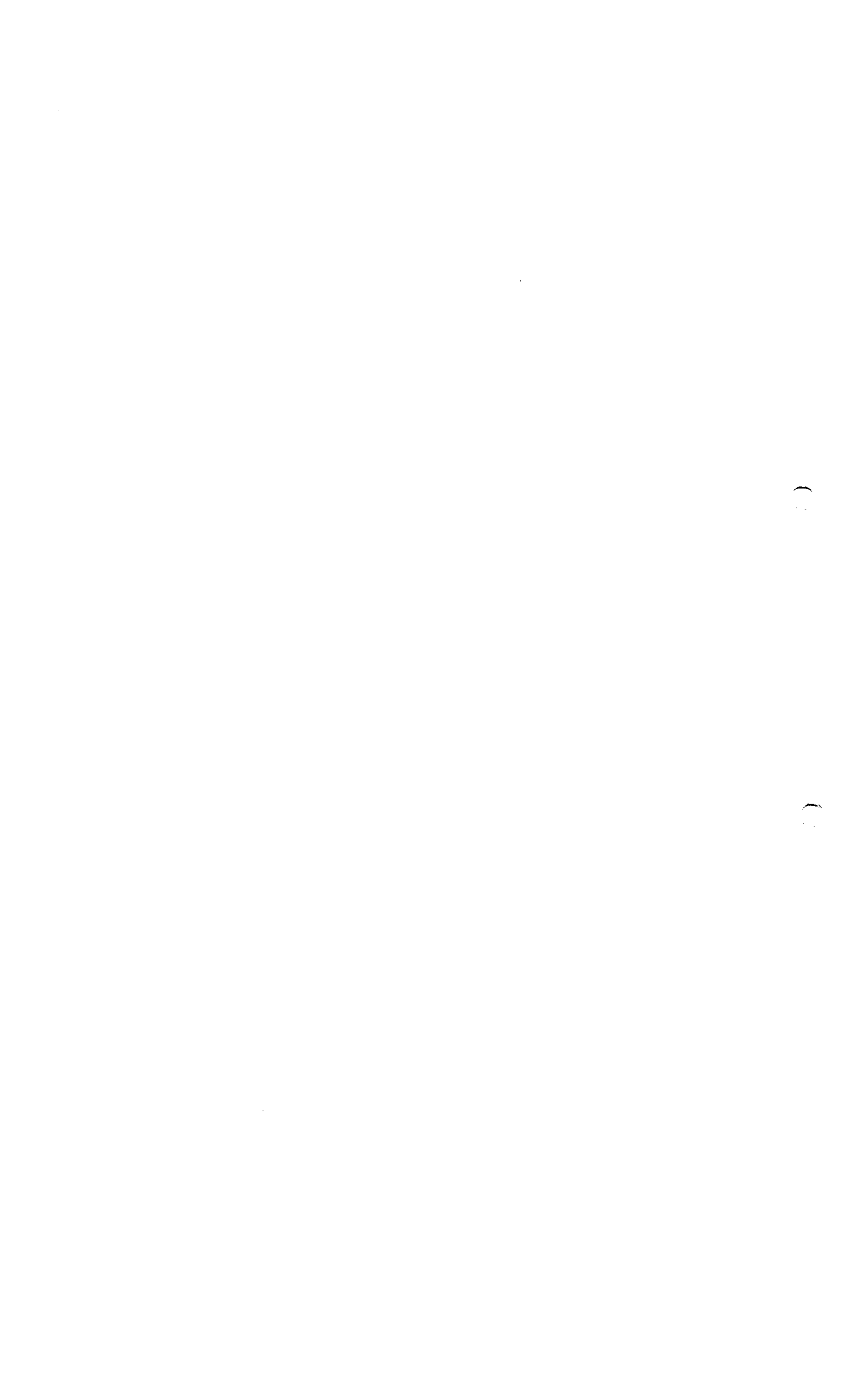

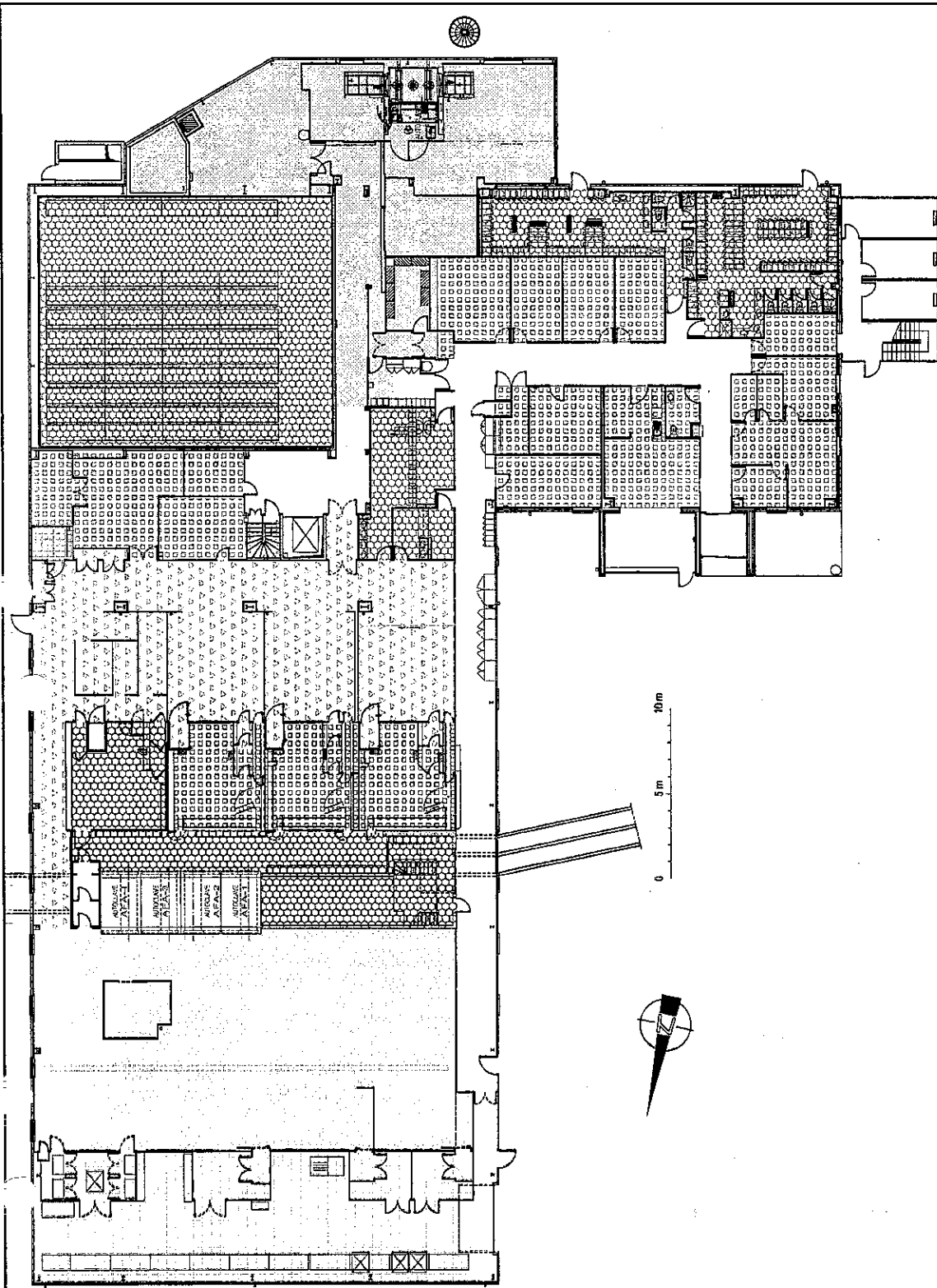

- Cold room
- Delivery area for primary packaging
- Filling area
- Primary packaging storage area
- Locker room
- Offices
- Transfer area
- Utilities
- Visual inspection area
- Not applicable
- Washing and storage area
- Preparation area
- Waste area

JOXANA MONTEMLONE  
 DIRECTORA TÉCNICA  
 SANOFI PASTEUR S.A.

lh  
 CHRISTIAN DOMINGUEZ  
 APODERADO  
 SANOFI PASTEUR S.A.

Building : **V5** Sub-Building : **Flow-Control** Floor : **2** Class : **Master TQC BPF**  
 Disciplines : **F Flux** Sub-Disciplines : **.900** Sheet Type : **.PL** Plan View  
 Sub-Dis. - Cat. : **.DZ** Department Allocation  
 Description : **Production zone for Drug Product**

Layout Name : **01-DZ-A3** Scale : **1/250** Sheet Size : **A3**  
 Drawing ID : **DRWFR\_00010777**  
 File Name : **V5\_F900\_2\_PL05**

**sanofi pasteur**  
 La division vaccins du Groupe sanofi-aventis  
 BUREAU D'ETUDES  
 CAMPUS MERIEUX 1541 Av. Muciel MERIEUX  
 68230 MARCY L'ETOLE  
 Tel : 04 37 37 01 09  
 Fax : 04 37 37 38 91

Drawings are the copyright property of SANOFI PASTEUR  
 Reproduction of drawings, in part or in whole is forbidden without written permission from SANOFI PASTEUR

Version	Date	Status	Design verifier	Designer	Drawn	Checked	Month	Year
1.5	07 Mar 2010	01						
FUNCTION : DATE - HOUR : REASON :								

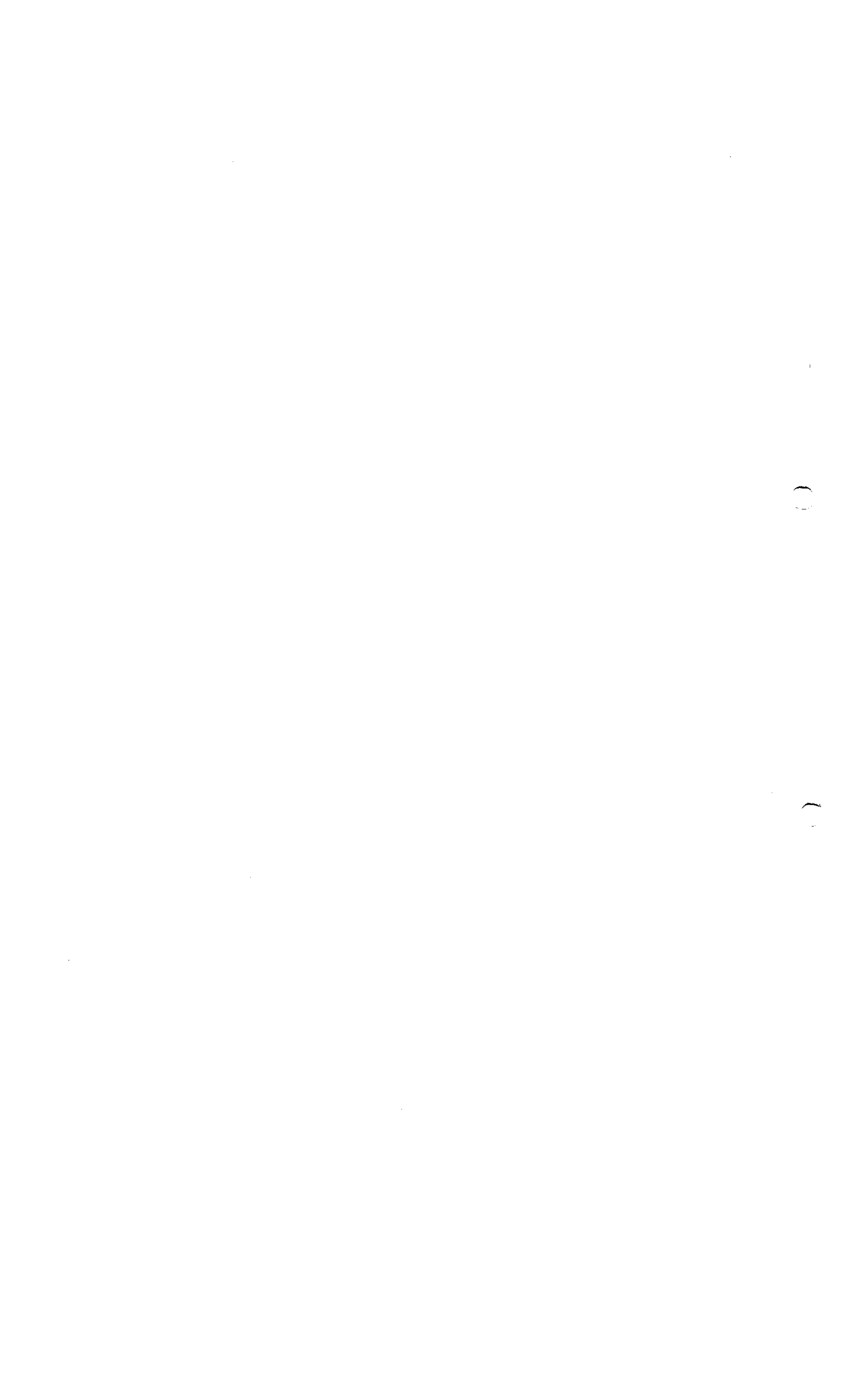



**3.2.A.1**

**Product Flow - Building V5 - Level 2**

  
ROXANA MONTEMILONE  
DIRECTORA TÉCNICA  
SANOFI PASTEUR S.A.

  
CHRISTIAN DOMINGUEZ  
APODERADO  
SANOFI PASTEUR S.A.

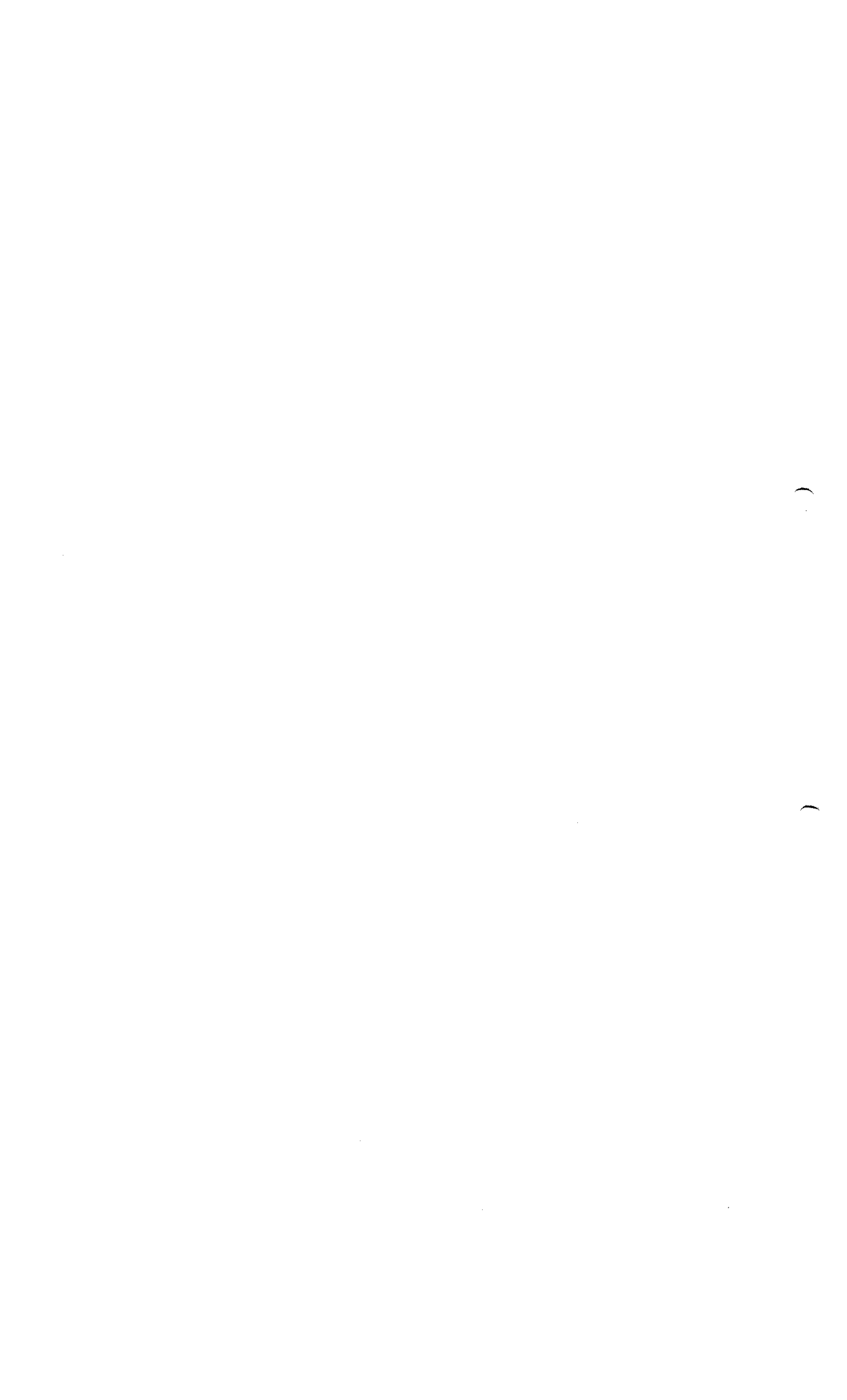



0

0



**3.2.A.1**

**Personnel Flow - Building V5 - Level 2**

  
ROXANA MONTEMILONE  
DIRECTORA TÉCNICA  
SANOFI PASTEUR S.A.

  
CHRISTIAN DOMINGUEZ  
APODERADO  
SANOFI PASTEUR S.A.



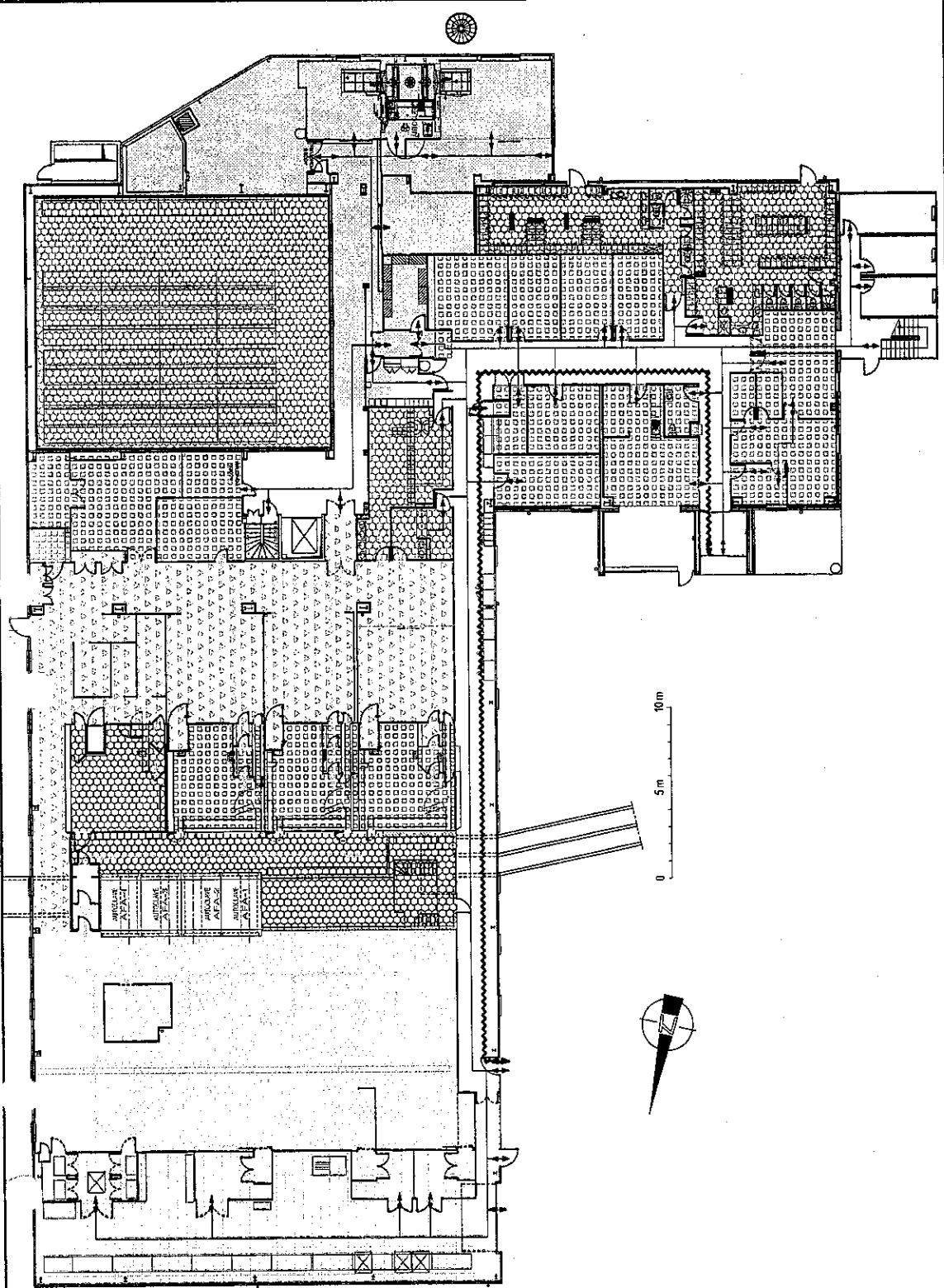

- Cold room
- Delivery area for primary packaging
- Filling area
- Primary packaging storage area
- Locker room
- Offices
- Transfer area
- Utilities
- Visual inspection area
- Not applicable
- Washing and storage area
- Preparation area
- Waste area
- Visitors
- Outdoor clothing personnel
- Zone personnel

ROXANA MONTEMILONE  
DIRECTOR TÉCNICA  
SANOEL PASTEUR S.A.

CHRISTIAN DOMINGUEZ  
APODERADO  
SANOEL PASTEUR S.A.

Version	Date	Status	Design verifier	Designer	Appr Date	Inactiv Date
1.5	06/03/2011	Draw				
0.1	27/03/2010	Design				

Modification zoning suite intégration du projet STS

DATE - HOUR : (REASON):

Building : **V5** Sub-Building : **Personal** Floor : **2** Class : **Master TQC BPF**

Discipline : **F Flux** Sub-Discipline : **.900 Flow-Control** Sheet Type : **.PL Plan view**

Sub-Dis.-Cat : **PER** Description : **Personnel flow for Drug Product**

Layout Name : **02-PER-A3** Drawing ID : **DRWFR\_00010777**

File Name : **V5\_F900\_2\_PL05**

**sanofi pasteur**  
La division vaccins du Groupe sanofi-aventis.

BUREAU D'ETUDES  
CAMPUS MERIEUX - 1241 Av. Merieux  
69008 SAINTE-OTILIE

Échelle : 1:200  
Date : 03/03/2011

Scale: 1/200  
Date: 03/03/2011

Reproduction of drawings, in part or in whole is forbidden without written permission from SANOFI PASTEUR.





3.2.A.1

**Clean and Soiled Equipment Flow - Building V5 - Level 2**

  
ROXANA MONTEMILONE  
DIRECTORA TÉCNICA  
SANOFI PASTEUR S.A.

  
CHRISTIAN DOMINGUEZ  
APODERADO  
SANOFI PASTEUR S.A.

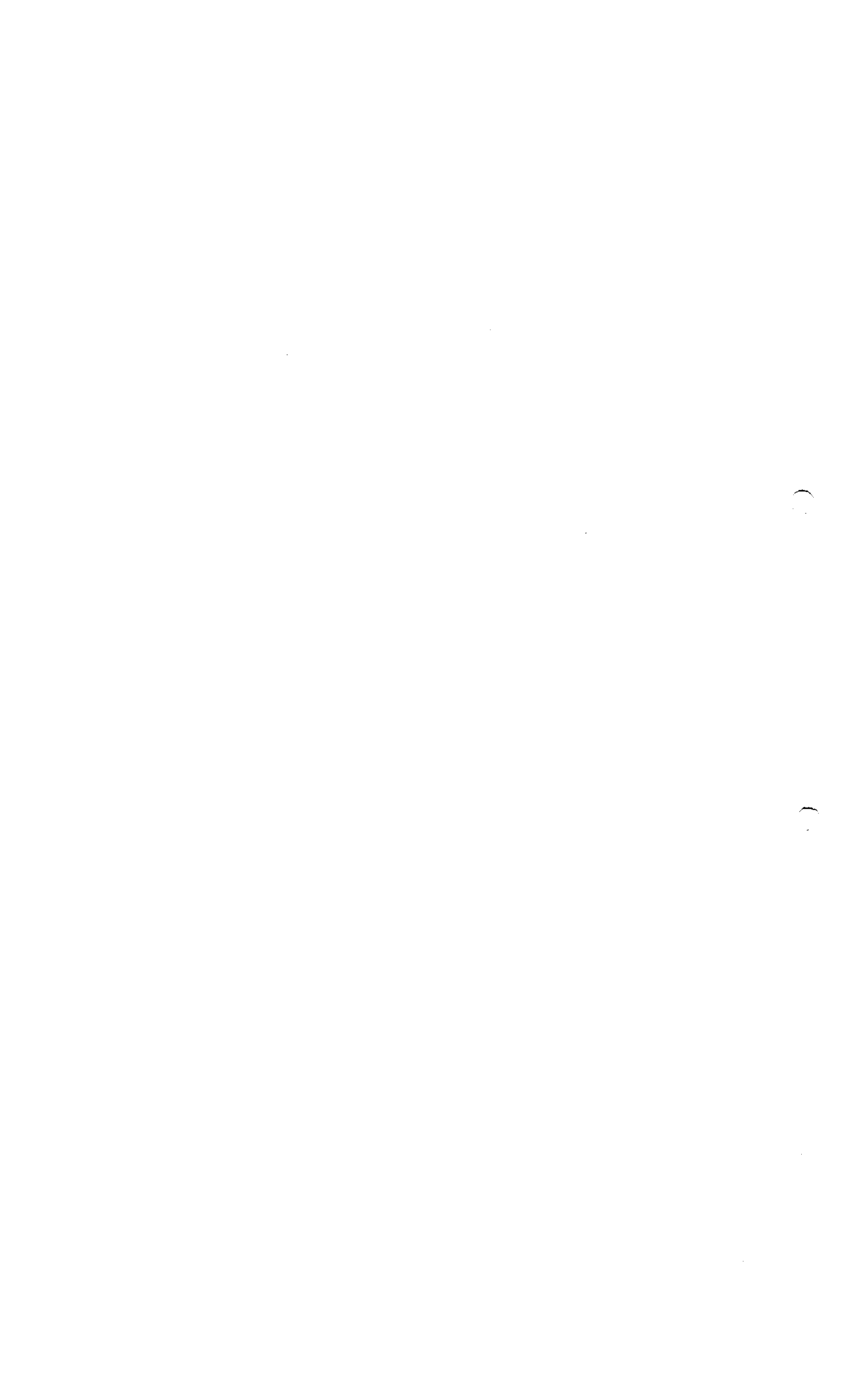

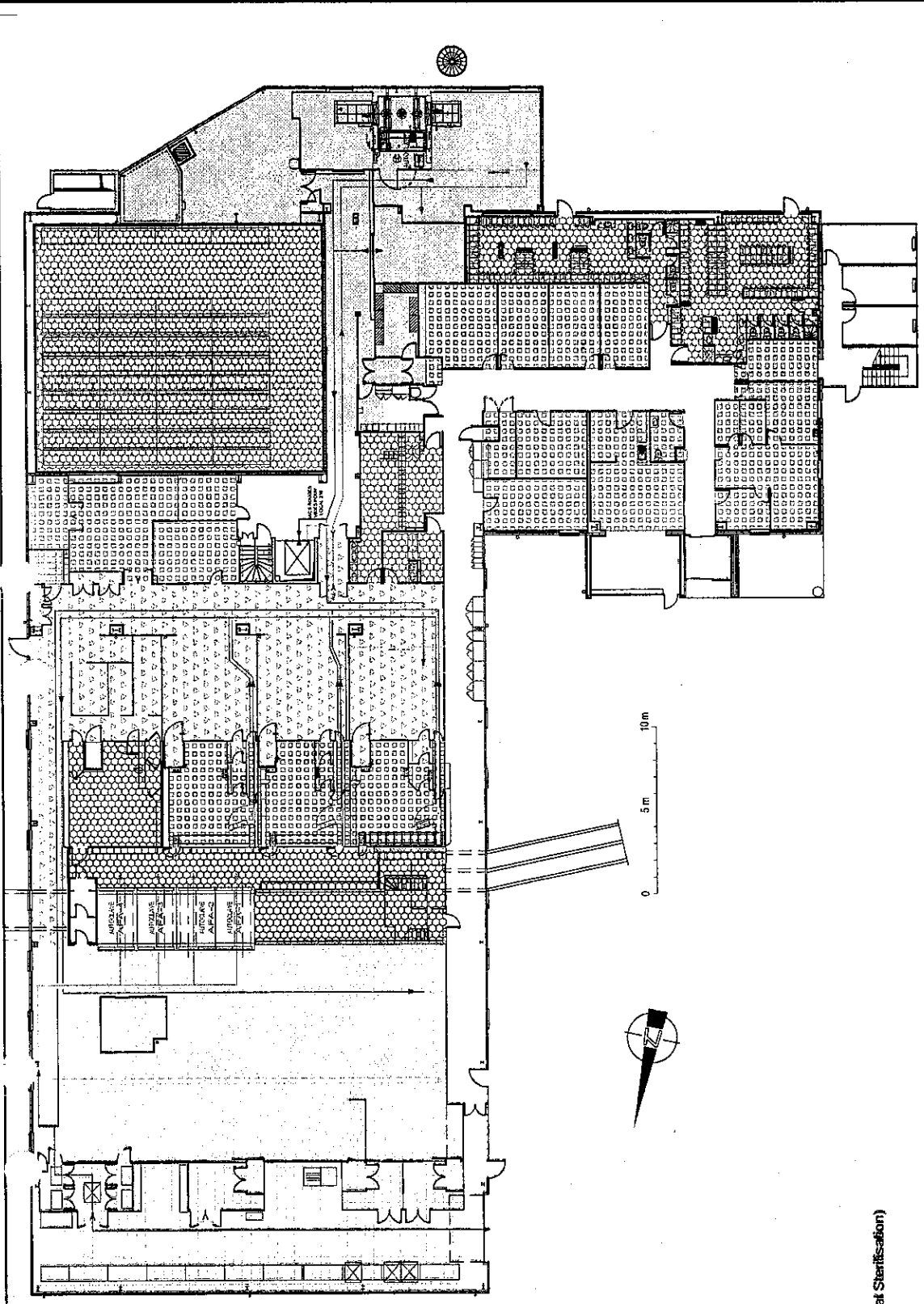

- Cold room
- Delivery area for primary packaging
- Filling area
- Primary packaging storage area
- Locker room
- Offices
- Transfer area
- Utilities
- Visual inspection area
- Not applicable
- Washing and storage area
- Preparation area
- Waste area
- Clean equipment
- Soiled equipment
- Stream empty wagons ( Terminal Sterilisation)
- Stream empty wagons ( AFA)

ROXANA MONTEMLONE  
DIRECTORA TÉCNICA  
SANOFI PASTEUR S.A.

CHRISTIAN DOMÍNGUEZ  
APODERADO  
SANOFI PASTEUR S.A.

Building : **V5** Sub-Building : **Flow-Control** Floor : **2** Class : **Master TQC BPF**

Discipline : **F Flux** Sub-Discipline : **.900 Equipment** Sheet Type : **.PL Plan view**

Sub-Dis. Cat. : **.MAT** Description : **Equipment flow for Drug Product**

Layout Name : **04-MAT-A3** Scale : **1:100**

Drawing ID : **DRWFR\_00010777**

File Name : **V5\_F900\_2\_PL05**

**sanofi pasteur**  
La division vaccins du Groupe sanofi-aventis.

BUREAU D'ÉTUDES  
CAMPUS BIÉREUX 1541, Av. Nancette Biéreau  
92500 NANTY-LEZ-LILLE

Tel : 03 20 37 93 60  
Fax : 03 20 37 93 91

Reproduction of drawings, in part or in whole, is forbidden without written permission from Sanofi Pasteur.

PROJETS	DATE	DESIGNER	STATUS	REASON
Fabrics LAYOUT				
Fabrics LAYOUT				
Drawer				
DATE - HOUR :				
NAME :				
FUNCTION :				
Appr Date				
Inactivity Date				

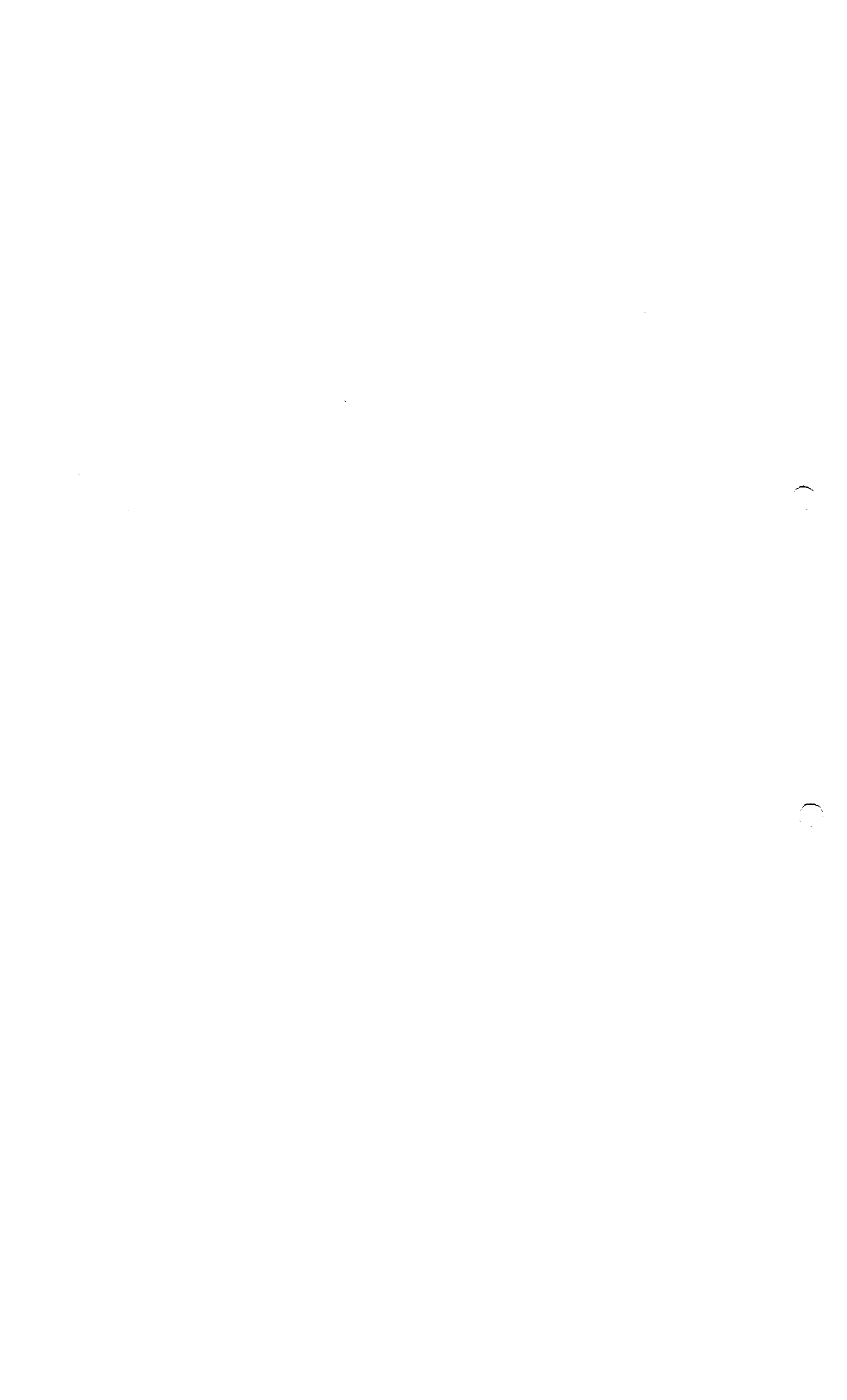



**3.2.A.1**

**Waste Flow - Building V5 - Level 2**



ROXANA MONTEMILONE  
DIRECTORA TÉCNICA  
SANOFI PASTEUR S.A.



CHRISTIAN DOMINGUEZ  
APODERADO  
SANOFI PASTEUR S.A.

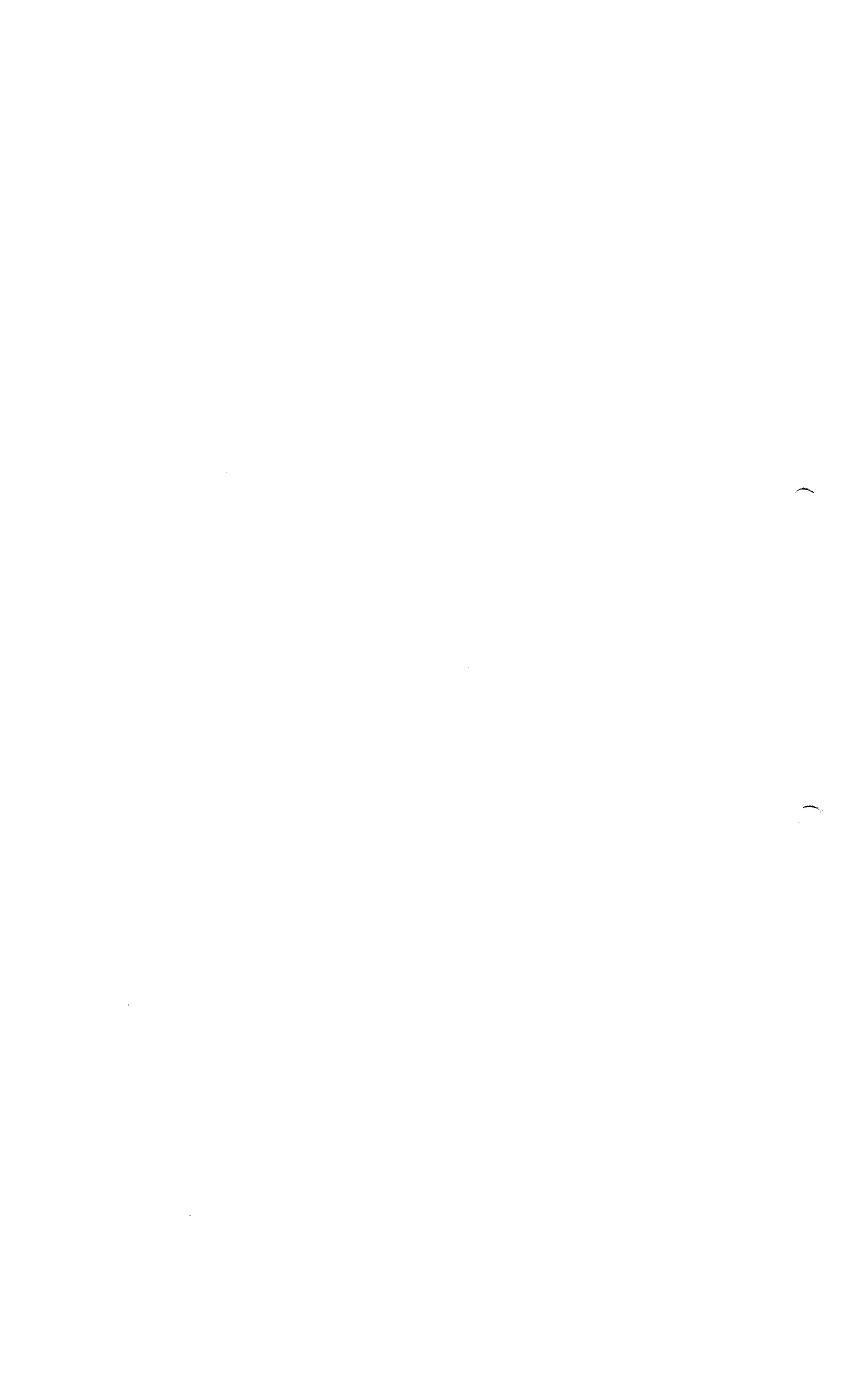

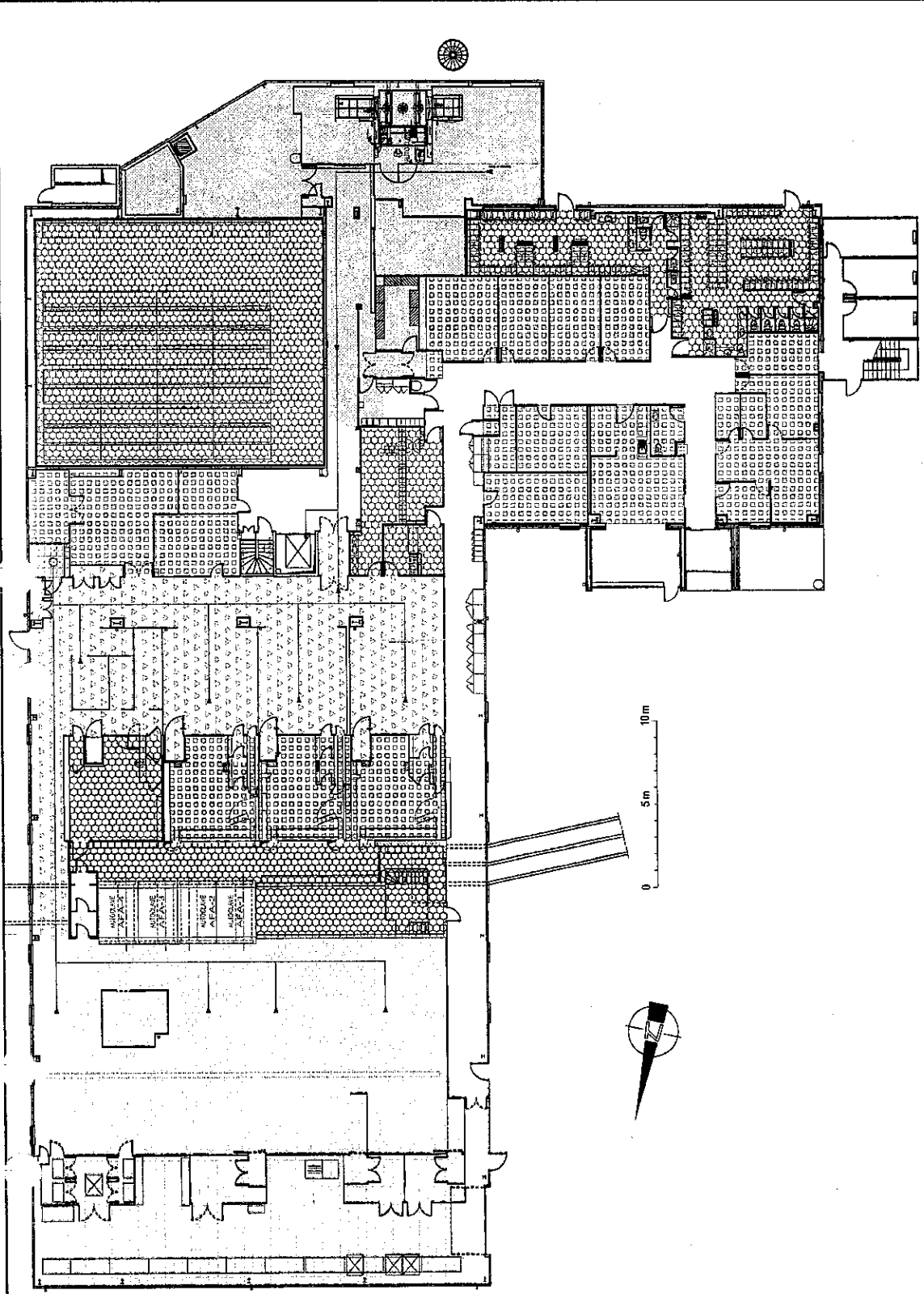

- Cold room
- Delivery area for primary packaging
- Filling area
- Primary packaging storage area
- Locker room
- Offices
- Transfer area
- Utilities
- Visual inspection area
- Not applicable
- Washing and storage area
- Preparation area
- Waste area
- Waste
- Waste

JOXANA MONTEMILONE  
 DIRECTORA TÉCNICA  
 SANOFI PASTEUR S.A.

CHRISTIAN DOMINGUEZ  
 APODERADO  
 SANOFI PASTEUR S.A.

Building : **V5** Sub-Building : **Waste** Class : **Master TOC BPF**  
 Discipline : **F Flux** Sub-Discipline : **.900 Flow-Control** Sheet Type : **.PL Plan view** Floor : **2**

Sub-Dis.-Cat : **DECH Waste**  
 Description : **Waste flow for Drug Product**

**sanofi pasteur**  
 La division vaccins du Groupe sanofi-aventis.

BUREAU DES ETUDES  
 CAMPUS AGRICOLA 10411 AV. MARCEL MERIEUX  
 91250 MARYSURY L'ETILE

TEL : 01 67 35 50 00  
 FAX : 01 67 32 28 91

Layout Name : **05-DECH-A3** Scale : **1/100**  
 Drawing ID : **DRWFR 00010777**  
 File Name : **V5\_F900\_2\_PL05**

Reproduction of drawings, in part or in whole is forbidden without permission of SANOFI PASTEUR S.A.

ROLE	NAME	STATUS	DATE	REASON
Designer	Christian Dominguez	07/07/10		
Appr Date				
Activity Date				

