



3.2.A.1

**Flow of Clean and Soiled Equipment - Crude Diphtheria Toxoid - Building V4
- Level 0**







ROXANA MONTEMILONE
DIRECTORA TÉCNICA
SANOFI PASTEUR S.A.

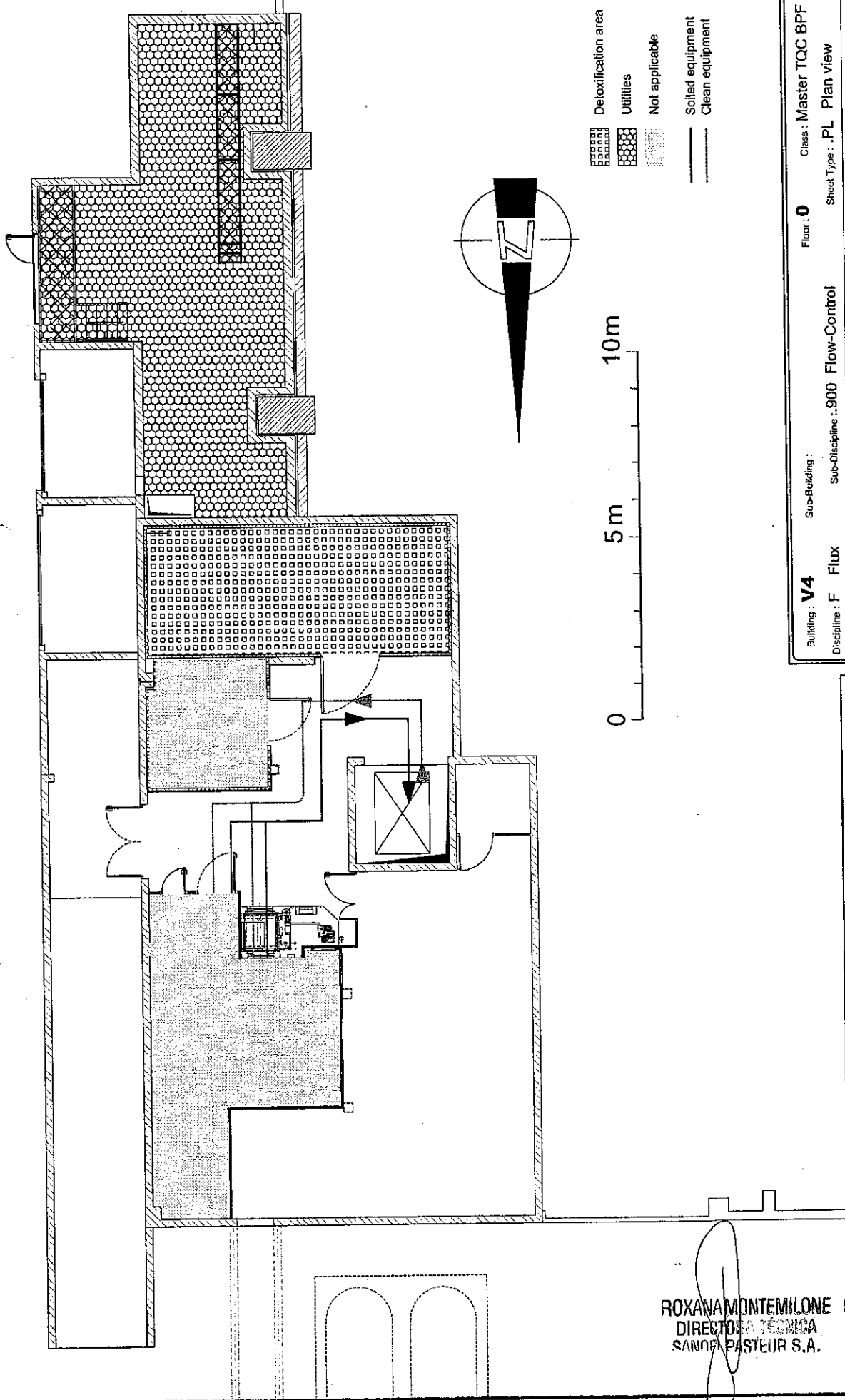

CHRISTIAN DOMINGUEZ
APODERADO
SANOFI PASTEUR S.A.



-  Detoxification area
-  Utilities
-  Not applicable
-  Soiled equipment
-  Clean equipment

Building: **V4** Sub-Building: **0** Class: **Master TQC BPF**
 Discipline: **F Flux** Sub-Discipline: **900 Flow-Control** Sheet Type: **.PL Plan view**
 Sub-Dis.-Cat: **.MAT** Equipment
 Description: **Equipment flow for Diptheria**
sanofi pasteur
 La division vaccins du Groupe sanofi-aventis.
 BUREAU D'ETUDES CAMPUS MERIEUX 15-1, Av. Henri MERIEUX 69580 MARCY L'ETOILE
 Tél: 04 72 27 01 00 Fax: 04 72 27 08 31
 Layout Name: **09-MAT-A3** Scale: 1/100sheet
 Drawing ID: **DRWFR 00010725**
 File Name: **V4_F900_0_PL05**
 Reproduction of drawings, in part or in whole is forbidden without written permission from SANOFI PASTEUR

ROXANA MONTEMLONE DIRECTORA TECNICA SANOFI PASTEUR S.A.
 CHRISTIAN DOMINGUEZ INGENIERO EN SISTEMAS SANOFI PASTEUR S.A.

Modification	DATE	DESIGNER	DESIGN VERIFIER	APPROVER	REASON
0.23	2009-04-20	CHRISTIAN DOMINGUEZ	ROXANA MONTEMLONE	CHRISTIAN DOMINGUEZ	
0.1	2009-04-20	CHRISTIAN DOMINGUEZ	ROXANA MONTEMLONE	CHRISTIAN DOMINGUEZ	
0.0	2009-04-20	CHRISTIAN DOMINGUEZ	ROXANA MONTEMLONE	CHRISTIAN DOMINGUEZ	





3.2.A.1

**Flow of Clean and Soiled Equipment - Crude Diphtheria Toxoid - Building V4
- Level 1**

ROXANA MONTEMILONE
DIRECTORA TÉCNICA
SANOFI PASTEUR S.A.

CHRISTIAN DOMINGUEZ
APODERADO
SANOFI PASTEUR S.A.

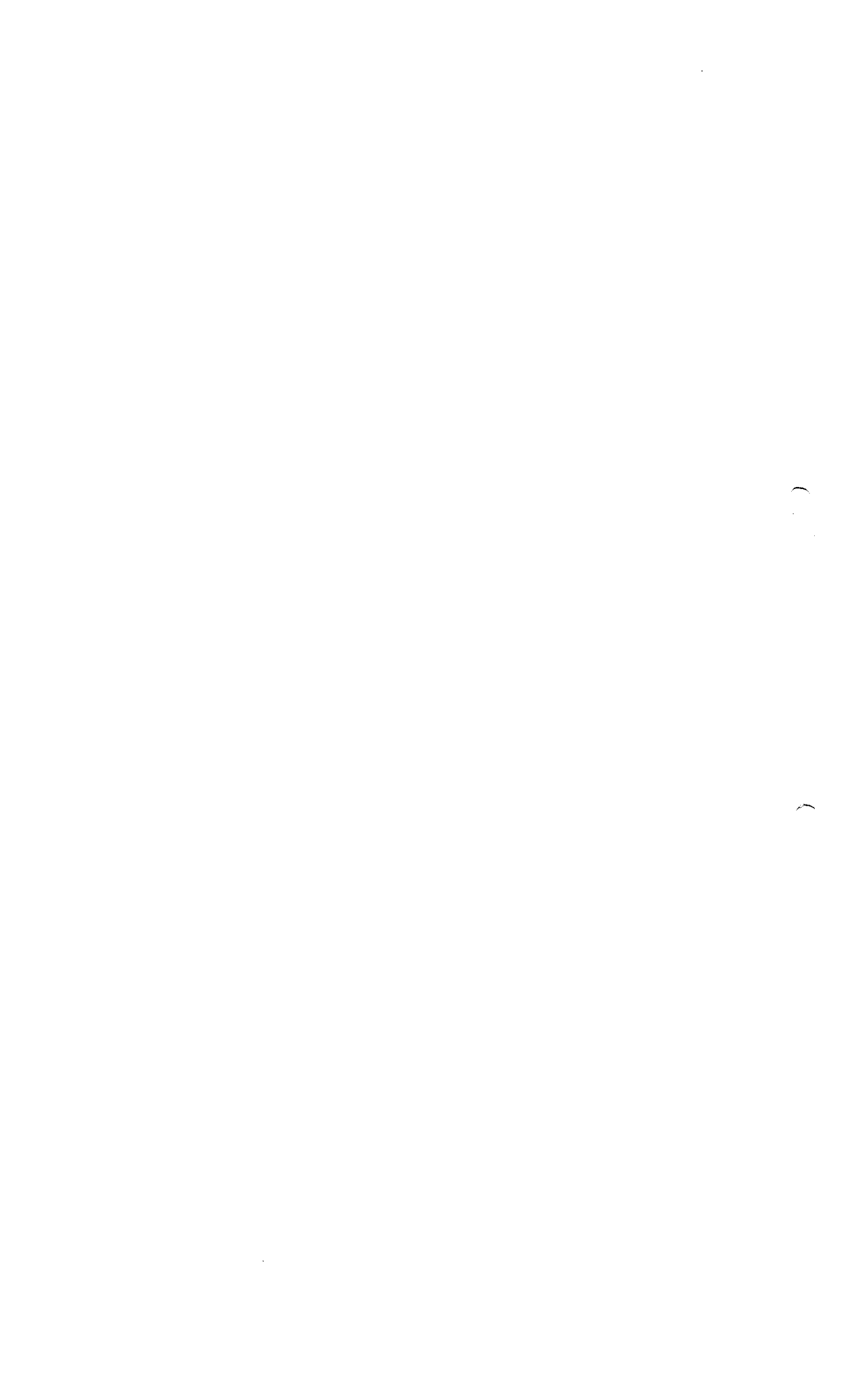

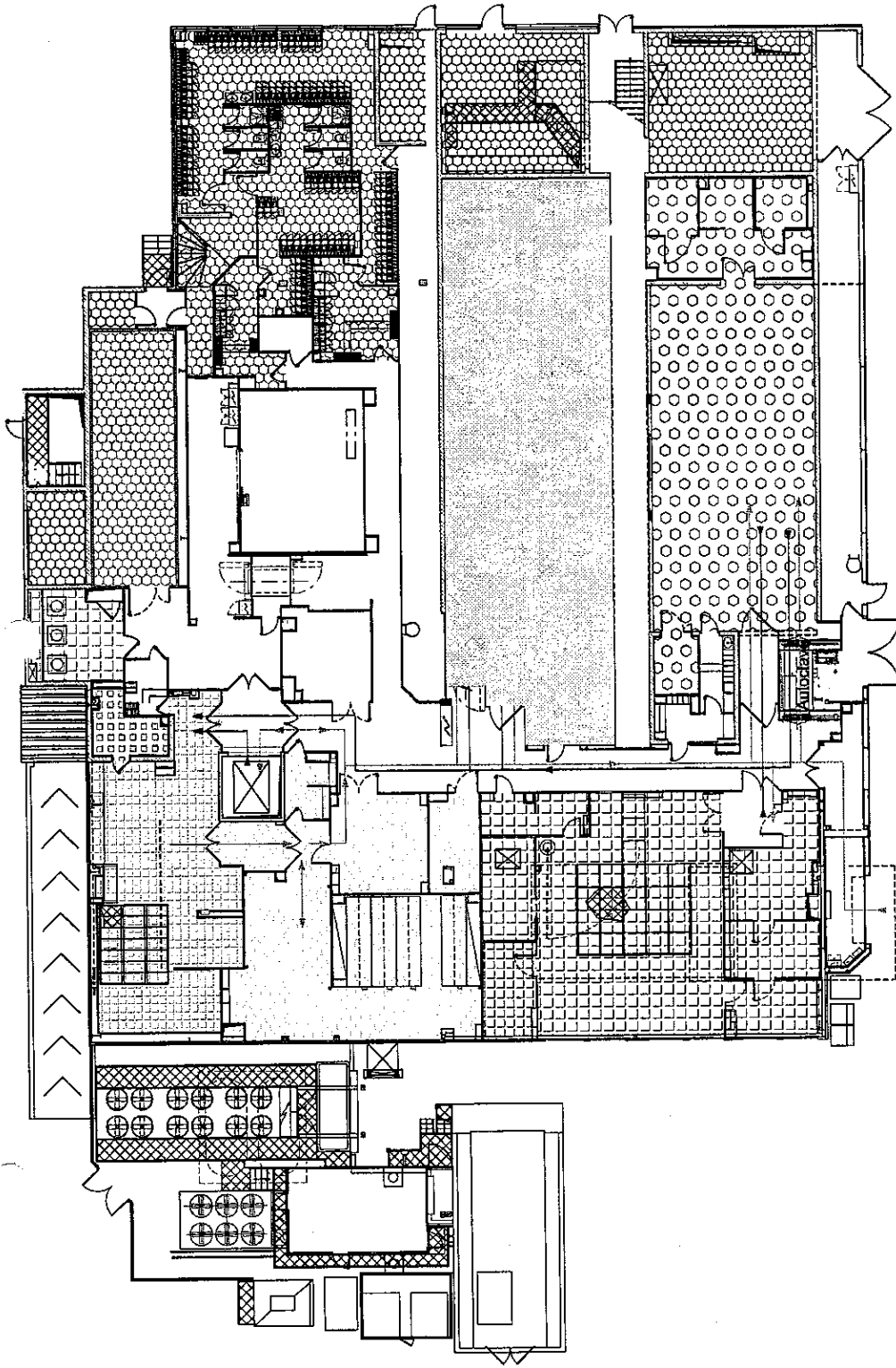

- Medium preparation area
- Offices
- Cold room
- Utilities
- Locker room
- Waste area
- Fermentation area
- Preparation area
- Washing area
- Preculture area
- Not applicable

Clean equipment
Soiled equipment

ROXANA MONTEMILONE
DIRECTOR
SANOFI PASTEUR S.A.

CHRISTIAN DOMÍNGUEZ
APODERADO
SANOFI PASTEUR S.A.

Modification	DATE	DESIGNER	FUNCTION	DATE - HOUR	REASON
1.15	20 April 2009				
0.1	16 October 2008				
Vers. L	16 October 2008				
SOLE					

Building : **V4** Sub-Building : **1** Class : **Master TQC BPF**

Discipline : **F Flux** Sub-Discipline : **.900 Flow-Control** Sheet Type : **.PL Plan view**

Sub-Disc-Cat : **MAT** Equipment

Description : **Equipment flow for Diphtheria**

Layout Name : **04-MAT-A3** Scale : **1/200**

Drawing ID : **DRWFR_00010728**

File Name : **V4_F900_1_PL05**

sanofi pasteur
La division vaccine du Groupe sanofi-aventis.

BUREAU D'ETUDES
CAMPUS NERELUX 152-A, NEREL NERELUX
89280 BARRIS-LE-TONC

Tel : 04 37 37 01 00
Fax : 04 37 37 39 01

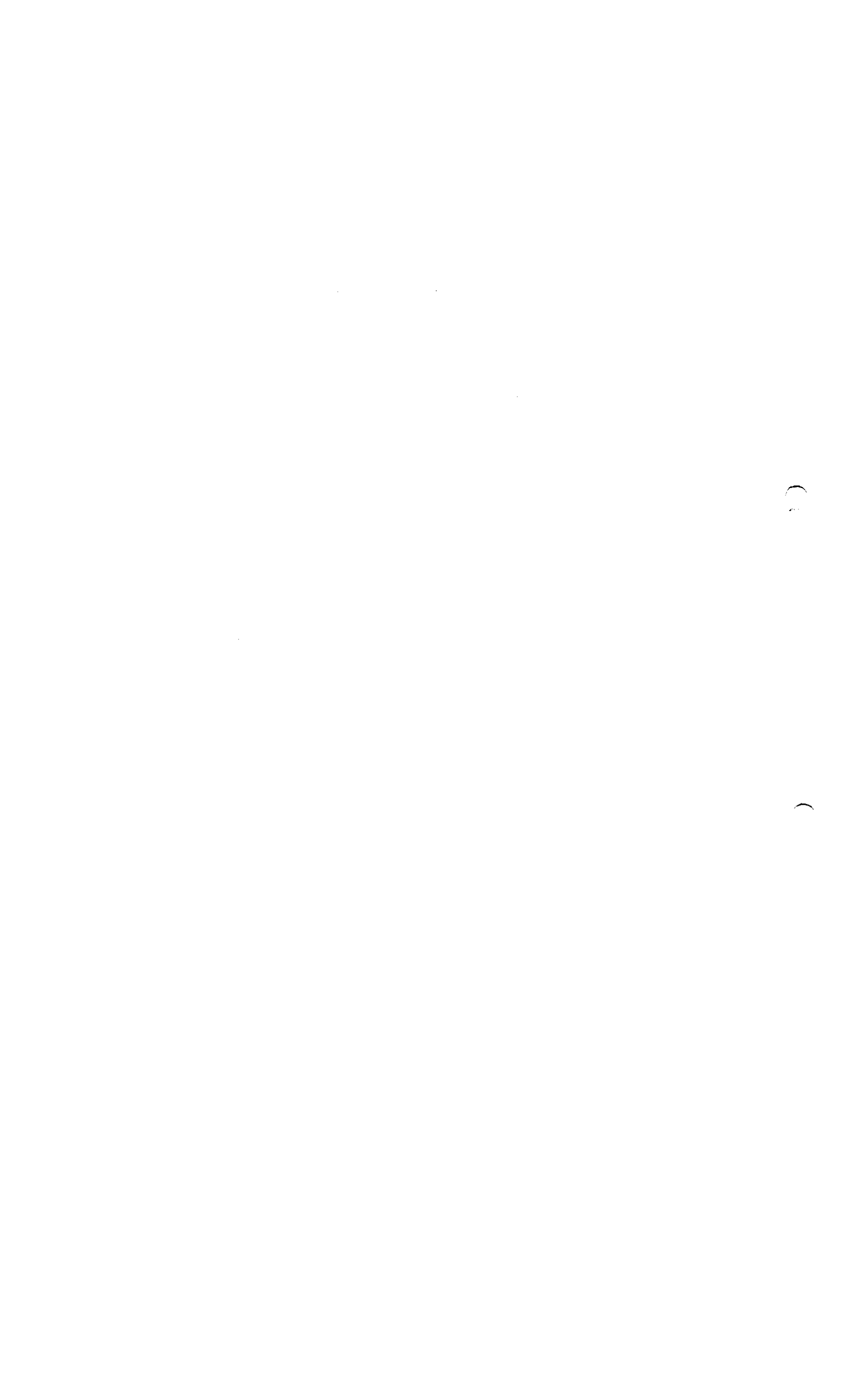

AN.M.A.T.





3.2.A.1

Waste Flow - Crude Diphtheria Toxoid - Building V4 - Level 0

	
ROXANA MONTEMILONE	CHRISTIAN DOMINGUEZ
DIRECTORA TÉCNICA	APODERADO
SANOFI PASTEUR S.A.	SANOFI PASTEUR S.A.

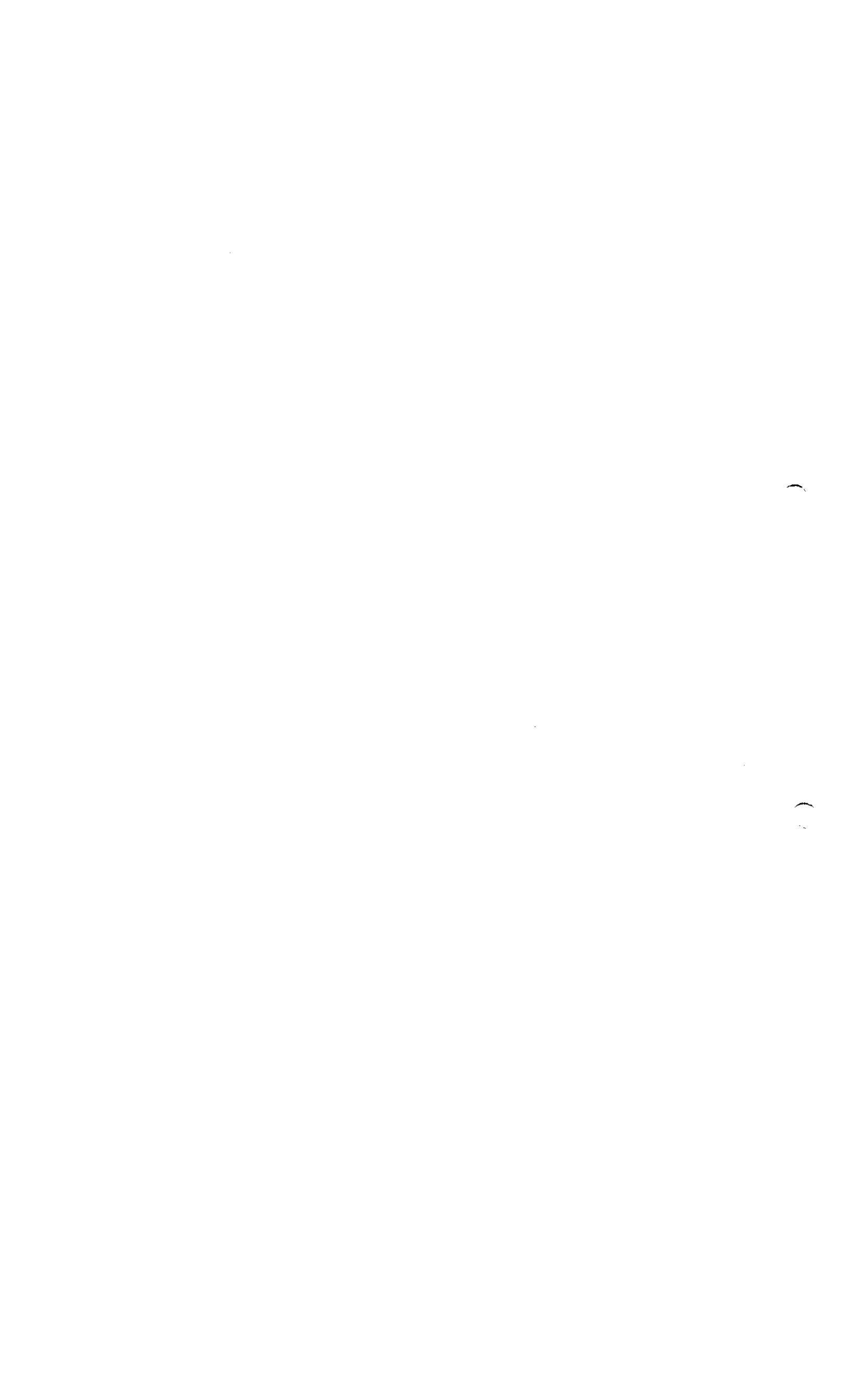

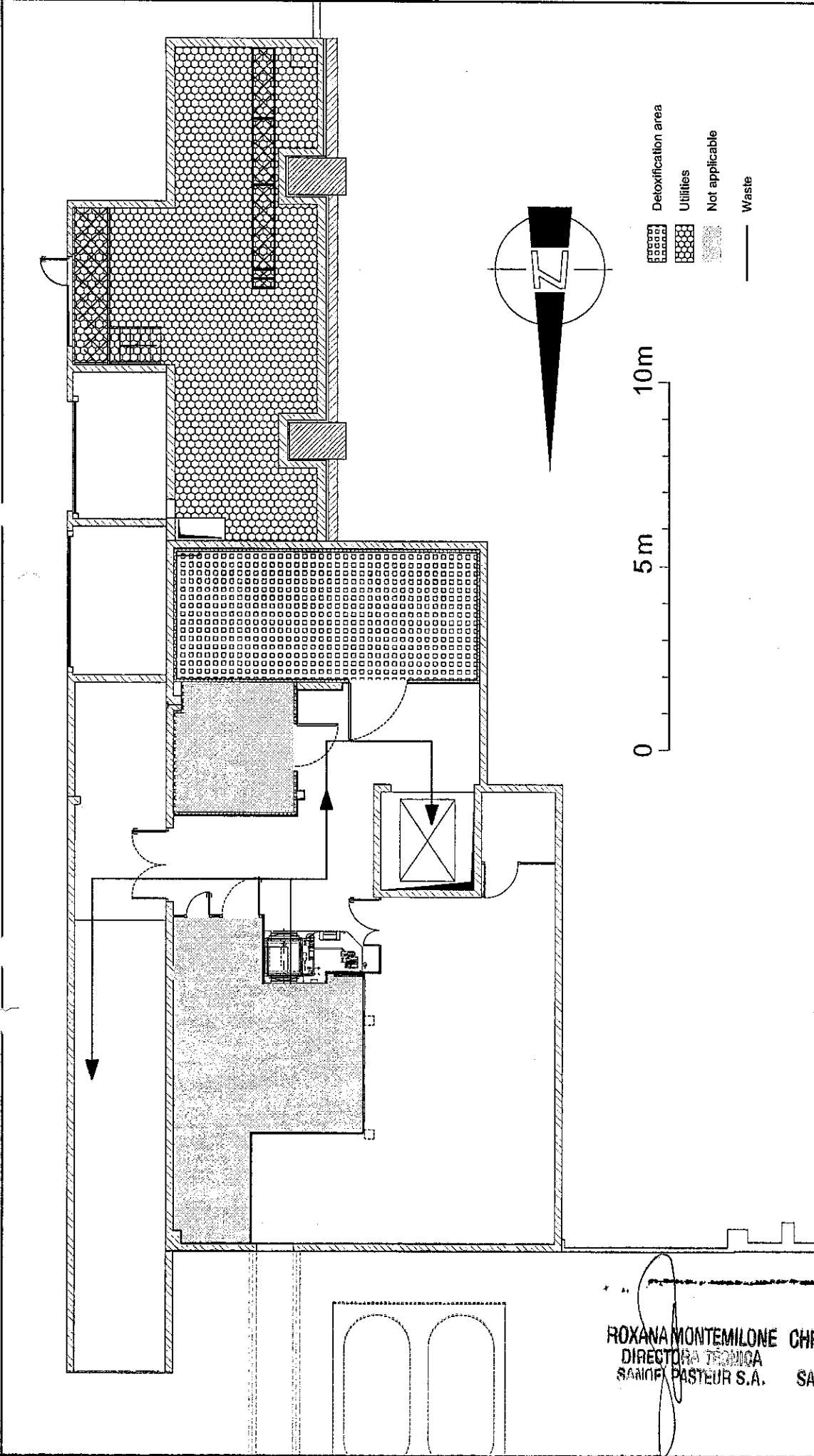

Building : **V4** Sub-Building : **0** Class : **Master TQC BPF**
 Discipline : **F** Flux Sub-Discipline : **900 Flow-Control** Sheet Type : **PL Plan View**
 Sub-Disc. - Cat : **.DECH Waste**
 Description : **Waste flow for Diptheria**
 Layout Name : **10-DECH-A3** Scale : **1/1000**
 Drawing ID : **DRWFR_00010725**
 File Name : **V4_F900_0_PL05**

sanofi pasteur
 La division vaccins du Groupe sanofi-saventis
 BUREAU D'ETUDES
 CAMPUS MERIEUX 1551, Av. Marcel MERIEUX
 69200 MARCY L'ETOILE
 Tel : 04 37 37 01 00
 Fax : 04 37 37 06 31

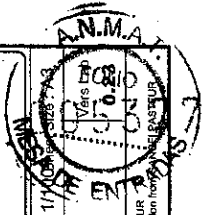

Modification	DATE	REASON	Design	Design verifier	Design	Design verifier	Design	Design verifier
0.23	19 Apr 2005							
0.1								
Vers. L Date C ROLE :								

ROXANA MONTEMILONE DIRECTORA TECNICA SANOFI PASTEUR S.A.
 CHRISTIAN DOMINGUEZ APODERADO SANOFI PASTEUR S.A.



3.2.A.1

Waste Flow - Crude Diphtheria Diphtheria Toxoid - Building V4 - Level 1

ROXANA MONTEMILONE DIRECTORA TÉCNICA
SANOFI PASTEUR S.A.

CHRISTIAN DOMINGUEZ APODERADO
SANOFI PASTEUR S.A.

10

11

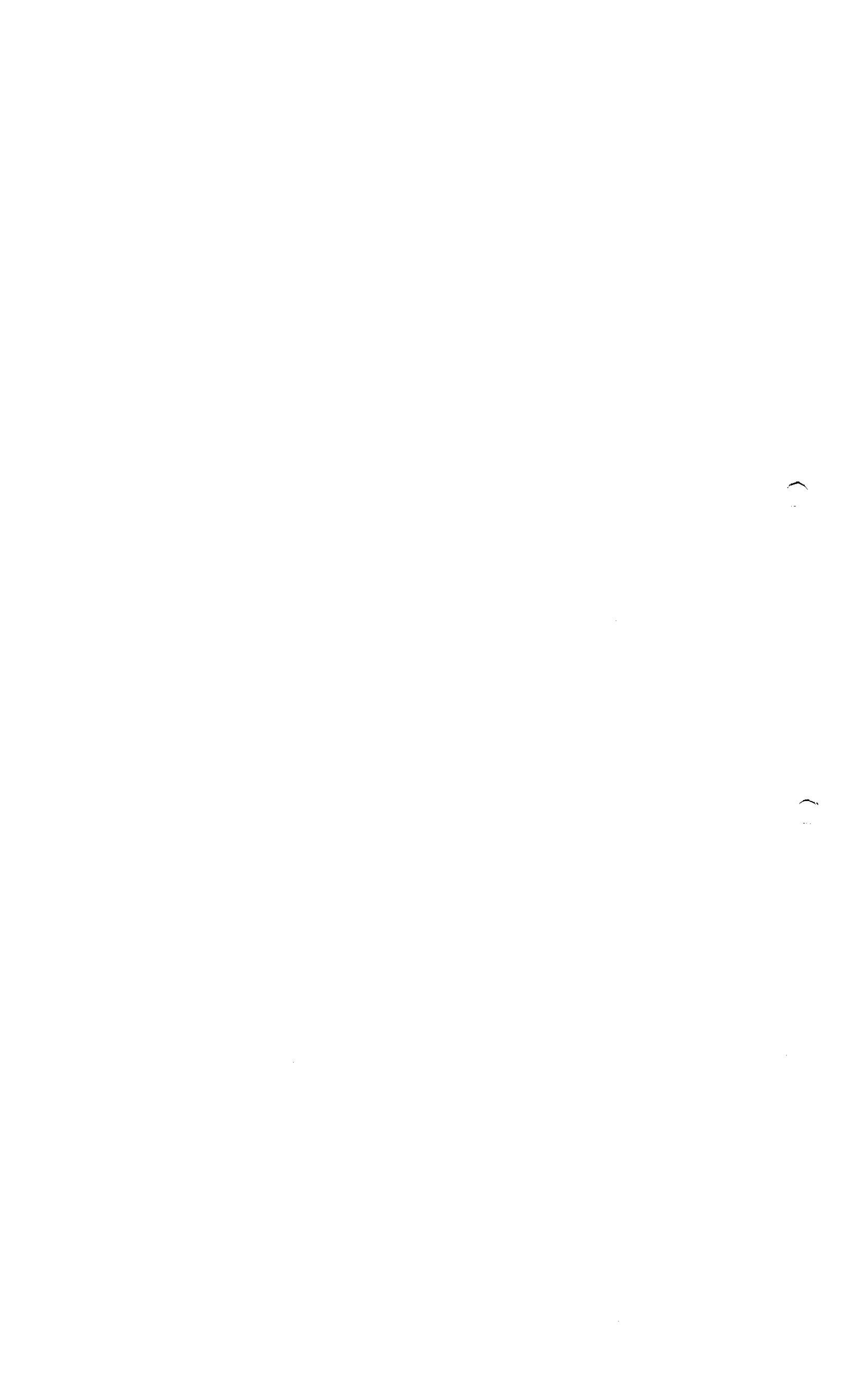



3.2.A.1

Department Allocation Plan - Building V14 - Level 2

ROXANA MONTEMILONE
DIRECTORA TÉCNICA
SANOFI PASTEUR S.A.

CHRISTIAN DOMINGUEZ
APODERADO
SANOFI PASTEUR S.A.





3.2.A.1

Purified Tetanus Protein Product Flow - Building V 14 - Level 2

ROXANA MONTEMILONE
DIRECTORA TÉCNICA
SANOFI PASTEUR S.A.



CHRISTIAN DOMINGUEZ
APODERADO
SANOFI PASTEUR S.A.

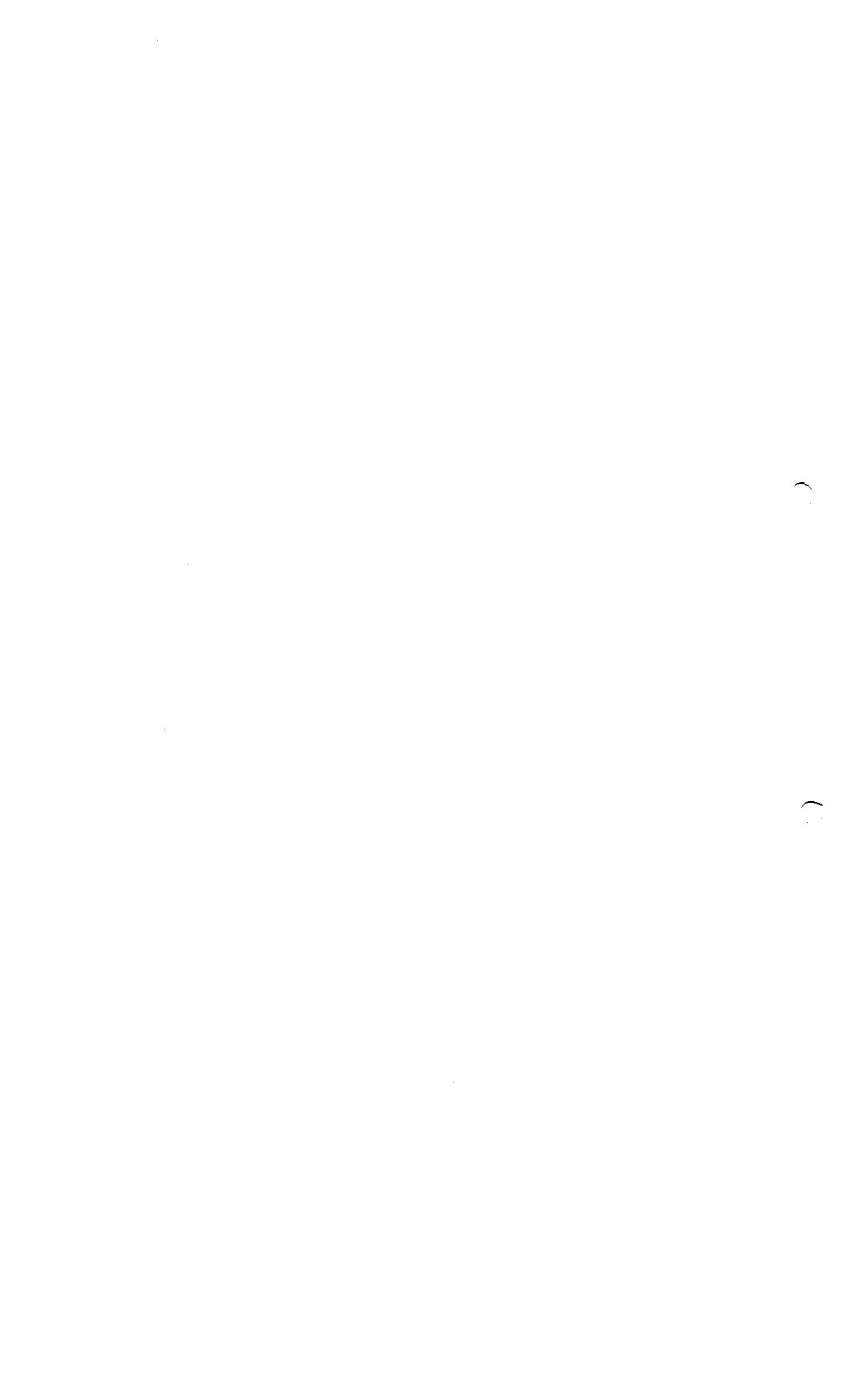



3.2.A.1

Personnel Flow - Purified Tetanus Protein - Building V14 - Level 2

ROXANA MONTEMILONE DIRECTORA TÉCNICA
SANOFI PASTEUR S.A.

CHRISTIAN DOMÍNGUEZ APODERADO
SANOFI PASTEUR S.A.

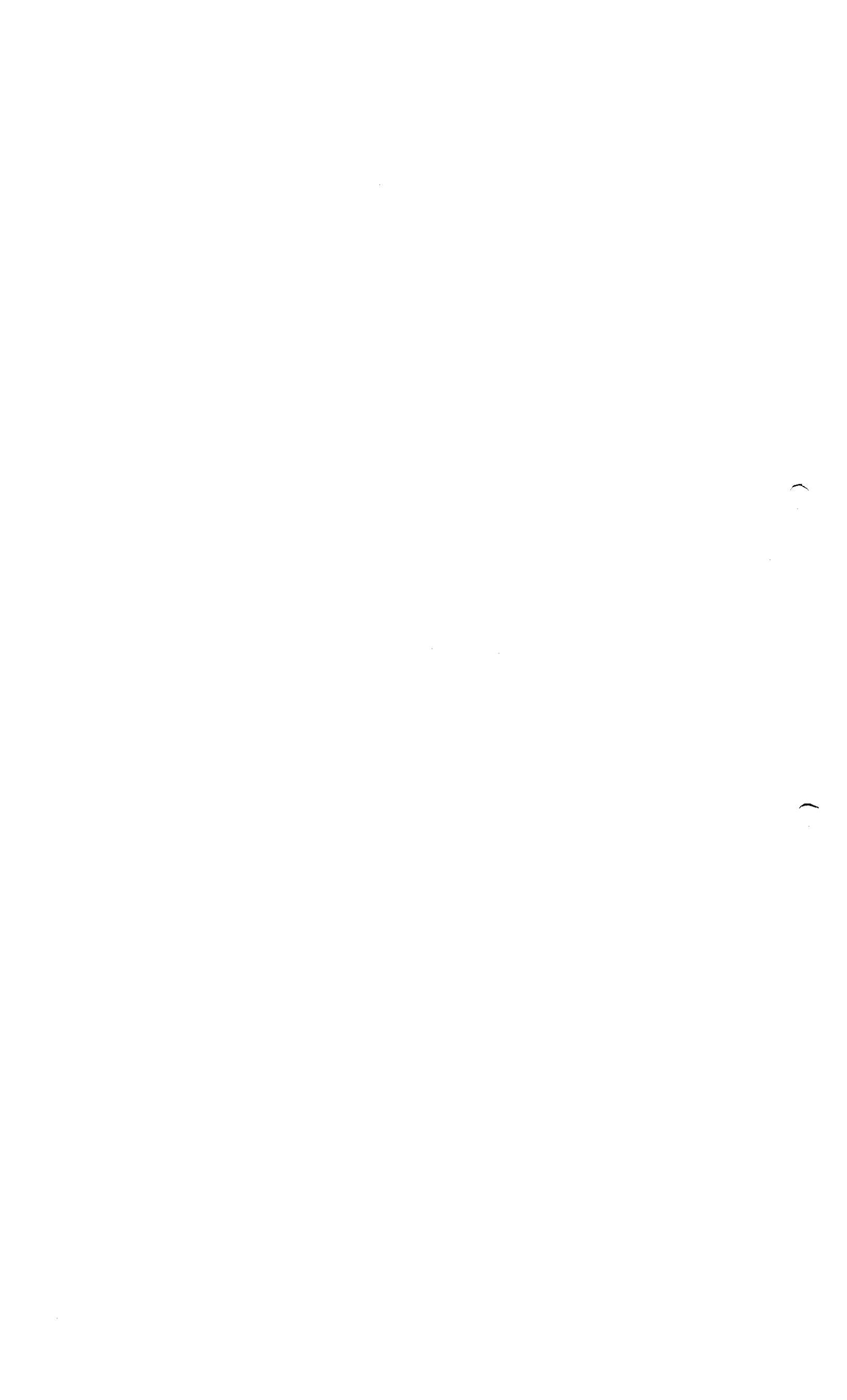

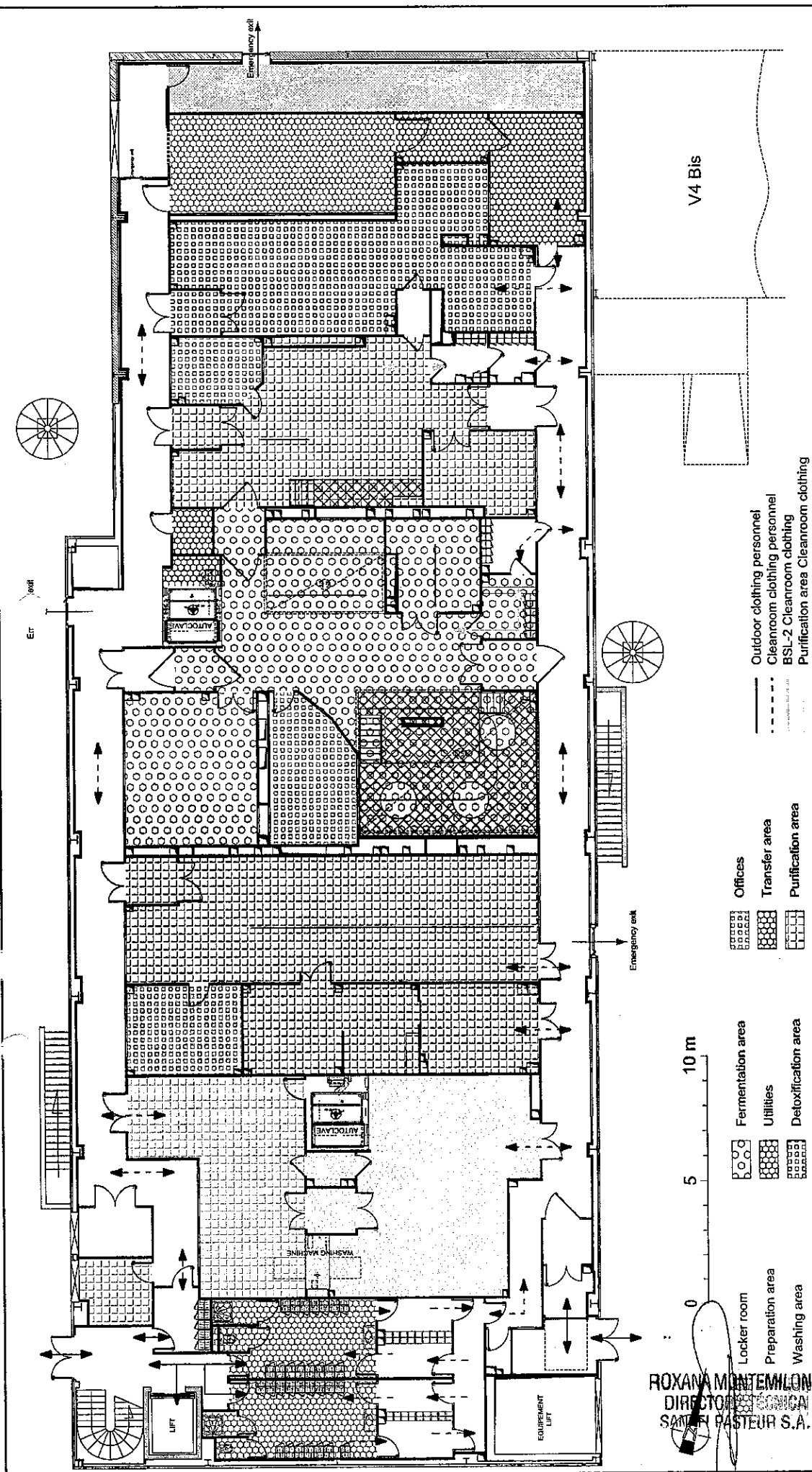

V4 Bis

- Outdoor clothing personnel
- Cleanroom clothing personnel
- BSL-2 Cleanroom clothing
- Purification area
- Cleanroom clothing

- Offices
- Transfer area
- Purification area
- Not applicable

- Fermentation area
- Utilities
- Detoxification area
- Cold room
- Waste area

- Locker room
- Preparation area
- Washing area
- Medium preparation area
- Preculture area

10 m

5

0

Building : **V14** Sub-Building : **F Flux** Floor : **2** Class : **Master TQC BPF**
 Discipline : **F Flux** Sub-Discipline : **900 Flow-Control** Sheet Type : **.PL Plan View**

Sub-Dis-Cat : **.PER Personal** Description : **Personnel flow for Haemophilus influenzae type b**

Layout Name : **07-PER-A3** Scale : **1/150**

Drawing ID : **DRWFR_00010586**
 File Name : **V14_F900_2_PL07**

sanofi pasteur
 La division vaccins du Groupe sanofi-aventis.

BUREAU D'ETUDES
 CAMPUS MERIEUX 1641, Av. Marcellin MERIEUX
 93280 MARYSE L'ETOILE
 TEL : 04 37 37 01 00
 FAX : 04 37 37 39 51

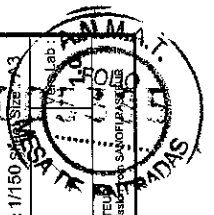

Modification	Approbation	Validation	TARASSIOUX Igor	15 Oct 2010
1.0	Approuvé	Approuvé	Destinateur	Date Appr
0.1	Approuvé	Approuvé	DATE - HEURE :	RAISON :
N° vers. :		Resp Affaire	Concepteur	
NOM :		FONCTION :		
CHAMBERY Celline				

ROXANA MONTEMLON DIRECTOR TECHNICAL SANOFI PASTEUR S.A.
 CHRISTOPHER DOMINGUEZ APPELADO SANOFI PASTEUR S.A.

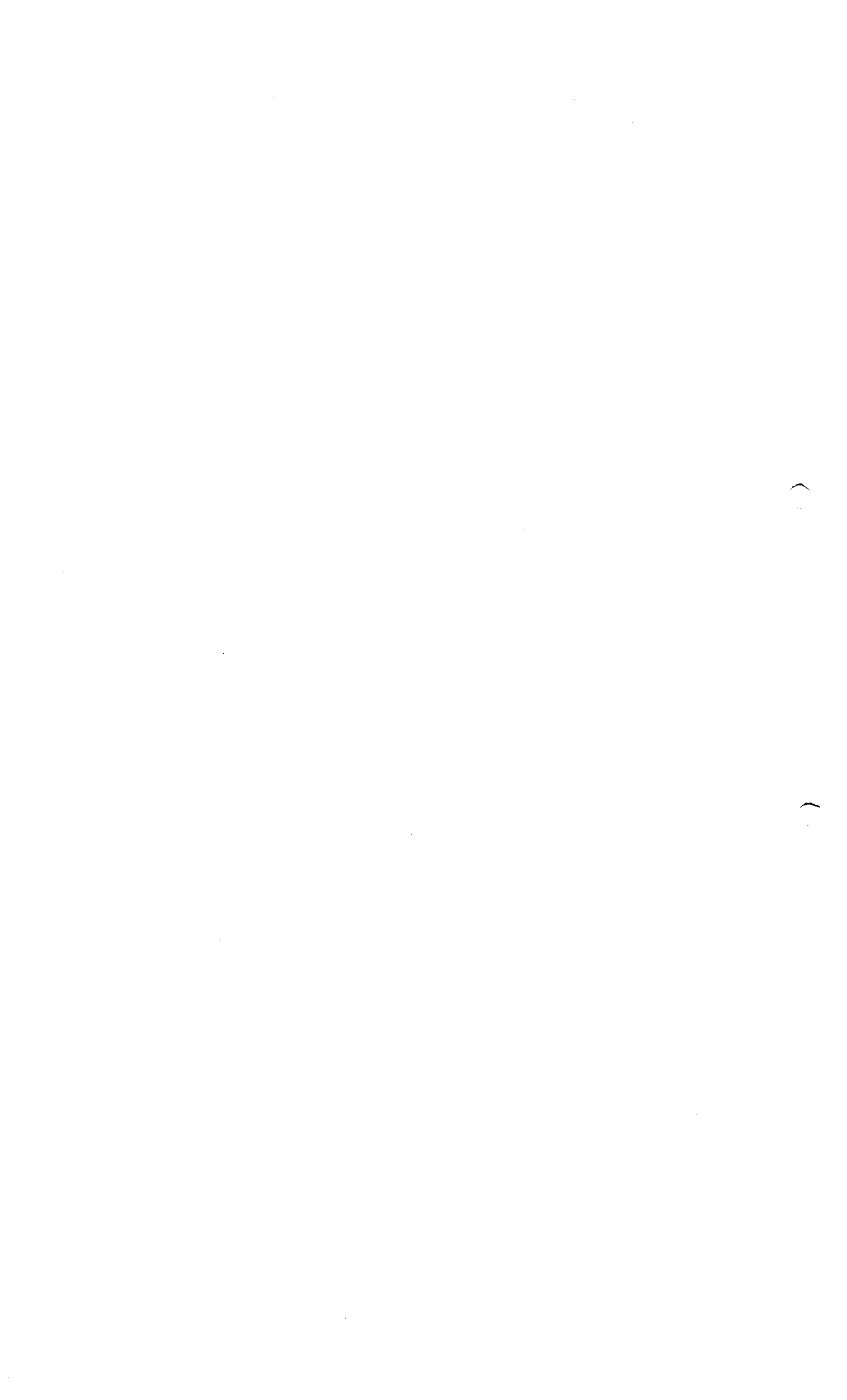



3.2.A.1

**Clean and Soiled Equipment Flow - Purified Tetanus Protein - Building V14 -
Level 2**

ROXANA MONTEMILONE
DIRECTOR TÉCNICA
SANOFI PASTEUR S.A.

CHRISTIAN DOMINGUEZ
APODERADO
SANOFI PASTEUR S.A.

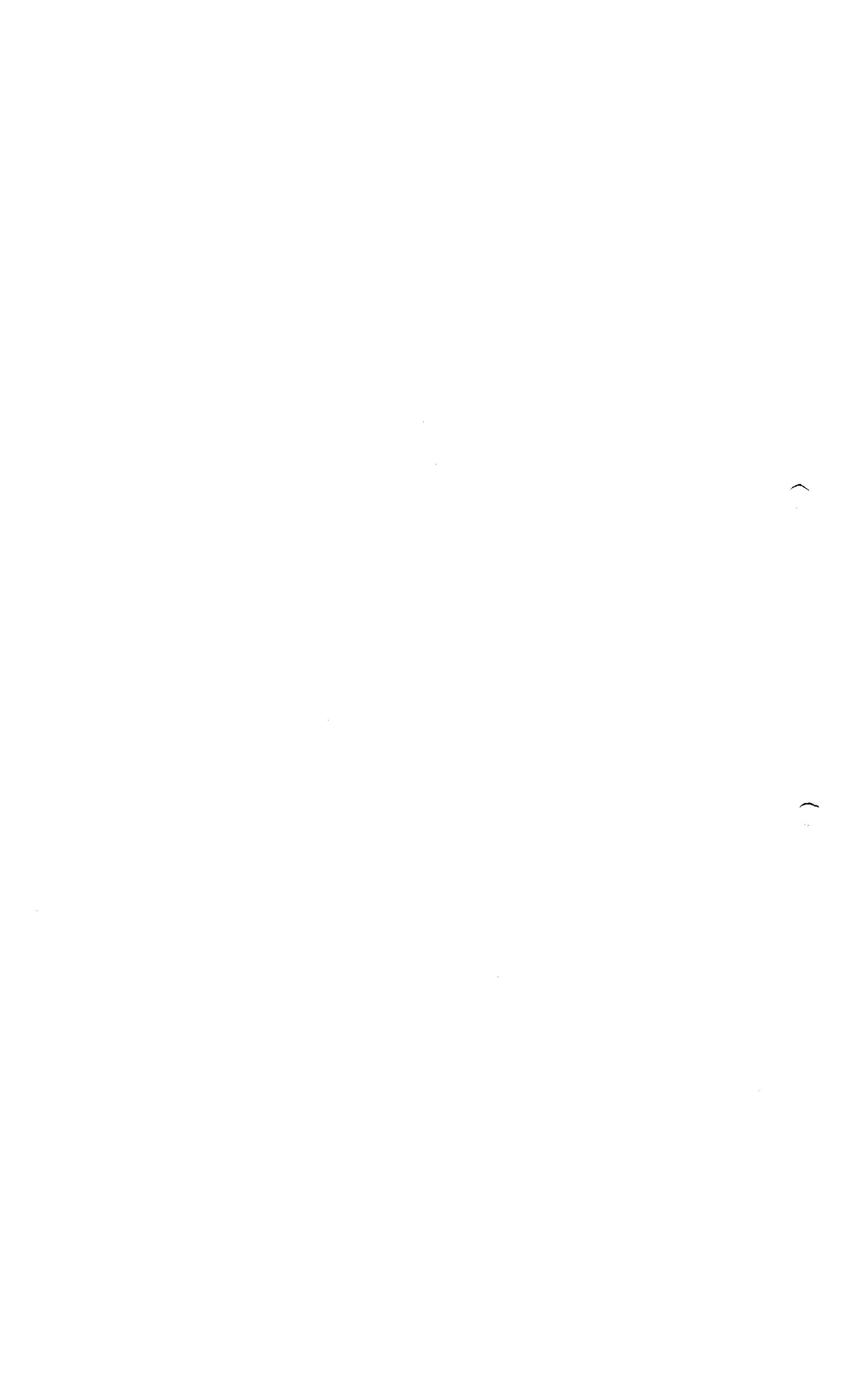

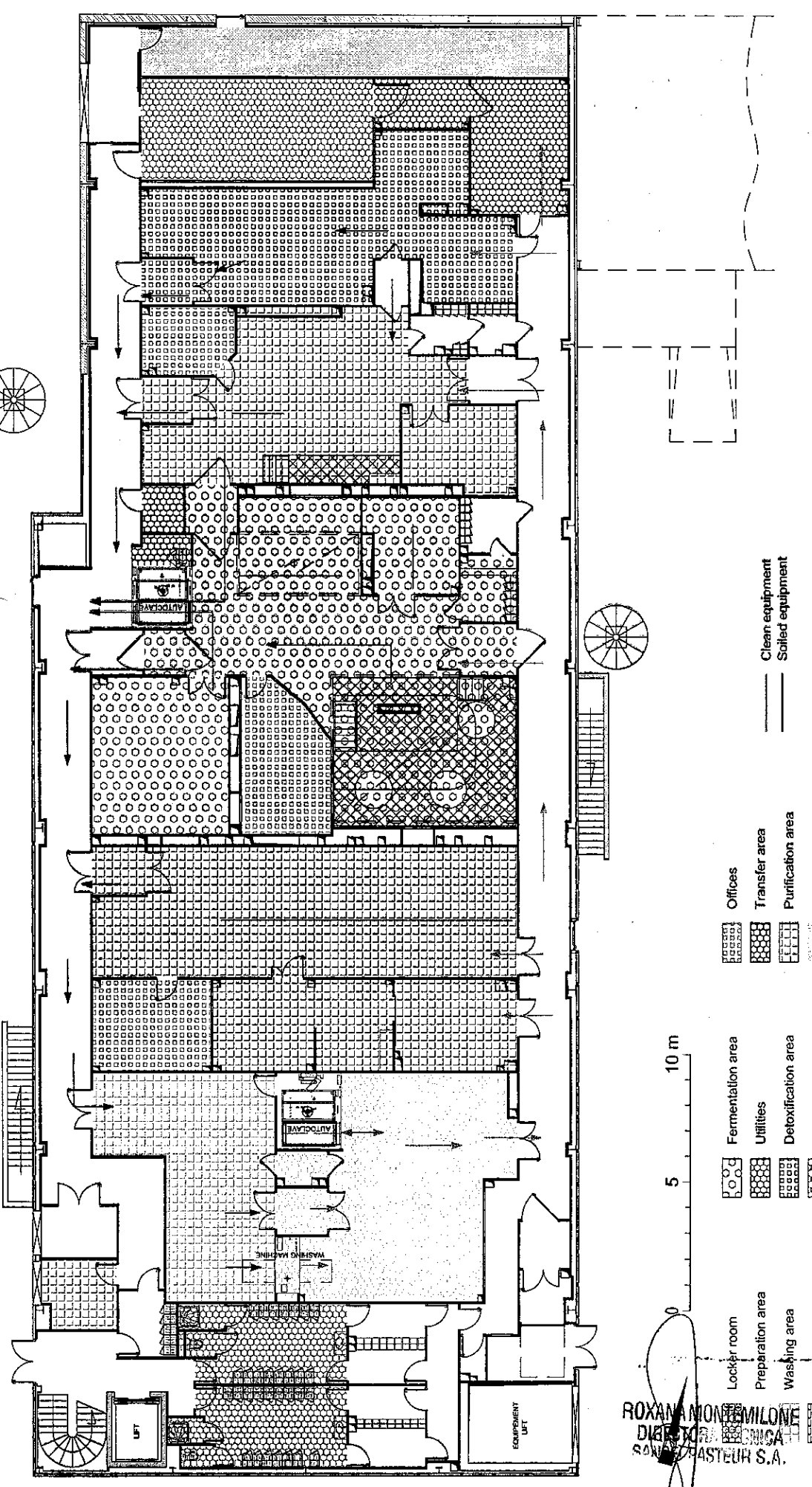
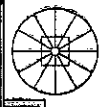
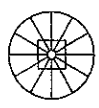

- Locker room
- Preparation area
- Washing area
- Medium preparation area
- Pre-culture area
- Fermentation area
- Utilities
- Detoxification area
- Cold room
- Waste area
- Offices
- Transfer area
- Purification area
- Not applicable

— Clean equipment
 - - - Soiled equipment

Building: **V14** Sub-Building: **F** Flux
 Discipline: **F** Sub-Discipline: **900** Flow-Control
 Floor: **2** Class: **Master TQC BPF**
 Sheet Type: **.PL** Plan View

Layout Name: **09-MAT-A3** Scale: 1/150 Sheet Size: **A3**
 Drawing ID: **DRWFR_00010586**
 File Name: **V14_F900_2_PL07**
 Description: **Equipment flow for Tetanus for Haemophilus influenzae type b**
 Sub-Discipline: **.MAT** Equipment

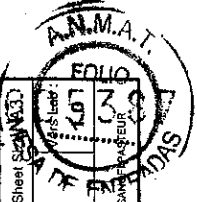

sanofi pasteur

La division vaccins de Geopage sanofi-aventis.

BUREAU D'ETUDES:
 CAMPUS MERIEUX 15411, Av. Marcellin MERIEUX
 92000 MARYVIEUX FRANCE
 Tel : 01 37 37 41 00
 Fax : 01 37 37 39 51

ROXANA MONTMILONE
 DIRECTRICE TECHNIQUE
 SANOFI PASTEUR S.A.

CHRISTIAN APONTE
 CHAMBERY Cellule
 SANOFI PASTEUR S.A.

Modification	Parassieux type	15 Oct 2010
1.0	Desinateur	Date Inactif
0.1	Concepteur	Date Appr
0.1	Resp. Affaire	DATE - HEURE :
RASON:		
FONCTION:		

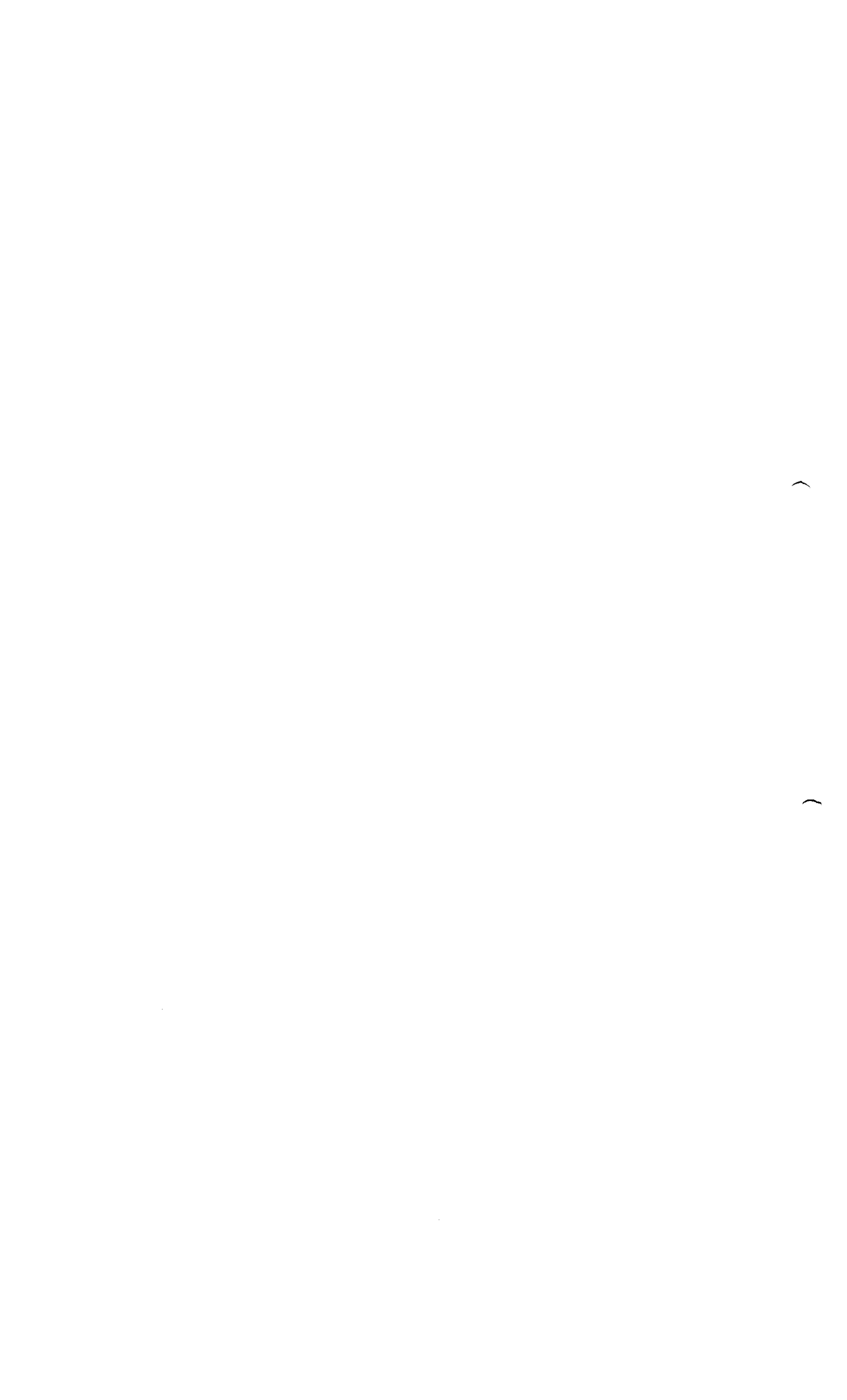



3.2.A.1

Waste Flow - Purified Tetanus Protein - Building V14 - Level 2

ROXANA MONTEMILONE
DIRECTORA TÉCNICA
SANGRE PASTEUR S.A.

CHRISTIAN DOMINGUEZ
APODERADO
SANGRE PASTEUR S.A.

