



	ID : SMF/CRNA	Version : 17.0	Date : 28/10/2012	Page 35 sur 41
	CRNA SITE MASTER FILE			

Accessed by: KOROGHLI Lydia

Access date: 09 juin 2016 10:51:35

ATTACHMENT Pest control in CRNA 1 and CRNA 2

CONFIDENTIAL

no reproduction or distribution without written approval

Document ID: RA_1354789
 Document Version: 1.0
 SANDRA MONTEMILONE
 DIRECTORA TECNICA
 APODERADA
 SANOFI PASTEUR S. A.

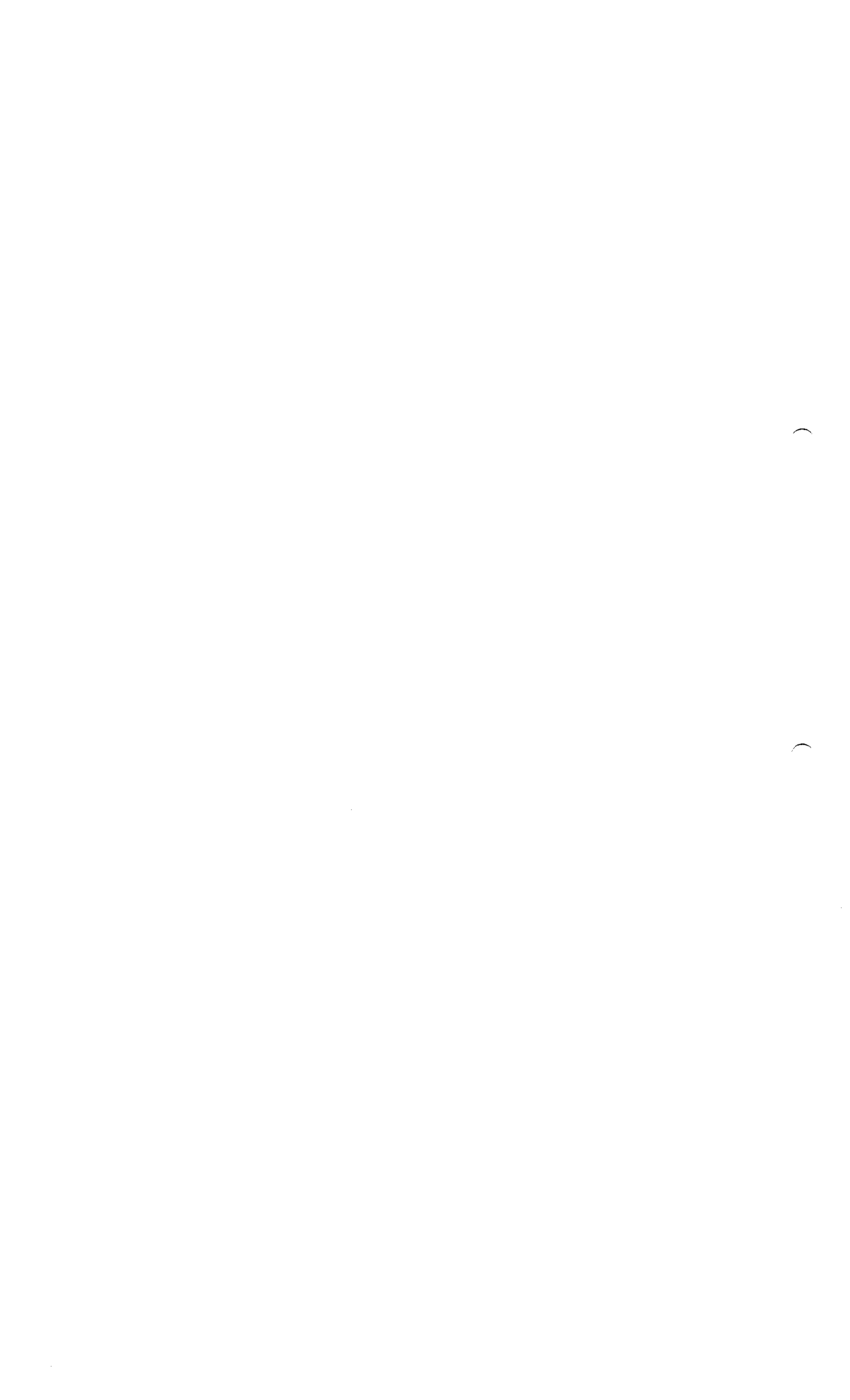



Lutte préventive contre les nuisibles (insectes rampants-rongeurs)

- Localisation des contenants d'appâts pour les rongeurs
- Localisation des zones à traiter contre les insectes rampants
- ⊙ Localisation des Insectes Detectors

Bâtiment CRNA 1 (niveau 0)

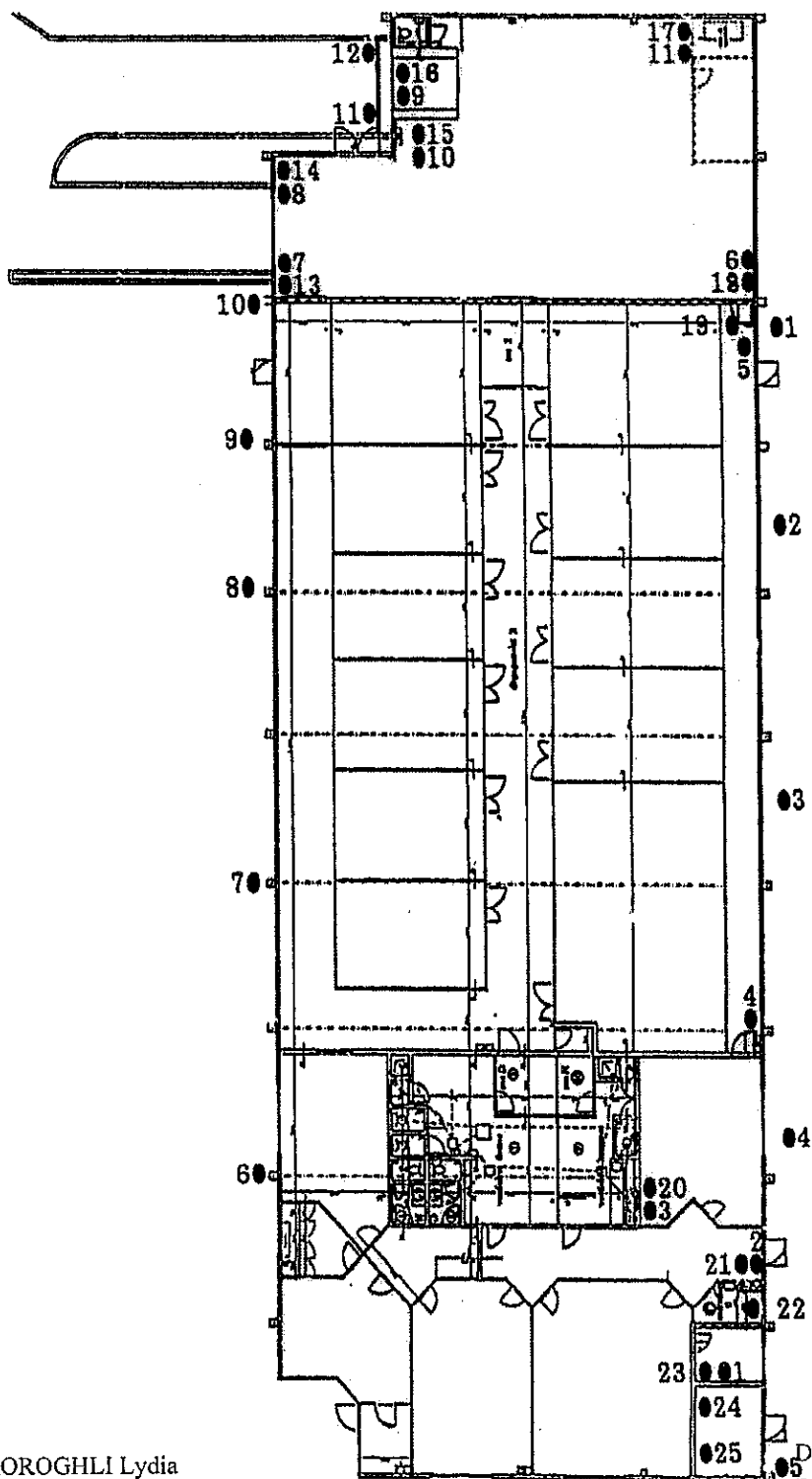

Accessed by: KOROGHLI Lydia

Access date: 09 juin 2016 10:51:35

Document ID: RA_1354789
Document Version: 01
OXANA MONTEMILONE
DIRECTORA TÉCNICA
APODERADA
SANOFI PASTEUR S. A.

HYGIENE CONTROL



CNRA
 Zoning Industriel d'Heppignies Ouest
 Avenue d'Heppignies 6220-FLEURUS

Lutte préventive contre les nuisibles (insectes rampants-rongeurs)

- Localisation des contenants d'appâts pour les rongeurs
- Localisation des zones à traiter contre les insectes rampants
- Localisation des Insect Detectors

Bâtiment CRNA 2

niveau 0

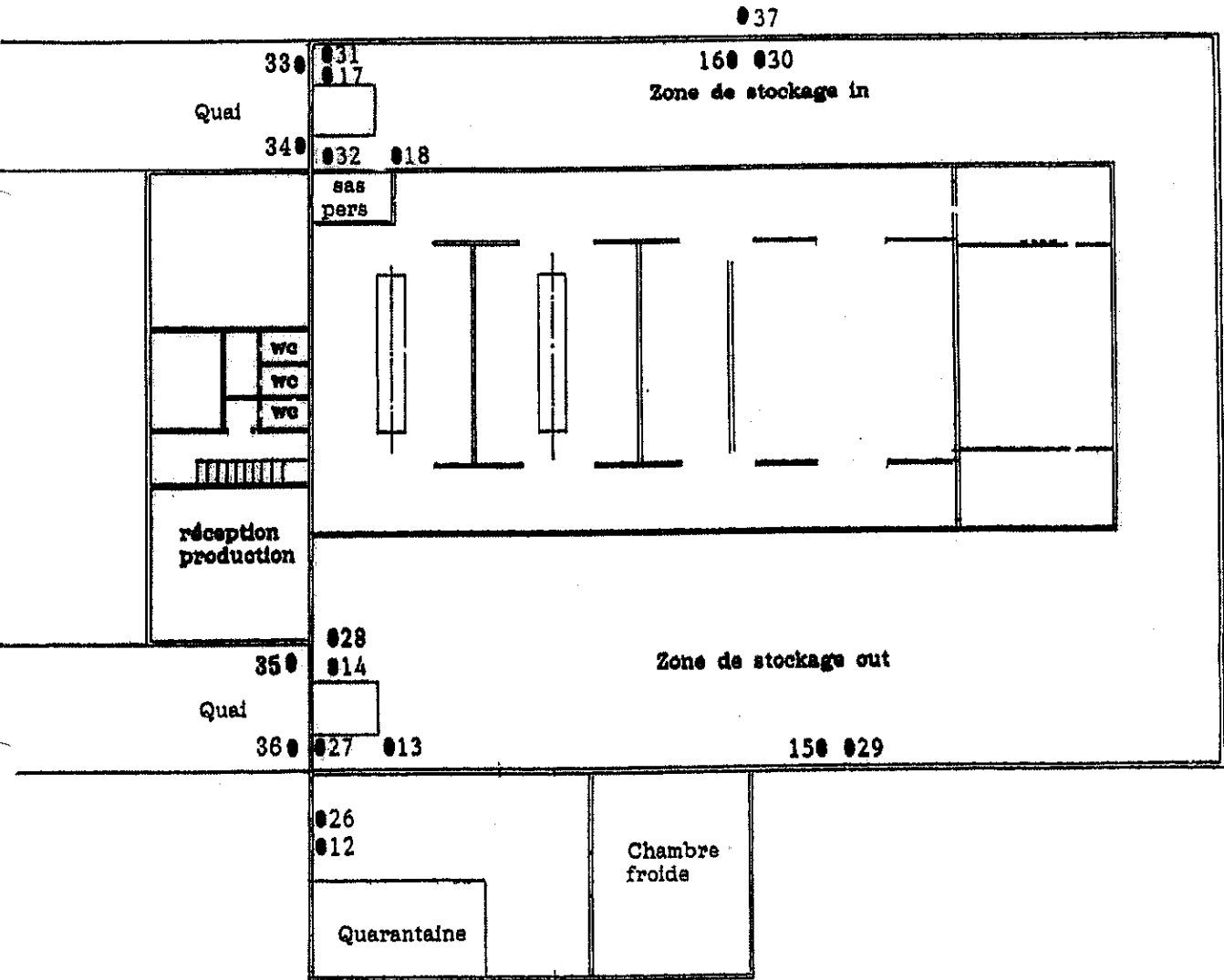

niveau +1

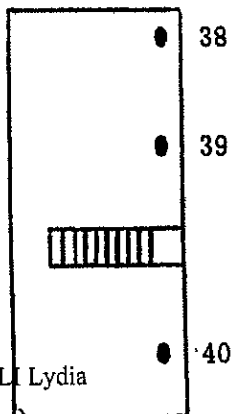

Accessed by: KOROGHLI Lydia

Access date: 09 juin 2016 10:51:35

Document ID: RA_1354789
 Document Version: 1.0
 MONTMILONE
 DIRECTORA TECNICA
 APODERADA
 SANOFI PASTEUR S. A.





	ID : SMF/CRNA	Version : 17.0	Date : 28/10/2012	Page 36 sur 41
CRNA SITE MASTER FILE				

Accessed by: KOROGHLI Lydia

Access date: 09 juin 2016 10:51:35

ATTACHMENT Pest control in CRNA 3

CONFIDENTIAL
no reproduction or distribution without written approval

Document ID: RA_1354789
Document Version: 1.0

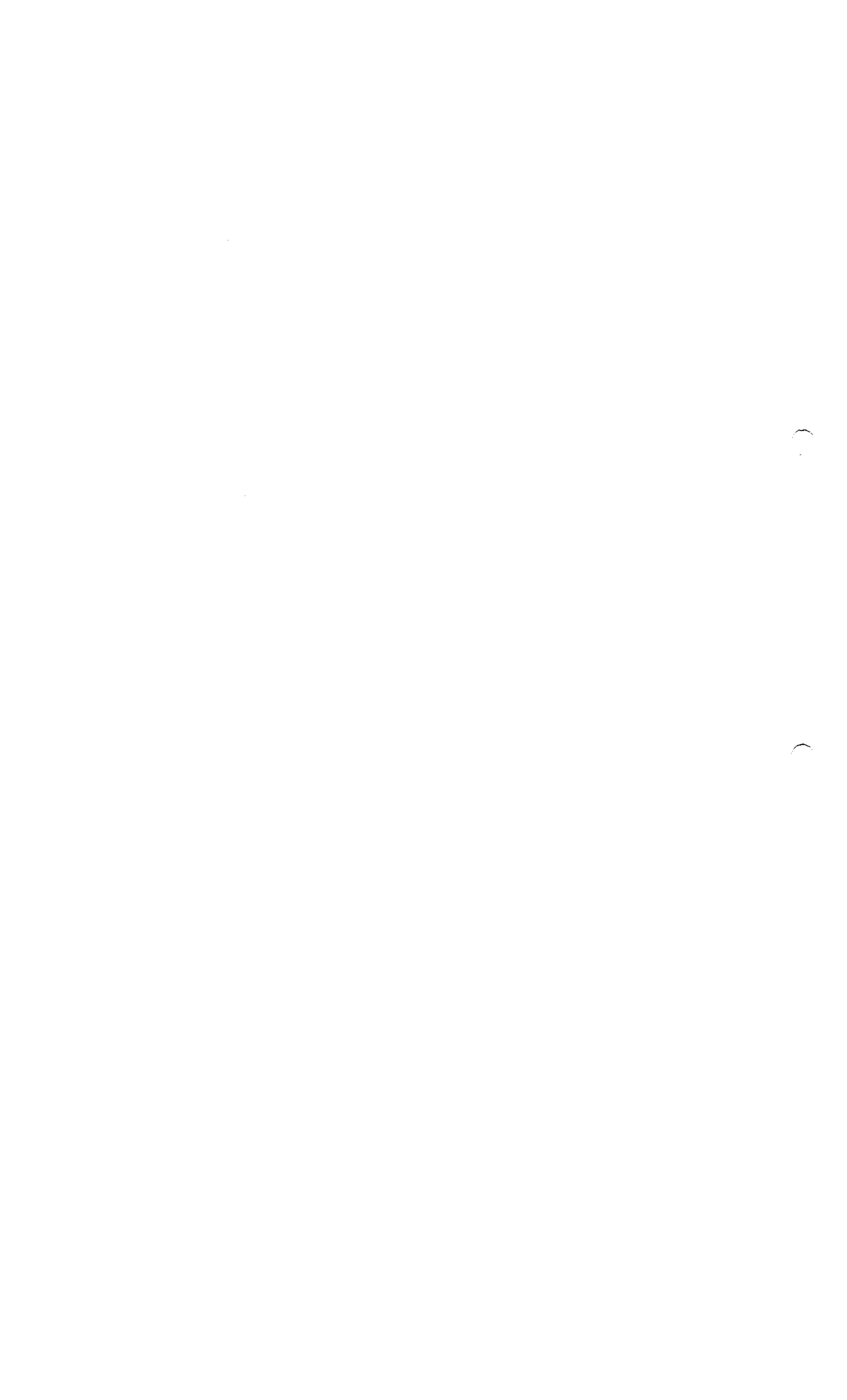
ROXANA MONTEMILONE
DIRECTORA TECNICA
APODERADA
SANOFI PASTEUR S. A.



CNRA
Zoning Industriel Heppignies Ouest
Avenue d'Heppignies 6220-FLEURUS

HYGIENE CONTROL



Lutte préventive contre les nuisibles (insectes rampants-rongeurs)

- Localisation des contenants d'appâts pour les rongeurs
- Localisation des zones à traiter contre les insectes rampants
- ⊙ Localisation des Insects Detectors

Bâtiment CRNA 3 (niveau 0)

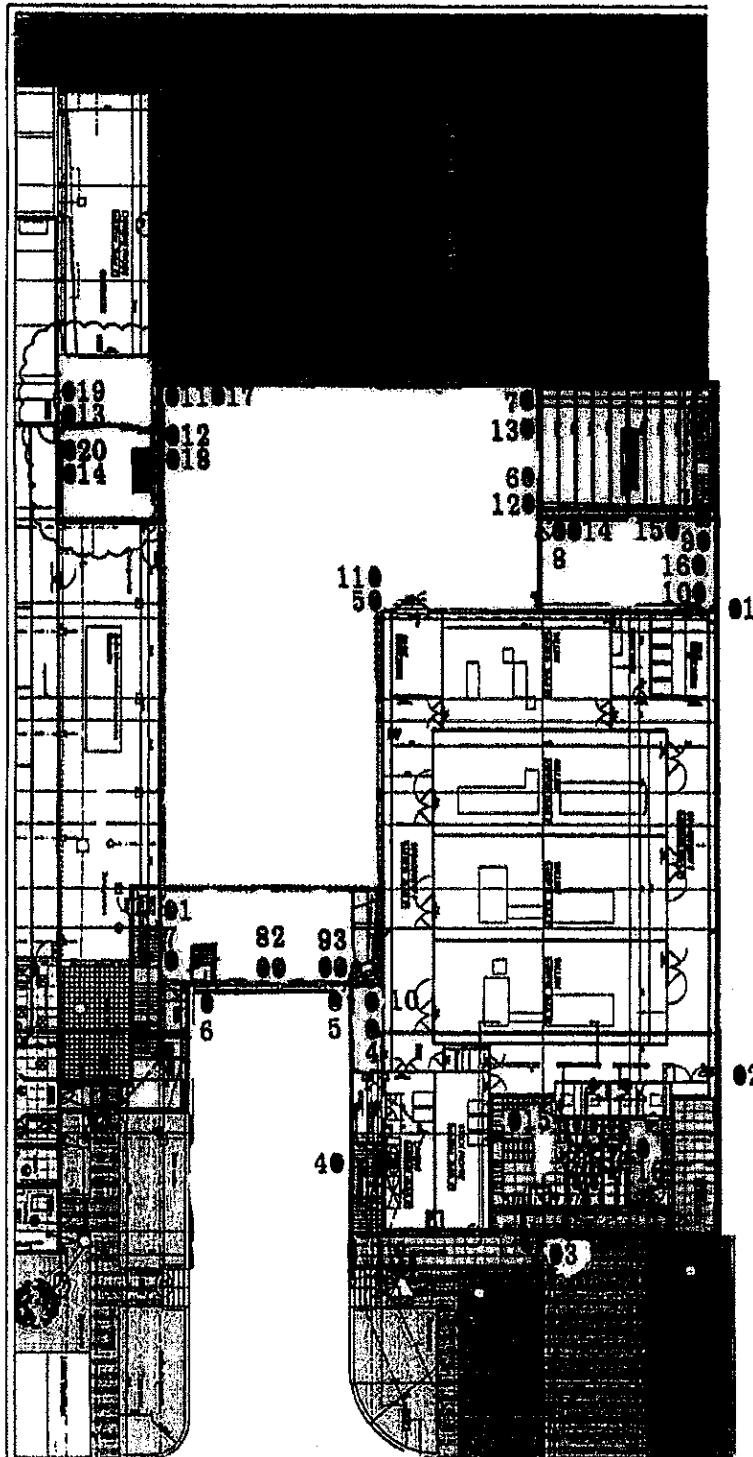

Accessed by: KOROGHLI Lydia

Access date: 09 juin 2016 10:51:35

Document ID: RA_1354789

Document Version: 1.0
ROXANA MONTEMILONE
DIRECTORA TECNICA
APODERADA
SANOFI PASTEUR S. A.



Lutte préventive contre les nuisibles (insectes rampants-rongeurs)

- Localisation des contenants d'appâts pour les rongeurs
- Localisation des zones à traiter contre les insectes rampants
- Localisation des Insects Detectors

Bâtiment CRNA 3 (niveau +1)

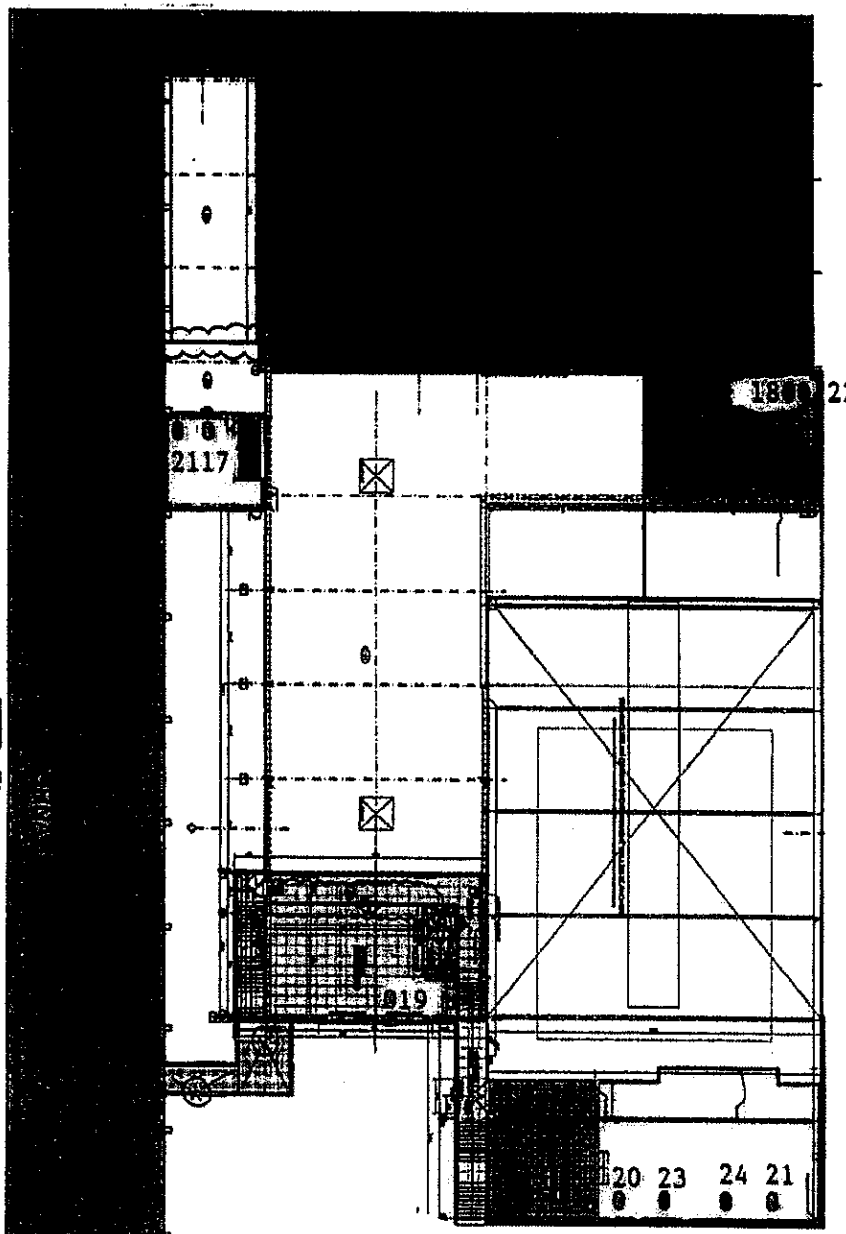

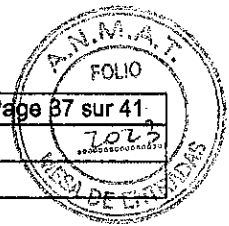

ATTACHMENT
Product Transformation Cycle

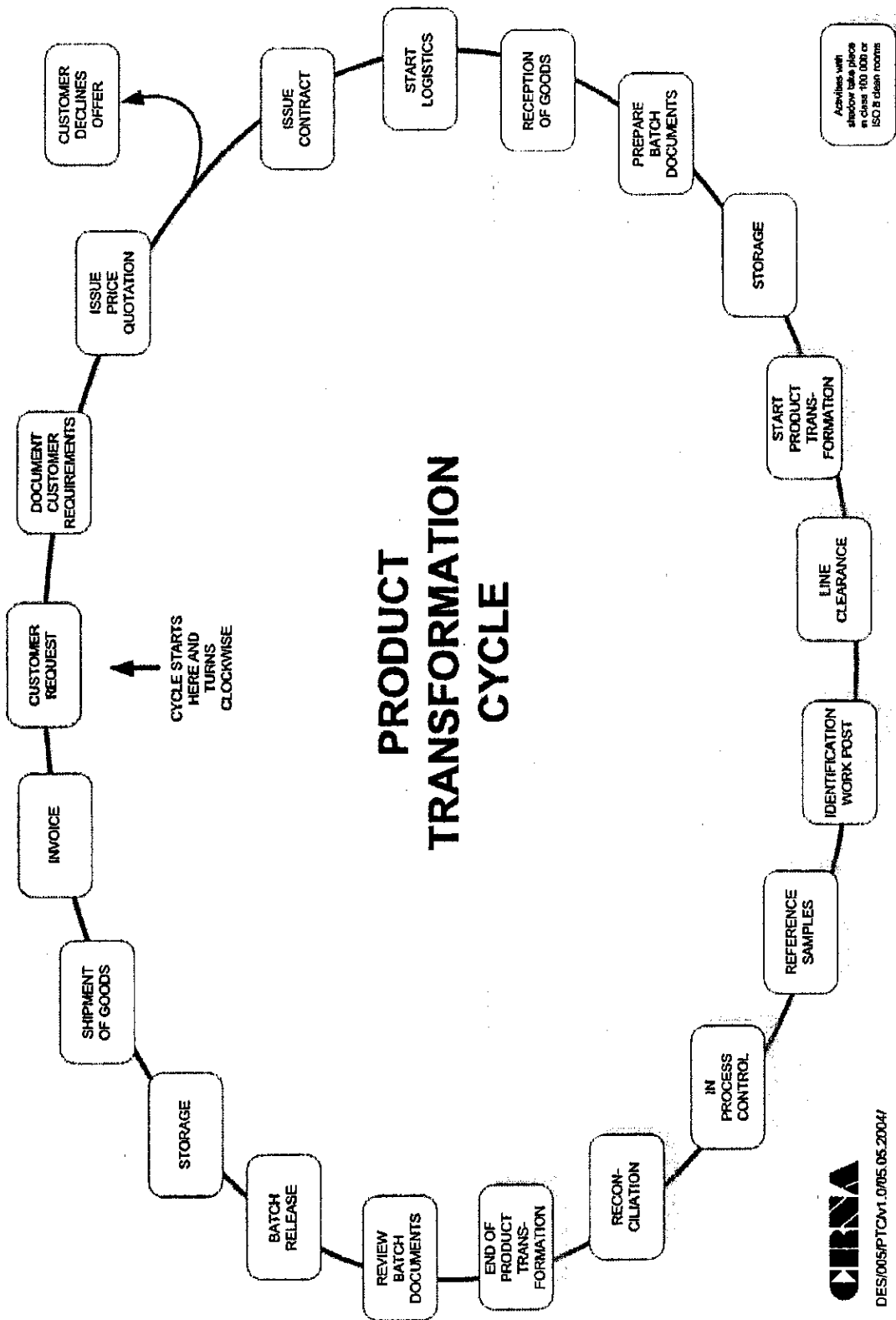

DES/005/PTCM/1.0/05.05.2004/

Accessed by: KOROGHLI Lydia

Access date: 09 juin 2016 10:51:35

CONFIDENTIAL
no reproduction or distribution without written approval

Document ID: RA_1354789

Document Version: 1.0

ROXANA MONTEMILONE
DIRECTORA TECNICA
APODERADA
SANOFI PASTEUR S. A.

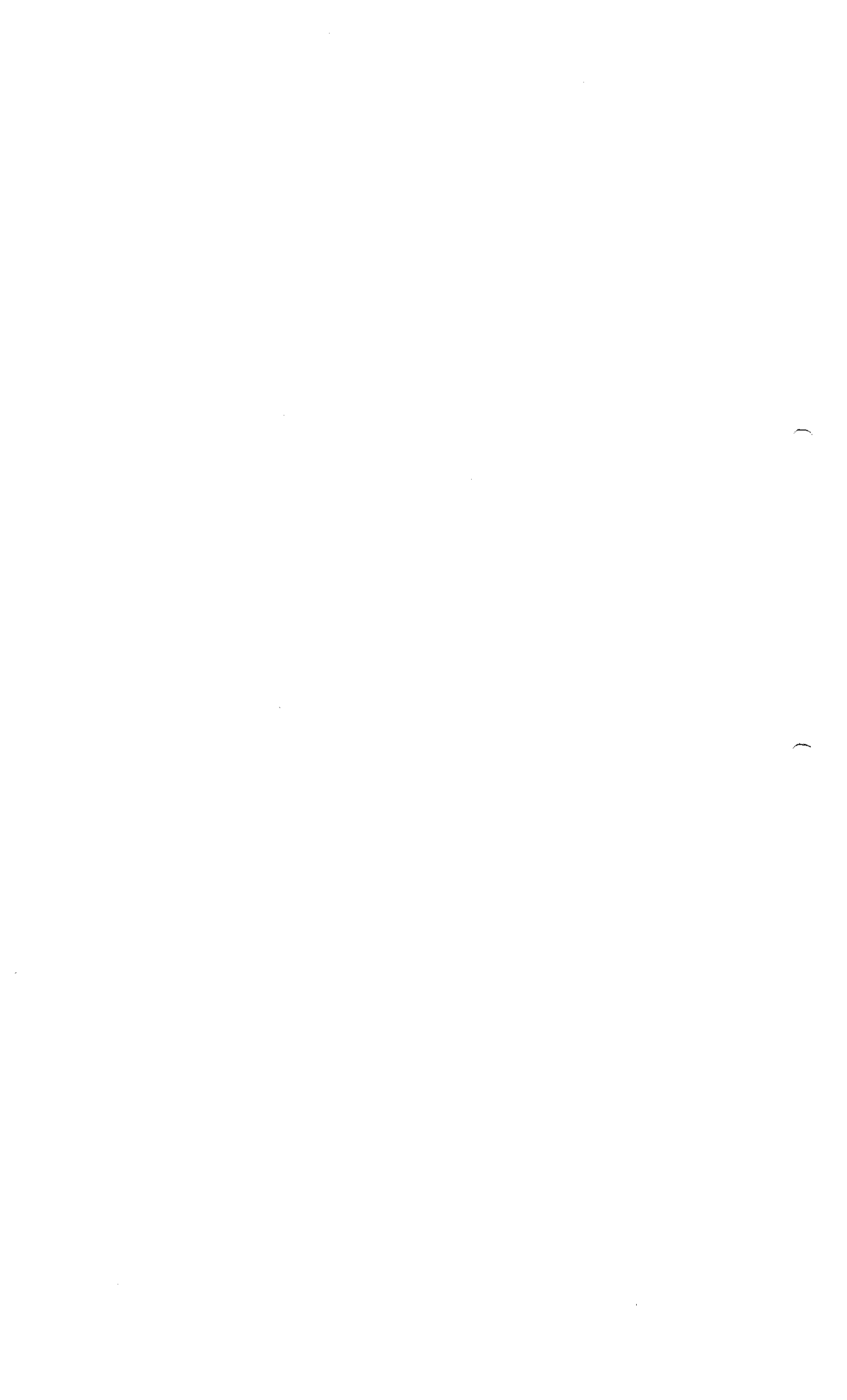

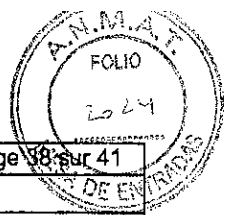

ATTACHMENT

**Support processes to the Product Transformation Cycle
(described in SOP's)**

Management of:

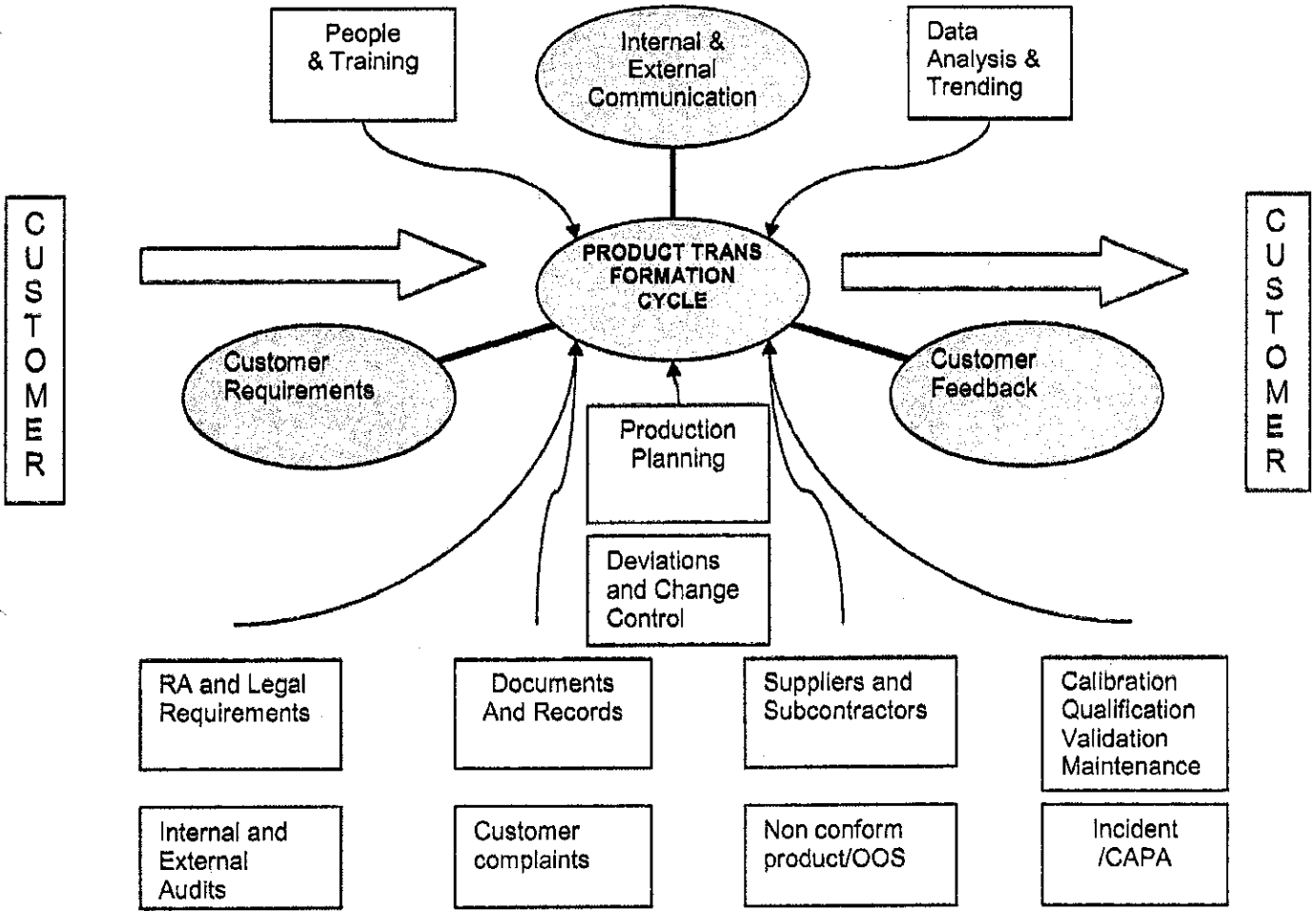

Accessed by: KOROGHLI Lydia

Access date: 09 juin 2016 10:51:35

CONFIDENTIAL
no reproduction or distribution without written approval

Document ID: RA_136078
Document Version: 1.0
ANNA MONTEMILONE
DIRECTORA TECNICA
APODERADA
SANOFI PASTEUR S. A.

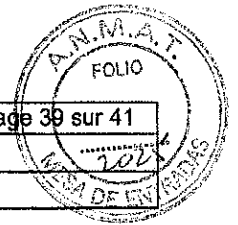

Attachment : Packaging and Controls flow chart for secondary packaging in Zone C of CRNA 2

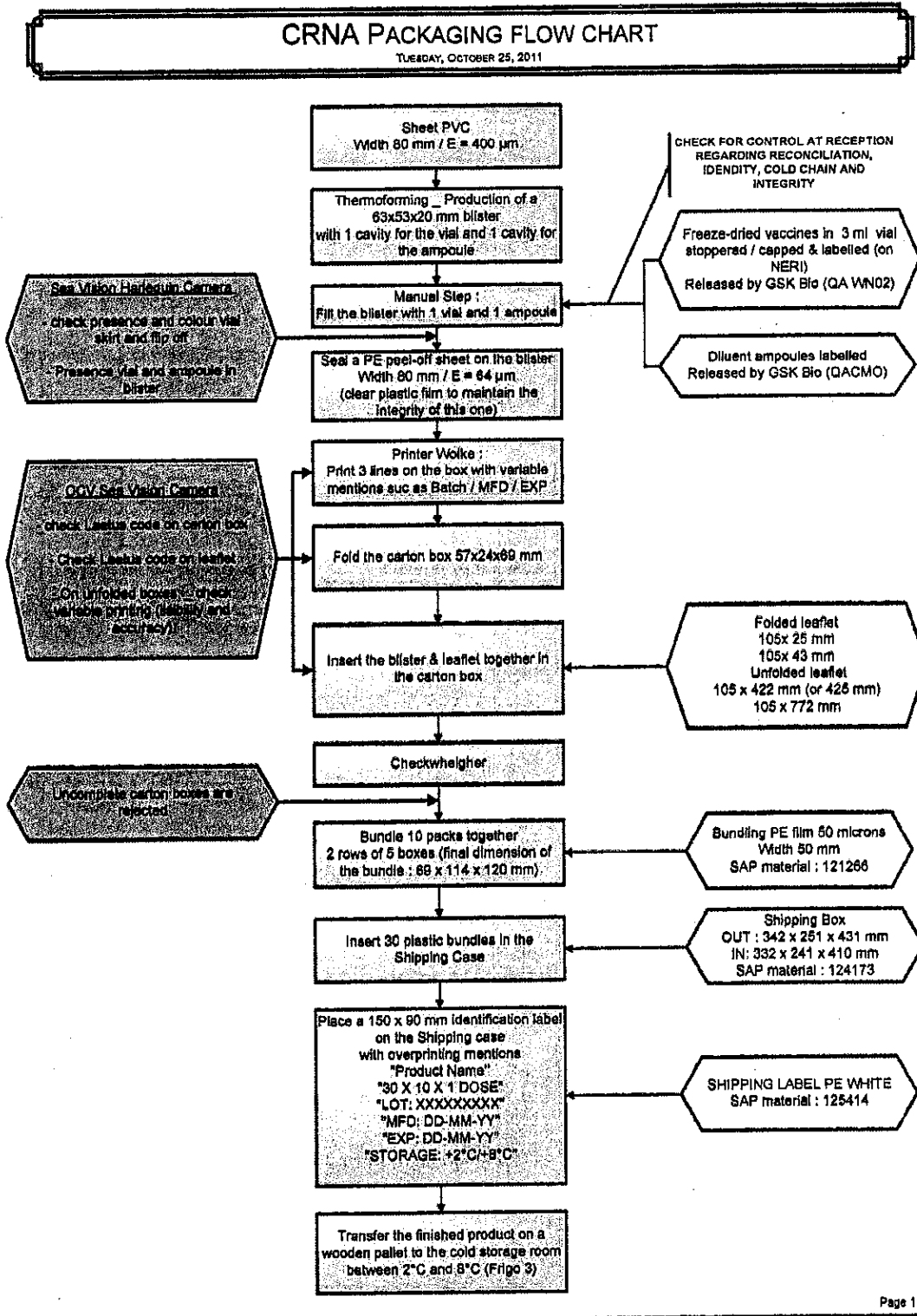



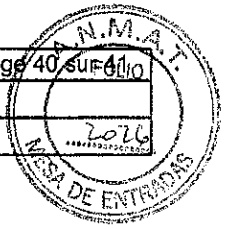

**ATTACHMENT
SCHEMATIC DRAWINGS OF WATER SYSTEMS**

Not applicable, water only used in CRNA 3 to clean packaging equipment parts

Accessed by: KOROGHLI Lydia

Access date: 09 juin 2016 10:51:35

CONFIDENTIAL
no reproduction or distribution without written approval

Document ID: RA_1354789

Document Version: 1.0

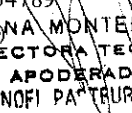
OXANA MONTEMILONE
 DIRECTORA TECNICA
 APODERADA
 SANOFI PASTEUR S. A



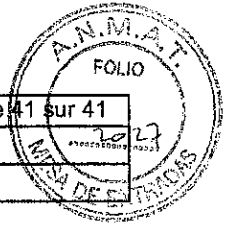

ATTACHMENT
LIST OF MAJOR PRODUCTION EQUIPMENT in CRNA 1 & 2

INSTALLATIONS
Cold Rooms
Cold room n°1 (+2°C / +8°C)
Cold room n°2 (+2°C / +8°C)
Cold room n°3 (+2°C / +8°C)
Cold room n°4 (+2°C / +8°C)
PACKAGING EQUIPMENTS
CRNA 2 Zone C
Thermoforming machine
Partena/ CAM type NMX/F
Camera
Camera SEAVISION type Harlequin
CRNA 2 Zone B
Cartoning machine
CAM type PMM
Camera
Camera SEAVISION type OCV
Printer
WOLKE M600
Checkweigher
GARVENS
Bundling machine
ASB38
Printer
ZEBRA 4000
CRNA 2 Zone B
Thermoforming machine
Multivac SN 1861
CRNA 2 Zone A
Thermoforming machine
Multivac SN 1307
Printer
Wolke Advanced

Accessed by: KOROGHLI Lydia

Access date: 09 juin 2016 10:51:35

CONFIDENTIAL

no reproduction or distribution without written approval

 Document ID: RA_1354788
 Document Version: 1.0

 ROXANA MONTEMILONE
 DIRECTORA TECNICA
 APODERADA
 SANOFI PASTEUR S.A.



ARCHIVO MAESTRO DE LA PLANTA

Sanofi Aventis Zrt.
Plataforma de Logística y Distribución de Budapest (BLDP)

Planta de acondicionamiento secundario

H-1225 Budapest, Campona utca 1

(HARBOR PARK)

Recopilado por: Lack Ferencné Dr. en Farm.
Farmacéutico, Garantía de Calidad

[Firma]

26 / feb / 2016

Aprobado por: Judit Filep
Responsable de Garantía de Calidad

[Firma]

26 / feb / 2016

ROXANA MONTEMILONE
DIRECTORA TÉCNICA
APODERADA
SANOFI PASTEUR S.A.



ÍNDICE

1.	INFORMACIÓN GENERAL	3
2.	PERSONAL	9
3.	INSTALACIONES Y EQUIPOS	13
4.	DOCUMENTACIÓN	14
5.	PRODUCCIÓN	16
6.	SISTEMA Y ACTIVIDADES DE GARANTÍA DE CALIDAD	19
7.	ELABORACIÓN Y ANÁLISIS CONTRATADOS	20
8.	DISTRIBUCIÓN	20
9.	RECLAMOS	20
10.	RETIRO DE PRODUCTOS DEL MERCADO	20

ADJUNTOS

- 1 Organigrama de la Plataforma de Logística y Distribución de Budapest
- 2 Ubicación y flujo de los materiales en el depósito de BLDP
- 3 Clasificación de las zonas de la planta de acondicionamiento secundario
- 4 Diagramas de flujo de personal y materiales en las instalaciones de acondicionamiento
- 5 Lista de los procedimientos operativos estándar y de las instrucciones de trabajo

ROXANA MONTEMILONE
DIRECTORA TÉCNICA
APODERADA
SANOFI PASTEUR S.A.

