

Appearance

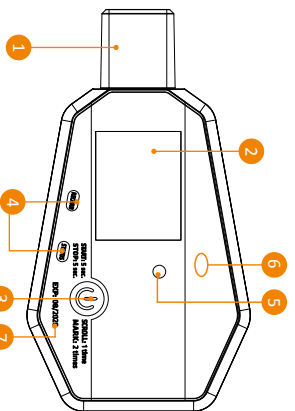

1. USB Protective Cover
2. LCD Screen
3. Button ⁽¹⁾
4. LED Indicator
5. Light Sensor
6. Humidity Sensor
7. Shelf life

Before you begin

EITtechLog Software download link: www.eittechlog.com/softwares
 Online configuration site link:

Technical Specifications

Recording Options	Single Use
Temperature Range	-30°C ~ 70°C, 0%RH ~ 100%RH ±0.5°C(-20°C ~ +40°C), others ±1.0°C
Temperature Accuracy	±0.3°C(-30°C ~ +70°C) - for LogEt 1Bio only ±3%RH(20%RH ~ 80%RH), others ±5%RH - for LogEt 1TH only under 25°C
Humidity Accuracy	
Resolution	0.1°C, 0.1%RH
Data Storage Capacity	Max. 16,000 points
Shelf Life / Battery	2 years (CR2450 button cell) ⁽⁸⁾
Recording Interval	12 minutes (Default, others on request)
Recording Duration	Up to 120 days (Default, others on request) ⁽⁹⁾
Start Mode	Button or software
Stop Mode	Button, software or stop when full
Protection Class	IP67 (Not for LogEt 1TH)
Reprogrammable	Via EITtech software Via Online Configuration Web

Note:
 Button ⁽¹⁾ Function Instructions:

Operation	Function	Status Indication ⁽²⁾
Press & Hold 5 Seconds	Start/Stop Recording	Start Recording: ■ Stop Recording: ■ Stop ■ ■ ■ ■
Single Click	Light Up LCD Backlight: Page Up/Down	See Indication Instructions
Double Click	Mark Events	Mark Success: ■ ■ Mark Failure: ■ ■ ■ ■

⁽²⁾ The code like **Rec** will show on logger's LCD screen to indicates status. The red square ■ indicates the logger's red LED light is flashing; the green square ■ indicates the green LED light is flashing. Each individual square indicates how many times it will blink and two adjoining squares like indicates both red and green lights blink simultaneously. The same rules applied below.

Indication Instructions

1LCD Screen Indication

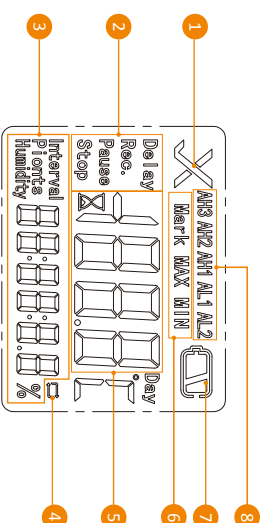

1. Alarm status ⁽⁶⁾
2. Working status
3. Humidity/Logging Interval/Recorded Points
4. Loop mark
5. Temperature display
6. Function indication
7. Battery indicator
8. Alarm threshold ⁽⁶⁾

Note:

⁽⁶⁾ Only displayed when Alarm is enabled.

⁽⁶⁾ Indicates current alarm status, e.g. if temperature goes above AHT setting, AHT code will appear on LCD screen.

2. Other LCD Page Indications:

Single click the Button can browse each LCD page.

1. Current Temperature & Humidity		2. Recorded Points		3. Maximum Temperature & Humidity	
4. Minimum Temperature & Humidity		5. System Date - Month-Day		6. System Time - Hour:Minute	

3. Meaning of LED blinks
 Single click the Button make LED light blinks you may check logger status based on it.

LED blinks as...	Indicates status...
■ ■	Not Started
■ ■ ■	Delayed Start/Trailing Start
■	Started - OK
■	Started - Alarm
■ ■	Stopped - OK
■ ■	Stopped - Alarm

Operations

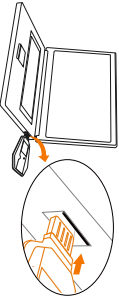

01 Connect the data logger to computer. Configure parameters and synchronize time via Elitechlog software. You can also use the online configuration site to generate configuration file and drag it to removable storage disk "Elitech Log" to finish configuration.

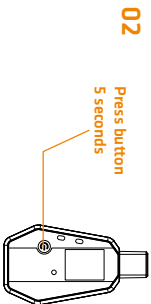

02 Press and hold the button for 5 seconds to start recording.

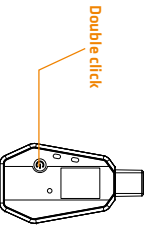

03 Double click the button quickly to mark the current time and temperature.

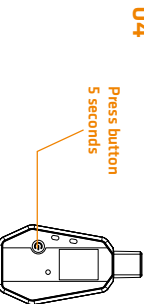

04 Press and hold the button for 5 seconds to stop recording.

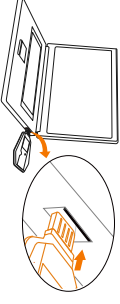

05 Connect the logger to computer. Open the PDF report in removable storage disk "Elitech Log" to view the data. You could also view data with ElitechLog software.

Important!

- ❗ Please read this User Manual carefully before you use data logger.
- ❗ The data logger is ideal to monitor and record temperature(humidity) during storage and transportations for pharmaceuticals and other products. It can be used widely in all parts of warehousing, logistics and cold chain.
- ❗ System time may not be synchronized via online configuration site.
- ❗ If Start Delay has set, logger will start recording after the delay time elapses.
- ❗ In the following scenarios, logger can start recording without manual button pressing:
 - If start mode set to Immediate Start, logger will start recording immediately after you remove it from the computer.
 - If start mode set to Timing Start, logger will start recording automatically on your scheduled date and time.
- ❗ You do NOT need to stop logger for data viewing. Just connect logger to computer and open the temporarily generated PDF report in "Elitech Log" disk to view the data.
- ❗ The logger will stop automatically when the recording points reach the settled point.
- ❗ Please store the data logger under room temperature.
- ❗ The humidity related parameter and description in the Manual is only for model LogEt-1TH.
- ❗ The logger can NOT be re-configured once you start it.
- ❗ The LCD screen will turn off automatically after 15 seconds of inactivity. Just single click the button can light on the screen.
- ❗ After logger is started, the green LED light will blink once every 10 seconds. If alarm(s) are triggered, the red LED light will blink once every 10 seconds (green LED will STOP blinks).
- ❗ LogEt 1 series should avoid contact with unstable chemical solvents or other organic compounds especially should avoid for long-term storage or exposed to environments that contain high concentrations of ketene, acetone, ethanol, isopropanol, toluene and etc.

LogEt 1/LogEt 1TH/LogEt 1Bio



CAUTION
TEMPERATURE MONITORING

Attach LogEt 1/LogEt 1TH/LogEt 1Bio
HERE

SHIPPER _____

CONTAINER NO. _____

TRUCK NO. _____

B/L NO. _____

REF NO. _____

CONTENTS _____

LOGGER SERIAL NO. _____

START DATE _____ DEPARTURE PORT _____

START TIME _____ ARRIVAL PORT _____

TEMPERATURE REQUIRED _____ °C □ °F